



# RUSSIAN NATIONAL CONGRESS OF CARDIOLOGY

INNOVATIVE TECHNOLOGIES  
IN THE HEALTHCARE PRACTICE

## SCIENTIFIC PROGRAMME

SEPTEMBER 25-28, 2018 | MOSCOW

[www.scardio.ru](http://www.scardio.ru)





## **DEAR CONGRESS PARTICIPANTS AND FRIENDS!**

On behalf of the Russian Ministry of Health and from myself personally I am delighted to welcome the participants of the Russian National Congress of Cardiology.

Diseases of the circulatory system remain the main cause of death of the working-age population of the Russian Federation. The necessity to discuss this topic comes both from the widespread prevalence and from high social significance of cardiovascular diseases, but also the level of tasks that we face.

The Russian Society of Cardiology has been working for many years to reduce cardiovascular mortality, is actively involved in the national health projects, making a significant contribution to the implementation of modern programs for continuing postgraduate education, conducting socially-oriented and preventive actions, introduction of new methods of diagnosis and treatment into clinical practice.

I am convinced that the wide platform of the Congress which traditionally unites doctors and researchers, teachers and clinicians in cardiology and related fields, will open new prospects for improving medical care based on innovative medical technologies, and will make the step forward to the development of the national healthcare.

I wish all participants of the Russian National Congress of Cardiology successful work, good health, peace and all the best!

Minister V.I. Skvortsova

A handwritten signature in blue ink, appearing to read 'Скворцова' (Skvortsova).



## DEAR CONGRESS PARTICIPANTS AND FRIENDS!

I am honoured and delighted to welcome participants of the Russian National Congress of Cardiology!

This largest scientific, practical and educational event aimed at the exchange of experience on the topical issues of prevention, diagnosis and treatment of cardiovascular diseases offers us new questions for discussion each year, it becomes more and more attractive for Russian and foreign colleagues.

The organizer of the congress- the Russian Society Cardiology- makes a great contribution to the interdisciplinary alliance of clinicians, scientists and teachers from all regions of the country; all together we solve the most important task of state importance — the reduction of cardiovascular mortality.

The problem is still acute, but we have achieved certain success: the reduction in cardiovascular mortality declined

about 20% over the past decade, and this positive trend is retaining. The most impressive results were obtained in the treatment of acute coronary syndrome; today its influence on the mortality is much lower than ten years ago. The availability of high-tech medical care has significantly increased in the country now, and we can be proud of the fact that much of this success is due to our work.

The Decree of the President of the Russian Federation V.V. Putin №204 dd 07/05/2018 set a new national goal of the country's development — to ensure the increase in life duration to 78 years (by 2030 — to 80 years) in Russia by 2024 and we will do our best for its successful achievement. This will require not only resources, but also innovative solutions, the transition to the principles of value-based and patient-oriented medicine, and focus on high-risk groups.

It is necessary to introduce a system of integrative medical care that will cover the whole cycle of the disease, from prevention and primary health care to an effective rehabilitation system. Moreover, the bridge between the rapid development of technology and the level of medical education should become the priority for us.

The Congress scientific program was prepared in these areas where the most modern achievements in cardiology and related fields are presented, and in this context the slogan of the Congress "New Technologies to the Healthcare Practice" is as relevant as possible.

I am firmly convinced that our Congress will once again become one of the most significant events in the life of the Russian medical community and will promote international acknowledgement of the Russian medical science! I wish you all success and the most fruitful work at the Congress!

President of the Russian Society of Cardiology  
Professor Evgeny Shlyakhto

**PROGRAMME COMMITTEE  
OF THE RUSSIAN NATIONAL CONGRESS OF CARDIOLOGY**

**Chairman of the Programme Committee** — President of the Russian Society of Cardiology, RAS Academician, Prof. **E.V. Shlyakhto** (St. Petersburg)

**Congress Executive Secretary** — Board Member of the Russian Society of Cardiology, Corresponding member of RAS, Prof. G.P. Arutyunov (Moscow)

**Co-chairmen of the Program Committee Working Groups:**

Akchurin R.S. (Moscow)	Lopatim Yu.M. (Volgograd)
Alekyan B.G. (Moscow)	Mareev V.Yu. (Moscow)
Baranova E.I. (Saint-Petersburg)	Matskeplishvili S.T. (Moscow)
Belenkov Y.N. (Moscow)	Nedogoda S.V. (Volgograd)
Boytsov S.A. (Moscow)	Oganov R.G. (Moscow)
Bokeria L.A. (Moscow)	Paleev F.N. (Moscow)
Vasyuk Y.A. (Moscow)	Popov S.V. (Tomsk)
Galagudza M.M. (St.Petersburg)	Revishvili A.S. (Moscow)
Golitsyn S.P. (Moscow)	Ruda M.J. (Moscow)
Golukhova E.Z. (Moscow)	Smolensky A.V. (Moscow)
Dzemeshevich S.L. (Moscow)	Sulimov V.A. (Moscow)
Zateischikov D.A. (Moscow)	Tereshchenko S.N. (Moscow)
Ezhov M.V. (Moscow)	Ternovoy S.K. (Moscow)
Karaskov A.M. (Novosibirsk)	Tkachuk V.A. (Moscow)
Karpov R.S. (Tomsk)	Chazova I.E. (Moscow)
Karpov Y.A. (Moscow)	Chumakova G.A. (Barnaul)
Kuznetsov V.A. (Tyumen)	Shalnova S.A. (Moscow)
Kuharchuk V.V. (Moscow)	Yavelov I.S. (Moscow)

**CONGRESS ABSTRACT COMMITTEE**

**Chairman: Prof. Dmitry Duplyakov** (Samara)

Abugov S.A. (Moscow)	Kostareva A.A. (Saint-Petersburg)
Barbarash O.L. (Kemerovo)	Lebedev D.S. (Saint-Petersburg)
Gapon L.I. (Tyumen)	Libis R.A. (Orenburg)
Gordeev M.L. (Saint-Petersburg)	Lishmanov Yu.B. (Tomsk)
Grinshtein Yu.I. (Krasnoyarsk)	Miller O.N. (Novosibirsk)
Demin A.A. (Novosibirsk)	Mitrofanova L.B. (Saint-Petersburg)
Zemtsovsky E.V. (Saint-Petersburg)	Moiseeva O.M. (Saint-Petersburg)
Kapustina A.V. (Moscow)	Nebieridze D.V. (Moscow)
Koziolova N.A. (Perm)	Podzolkov V.I. (Moscow)

Pokushalov E.A. (Novosibirsk)	Trufanov G.E. (Saint-Petersburg)
Puzyrev V.P. (Tomsk)	Tsaregorodtsev D.A. (Moscow)
Rotar O.P. (Saint-Petersburg)	Shlyk S.V. (Rostov-on-Don)
Ryzhkova D.V. (Saint-Petersburg)	Shumakov D.V. (Moscow)
Skibitsky V.V. (Krasnodar)	Yakovlev A.N. (Saint-Petersburg)
Tarlovskaya E.I. (Nizhny Novgorod)	Yakushin S.S. (Ryazan)
Ternovoy S.K. (Moscow)	

**RUSSIAN SOCIETY OF CARDIOLOGY AWARD 2018 COMMITTEE**

**Chairman: Prof. Evgeny Shlyakhto** (Saint-Petersburg)

Boytsov S.A. (Moscow), Galyavich A.S. (Kazan), Dovgalevsky P.Y. (Saratov), Duplyakov D.V. (Samara), Karpov R.S. (Tomsk), Koziolova N.A. (Perm), Konradi A.O. (Saint-Petersburg)

**YOUNG SCIENTISTS AWARD COMMITTEE**

Villevalde S.V. (Moscow), Grinshtein Yu.I. (Krasnoyarsk), Duplyakov D.V. (Samara), Kontsevaya A.V. (Moscow), Mayanskaya S.D. (Kazan), Melekhov A.V. (Moscow), Nikulina S.Yu. (Krasnoyarsk), Osipova I.V. (Barnaul), Sumin A.N. (Kemerovo), Khaisheva L.A. (Rostov-on-Don)

**BEST POSTER PRESENTATION JURY**

Barbarash O.L. (Kemerovo), Galagudza M. M. (Saint Petersburg), Gilyarov M.Yu. (Moscow), Golitsyn S.P. (Moscow), Gordeev M.L. (Saint Petersburg), Dergilev K.V. (Moscow), Duplyakov D.V. (Samara), Kapustina A.V. (Moscow), Kashtalap V.V. (Kemerovo), Kozlenok A.V. (Saint Petersburg), Kosmacheva E.D. (Krasnodar), Kostareva A.A. (Saint Petersburg), Kuznetsov V.A. (Tyumen), Libis R.A. (Orenburg), Miller O.N. (Novosibirsk), Nedoshivin A.O. (Saint Petersburg), Ryzhkov D.V. (Saint Petersburg), Serebryakova V.N. (Tomsk), Sinityn V.E. (Moscow), Sitnikova M.Yu. (Saint Petersburg), Tsaregorodtsev D.A. (Moscow), Chernova A.A. (Krasnoyarsk), Chesnikova A.I. (Rostov-on-Don), Shumakov D.V. (Moscow)

**SECRETARIAT OF THE CONGRESS PROGRAMME COMMITTEE**

Konradi A.O. (Saint Petersburg), Nedoshivin A.O. (Saint Petersburg), Ratova L.G. (Saint Petersburg), Tanicheva A.A. (Saint Petersburg), Chumak I.B. (Saint-Petersburg).

## GENERAL INFORMATION

The Organizing Committee invites you to take part in the Russian National Congress of Cardiology to be held in Moscow on 25-28 September 2018.

## CONGRESS VENUE

**World Trade Center**  
Moscow, 12 Krasnopresnenskaya emb.

## HOW TO GET THERE:

### By public transportation:

#### By metro:

The metro station “Ulitsa 1905 goda” (exit to the street Krasnaya Presnya).

Bus # 423 from the metro station “Ulitsa 1905 goda”.

The walk from the metro takes about 20 minutes (about 1 km): you should go down the street towards Krasnopresnenskaya embankment to the World Trade Center.

#### By car:

Entrances from the Krasnopresnenskaya embankment and Mantulinskaya street.

#### By hotel shuttles:

Check the bus schedule at the official partner of the Congress – MIR INTERNATIONAL company (olga@mirint.ru +7 (812) 7670831).

## REGISTRATION

On-line registration of the participants at the official website of the Russian Society of Cardiology [www.scardio.ru](http://www.scardio.ru) is possible up to September 16, 2017.

After September 16, – on-site registration only.

**Admittance to all sessions and the exhibition is free of charge, admittance by name badges that are issued to the registered participants only.**

### On-site Registration Timetable

24 September – 17.00–19.00 (pre-registration)

25 September – 07.30–17.00

26 September – 08.00–17.00

27 September – 08.00–18.00

28 September – 08.00–13.30

World Trade Centre, 4th entrance.

All registered at the RSC website [www.scardio.ru](http://www.scardio.ru) and all those who paid for the Congress materials can get a congress bag and a badge in the registration area.

## CONGRESS MATERIALS:

From September 1, 2018 – 2,500 rubles  
(for RSC members – 2,000 rubles).

One can pay for the Congress materials (congress bag, book of scientific programme, abstract book, exhibition catalogue, participant’s certificate) in the registration area on any day of the Congress.

Congress materials are free of charge for RSC Board members, all session chairs and Young Scientists Award winners.

All participants registered at [www.scardio.ru](http://www.scardio.ru) can receive a name badge in the registration area.

**ATTENTION!** All Congress sessions and the exhibition are free to attend after the registration procedure. Registration is required of all participants. Each participant will receive a name badge, which will serve as a pass to all sessions and the exhibition.

**The Russian National Congress of Cardiology 2018 is accredited in the system of CME by the Coordination Council for Development of Continuous Medical and Pharmaceutical Education of the Ministry of Health of the Russian Federation.**

In addition, the Conference “Cardiology 2018: innovative technologies in the healthcare practice” within the Russian National Congress of Cardiology has been granted 22 European CME credits (ECMEC@s) by the European Accreditation Council for Continuing Medical Education (EACCME®). Each medical specialist should claim only those hours of credit that he/she actually spent in the educational activity.

Through an agreement between the Union Européenne des Médecins Spécialistes and the American Medical Association, physicians may convert EACCME® credits to an equivalent number of AMA PRA Category 1 Credits™. Information on the process to convert EACCME® credit to AMA credit can be found at [www.ama-assn.org/go/internationalcme](http://www.ama-assn.org/go/internationalcme)

Live educational activities, occurring outside of Canada, recognized by the UEMS-EACCME® for ECMEC®s are deemed to be Accredited Group Learning Activities (Section 1) as defined by the Maintenance of Certification Program of the Royal College of Physicians and Surgeons of Canada.

**EACCME® credits**

Each participant can only receive the number of credits he/she is entitled to according to his/her actual participation at the event once he/she has completed the feedback form. Cf. criteria 9 and 23 of UEMS 2016.20.

**POSTERS**

- Posters are to be presented on September 25-27 in the exhibition area (1<sup>st</sup> floor) from 09.00 to 18.00, September 28 in the exhibition area (1<sup>st</sup> floor) from 09.00 to 15.00.
- Moderators of the poster sessions will be selecting the best posters every day during the lunch breaks on 25-28 September from 12.30 to 13.30.
- Poster presenters should place their posters in accordance with the number of presentations specified in the scientific program on the presentation day from 08:00 to 09:00.
- The posters must not exceed the following dimensions: 90 cm (width), 120 cm (height).
- The posters must be removed after 18:00 on 25-27 September, and after 15:00 on 28 September.

**CONGRESS SESSIONS TIMETABLE**

25 September: 09.00–16.30  
 26 September: 09.00–17.00  
 27 September: 09.00–19.00  
 28 September: 09.00–15.00

Lecture halls are located on 2<sup>nd</sup> floor of the Congress Centre and on the 2<sup>nd</sup> and 4<sup>th</sup> floors of the Office centre.

**Congress Center, 2<sup>nd</sup> floor**

Congress Hall  
 Amphitheater Hall  
 Press Room  
 Hall “Ural”  
 Hall “Baikal”

**2<sup>nd</sup> office building, 2<sup>nd</sup> floor**

Amur Hall  
 Hall “Yenisei”  
 Hall “Volga”  
 Dvina Hall  
 Hall “Angara”

**2<sup>nd</sup> office building, 4<sup>th</sup> floor**

Hall “Ladoga”

**OFFICIAL CONGRESS EVENTS**

- **25 September, 17.00–9.00**  
**Opening of the Congress and Awarding Ceremony:  
 Russian Society of Cardiology Awards and Young Scientists Awards**  
 Venue: Plenary Session Hall
- **26 September, 17.15–19.00**  
**XI General Assembly of the Russian Society of Cardiology**  
 Venue: Plenary Session Hall

**EXHIBITION**

Exhibition of medical, diagnostic and therapeutic equipment, modern information technology, and specialized medical publications will be presented daily on the 1<sup>st</sup> and 2<sup>nd</sup> floors of the Congress Centre.

Exhibition plan and participants’ information are indicated in the Exhibition Catalogue.

25 September — 08.00–16.30  
 26 September — 08.00–17.00  
 27 September — 08.00–19.00  
 28 September — 08.00–15.00

**INFORMATION FOR SPEAKERS**

**Presentation specifications:**

- file format .ppt or .pptx (MS Office 2003/2007/2010)
- Standard animation
- Multimedia files (audio and video) must be at the same folder with presentation file
- Acceptable formats for video files avi, mp4, wmv
- Maximum size for video file is 200 Mb, maximum video file resolution — 640x480 px. Higher resolution (full HD) is acceptable in accordance with advanced agreement.

## EQUIPMENT AND WORK WITH PRESENTATIONS:

- All lecture halls are equipped with laptops connected to the projector and/or widescreen panels.
- Using speakers' equipment is not allowed.
- All the laptops are equipped with a presenter (the device to switch slides) which can be replaced by a presenter of the lecturer after the consultation with technical personnel.
- Internet access (for broadcasting, video conferences, etc.) using the presentation equipment is possible only after the consultation the technical personnel.
- Presentations must be downloaded in advance, in any case no later than 15 minutes before the session starts. Presentations must be given to the technical personnel in the lecture hall.
- Speakers are strictly forbidden to work independently with the presentation equipment.

## SIMULTANEOUS TRANSLATION

The official language of the Congress is Russian.  
Simultaneous English/Russian translation will be provided during plenary sessions and symposia with participation of foreign speakers.  
**Please, do not use mobile phones during the Congress sessions!**

## PRESENTATIONS BY YOUNG SCIENTISTS AWARD WINNERS

will be held on September 25 in the Congress Hall "Ural" (2<sup>nd</sup> floor) from 09.00 to 10.30.

## INTERNET

Free Wi-Fi Internet is provided on the territory of the Congress Centre.  
Login: congress2018  
Password: congress2018

## ORGANIZING COMMITTEE ROOM

Organizing Committee Room is located on the 2<sup>nd</sup> floor of the Congress Centre (Conference room #2).

## SPEAKERS' ROOM

Speakers' room is located on the 2<sup>nd</sup> floor of the Congress centre near the Plenary Session Hall.

## SMOKING

The Russian Society of Cardiology actively promotes healthy lifestyle and considers smoking to be a serious risk factor of cardiovascular diseases. The Organizing Committee strongly recommends to all participants to refrain from smoking at the time of the Congress.



1<sup>ST</sup> FLOOR

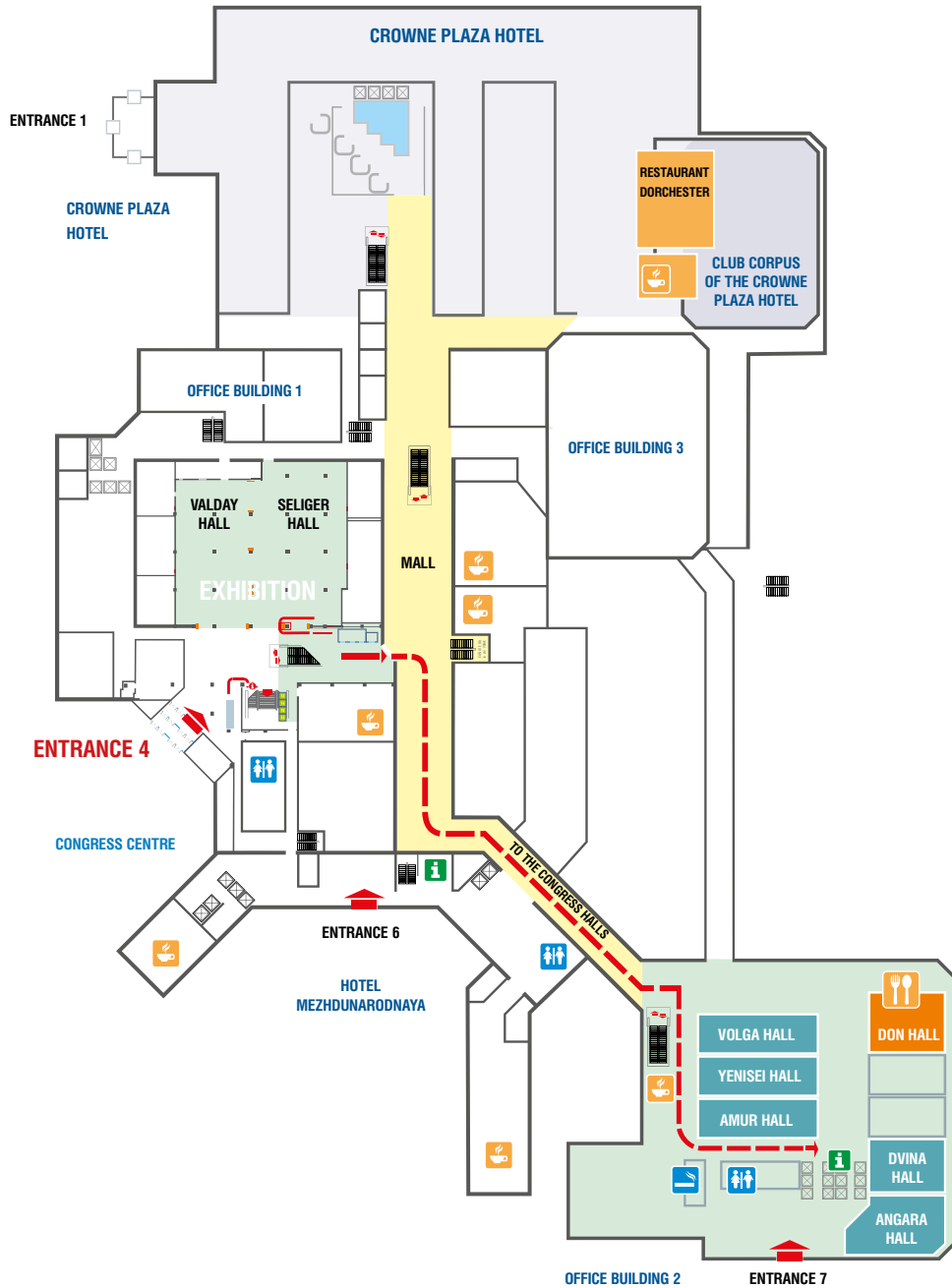

2<sup>ND</sup> FLOOR





World Trade Center Moscow, 2 floor					Office building №2, 2 floor					Office building №2, 4 floor
PLENARY HALL	AMPHITHEATER HALL	PRESS HALL	URAL HALL	BAIKAL HALL	AMUR HALL	YENISEI HALL	VOLGA HALL	DVINA HALL	ANGARA HALL	LADOGA HALL
<b>С 07.30 — РЕГИСТРАЦИЯ УЧАСТНИКОВ КОНГРЕССА (ЦЕНТРАЛЬНЫЙ ВХОД)</b>					<b>С 07.30 — РЕГИСТРАЦИЯ УЧАСТНИКОВ КОНГРЕССА (ЦЕНТРАЛЬНЫЙ ВХОД)</b>					
09.00–10.30	<p>Plenary Session Unsolved questions of arrhythmology</p> <p>On-line broadcasting / Simultaneous translation</p>	<p>Satellite symposium Beta-blockers in Modern Hypertension Treatment — whom, what for and why?</p> <p>(supported by Merck, CME points are not accrued)</p> <p>On-line broadcasting / Simultaneous translation</p>	<p>Satellite symposium How to improve the patient's quality of life in real cardiology practice?</p> <p>(supported by Berlin-Chemie/A.Menarini, CME points are not accrued)</p>	<p>Presentations by winners of Young Scientists Award</p>	<p>Scientific session Epidemiology, prevention and rehabilitation. Sports medicine</p>	<p>Symposium Diagnostics and treatment of diseases of an infectious etiology at polymorbid patients with cardiovascular diseases</p>	<p>Symposium A team approach in the management of patients before and after heart transplantation</p>	<p>Symposium Modern possibilities in assessment of prognosis and risk stratification in patients with cardiovascular diseases</p>	<p>Symposium Obstructive lesions of coronary arteries with stable ischemic heart disease: how is it better to identify and treat?</p>	<p>Symposium Telemedicine in cardiology</p> <p>Russian-Turkish Joint Symposium (with the Turkish Society of Cardiology) Difficult patient with CAD in questions and answers</p> <p>Simultaneous translation</p>
<b>10.30–11.00 BREAK</b>					<b>10.30–11.00 BREAK</b>					
11.00–12.30	<p>Satellite symposium New era of anticoagulation therapy</p> <p>(supported by Boehringer Ingelheim, CME points are not accrued)</p> <p>On-line broadcasting / Simultaneous translation</p>	<p>Satellite symposium Power of innovations today to preserve cardiovascular health in the future</p> <p>(supported by KRKA, CME points are not accrued)</p>	<p>Satellite symposium Acute coronary syndrome and myocardial infarction: the key questions of pre-hospital, hospital and long-term treatment</p> <p>(supported by Servier, CME points are not accrued)</p> <p>On-line broadcasting</p>	<p>Symposium Innovative approaches to managing patients with CVD: focus on the patient</p>	<p>Session of the Society of Specialists on Heart Failure</p>	<p>Satellite symposium CAD 2018: new perspectives in treatment and prevention</p> <p>(supported by AstraZeneca, CME points are not accrued)</p>	<p>Satellite symposium 2018: New Opportunities for Reducing Cardiovascular Risk in the Russian Federation</p> <p>(supported by Egis, CME points are not accrued)</p>	<p>Satellite symposium Modern therapy of hypertension — the role of calcium channel blockers</p> <p>(supported by Recordati, CME points are not accrued)</p>	<p>Symposium With all the richness of choice... The choice of different groups of drugs in terms of the prevention of stroke, dementia and influence on cognitive functions</p>	<p>Symposium Early vascular aging syndrome — causes, diagnostic, consequences</p> <p>Russian-Turkish Joint Symposium (with the Turkish Cardiovascular Academy Society) NOACs Challenging Patients: Countries share experiences through cases</p> <p>Simultaneous translation</p>
<b>12.30–13.00 BREAK</b>					<b>12.30–13.00 BREAK</b>					

	World Trade Center Moscow, 2 floor					Office building №2, 2 floor					Office building №2, 4 floor
	PLENARY HALL	AMPHITHEATER HALL	PRESS HALL	URAL HALL	BAIKAL HALL	AMUR HALL	YENISEI HALL	VOLGA HALL	DVINA HALL	ANGARA HALL	LADOGA HALL
13:00-14:30	<p>Plenary Session Cardiovascular surgery and cardiology at the cutting edge of the problem</p> <p>On-line broadcasting / Simultaneous translation</p>	<p>Satellite symposium Anticoagulant therapy of a comorbid patient with atrial fibrillation. How to reduce the risk of stroke and bleeding?</p> <p>(supported by Bayer, CME points are not accrued)</p> <p>On-line broadcasting</p>	<p>Satellite symposium Cardiac protection can be simple and available (supported by Servier, CME points are not accrued)</p> <p>On-line broadcasting</p>	<p>Symposium Nutrition and cardiovascular disease</p>	<p>Press conference (supported by Boehringer Ingelheim, CME points are not accrued)</p>	<p>Satellite symposium Aspirin in cardiology: PROs and CONS!</p> <p>(supported by Takeda, CME points are not accrued)</p>	<p>Satellite symposium Age is not a life sentence: the problems of gerontology in cardiology</p> <p>(supported by TEVA, CME points are not accrued)</p>	<p>Satellite symposium (supported by Abbott, CME points are not accrued)</p>	<p>Symposium New concepts of medicine</p>	<p>Master class Transplant cardiology for practicing physician: master class by the Shumakov National Medical Research Center of Transplantology and Artificial Organs</p>	<p>Joint session of the European Heart Rhythm Association and Russian Society of Cardiology Arrhythmias in heart failure patients — state-of-the art 2018</p> <p>Simultaneous translation</p>
14.30-15.00 BREAK						14.30-15.00 BREAK					
15:00-16:30	<p>Plenary Session Challenges and solutions in cardiology. Session 1</p> <p>On-line broadcasting / Simultaneous translation</p>	<p>Satellite symposium Personification and consistency in lipid lowering treatment — the basis for successful prevention of cardiovascular events</p> <p>(supported by Sanofi, CME points are not accrued)</p> <p>On-line broadcasting</p>	<p>Satellite symposium Treatment of hypertension: open expert discussion</p> <p>(supported by Takeda, CME points are not accrued)</p> <p>On-line broadcasting</p>	<p>Symposium Difficult patient with pulmonary hypertension</p>	<p>Debate The path to the truth is paved with paradoxes, or beyond guidelines</p>	<p>Satellite symposium Statins: myths and reality. Managing risks</p> <p>(supported by Sandoz, CME points are not accrued)</p>	<p>Symposium Multimorbid patient: tandem of cardiologist and physician</p>	<p>Satellite symposium Treatment and secondary prevention of VTE: making a clinical decision with evidence-based medicine</p> <p>(supported by Pfizer, CME points are not accrued)</p>	<p>Symposium Quality control of medical care in cardiology</p>	<p>Symposium Heart failure in older adults: experts opinion</p>	<p>Satellite symposium School of practicing doctor. Special approach to special patient with AF</p> <p>(supported by Boehringer Ingelheim, CME points are not accrued)</p>
16.30-17.00 BREAK						16.30-17.00 BREAK					
17:00-18:30	<p>OPENING CEREMONY   PLENARY HALL WELCOME GREETINGS</p> <p>OPENING LECTURE SHLYAKHTO E.V. (SAINT-PETERSBURG). NEW TECHNOLOGIES AS A WAY TO INCREASE THE LENGTH OF LIFE IN RUSSIA.</p> <p>AWARDING CEREMONY: YOUNG SCIENTISTS AWARDS RSC PRIZE 2018</p> <p>On-line broadcasting / Simultaneous translation</p>					<p>OPENING CEREMONY   PLENARY HALL WELCOME GREETINGS</p> <p>OPENING LECTURE SHLYAKHTO E.V. (SAINT-PETERSBURG). NEW TECHNOLOGIES AS A WAY TO INCREASE THE LENGTH OF LIFE IN RUSSIA.</p> <p>AWARDING CEREMONY: YOUNG SCIENTISTS AWARDS RSC PRIZE 2018</p> <p>On-line broadcasting / Simultaneous translation</p>					
18.30 COCKTAIL RECEPTION						18.30 COCKTAIL RECEPTION					

## PLENARY HALL

09.00–10.30

### PLENARY SESSION

#### Unsolved questions of arrhythmology

*On-line broadcasting / Simultaneous translation*

**Chairpersons:** **Revishvili A.Sh.** (Moscow), **Popov S.V.** (Tomsk), **Golitsyn S.P.** (Moscow), **Kautzner J.** (Czech Republic), **Atar D.** (Norway)

- **Atar D.** (Norway). Modern Treatment of Atrial Fibrillation: What is the Status in 2018?
- **Lebedev D.** (Saint-Petersburg). Prospects and new horizons of interventional arrhythmology.
- **Kautzner J.** (Czech Republic). Ventricular tachycardia. A wide spectre of clinical conditions.
- **Kurnis A.** (Italy). Electrodeless pacemakers. To whom and when?
- **Batalov R.E.** (Tomsk). Atrial fibrillation. A rough path from basic pathophysiology to catheter ablation.

## AMPHITHEATER HALL

09.00–10.30

### SATELLITE SYMPOSIUM

#### Beta-blockers in Modern Hypertension Treatment — whom, what for and why?

(supported by Merck, CME points are not accrued)

*On-line broadcasting / Simultaneous translation*

**Chairpersons:** **Shlyakhto E.V.** (Saint-Petersburg), **Mancia G.** (Italy)

- **Mancia G.** (Italy). Current Position of Beta-blockers among Antihypertensive Therapy. European Guidelines 2018.
- **Shlyakhto E.V.** (Saint-Petersburg). Sympathetic Overdrive in Hypertension Pathogenesis. How to treat?
- **Nedogoda S.V.** (Volgograd). How to Break the Vicious Circle of Sympathetic Overdrive and Insulin Resistance among Hypertensive Patients?

## PRESS HALL

09.00–10.30

### SATELLITE SYMPOSIUM

#### How to improve the patient's quality of life in real cardiology practice?

(supported by Berlin-Chemie/A.Menarini, CME points are not accrued)

**Chairpersons:** **Vasyuk Y.A.** (Moscow), **Orlova Ya.A.** (Moscow), **Kalinkin A.L.** (Moscow)

- **Kalinkin A.L.** (Moscow). Sight of the somnologist: quality of sleep of the patient with CVD.
- **Orlova Ya.A.** (Moscow). Quality of life is the basis of adherence to treatment.
- **Vasyuk Y.A.** (Moscow). How to improve the quality of life of a patient with CVD?

## URAL HALL

09.00–10.30

### PRESENTATIONS BY WINNERS OF YOUNG SCIENTISTS AWARD

**Jury:**

**Villevalde S.V.** (Moscow), **Grinshtein Yu.I.** (Krasnoyarsk), **Kontsevaya A.V.** (Moscow), **Mayanskaya S.D.** (Kazan), **Melekhov A.V.** (Moscow), **Nikulina S.Yu.** (Krasnoyarsk), **Osipova I.V.** (Barnaul), **Sumin A.N.** (Kemerovo), **Khaisheva L.A.** (Rostov-on-Don)

- **Gonboeva S.B.** (Tomsk). An acute coronary syndrome patient with non-obstructive CAD.
- **Mezhonov E.M.** (Tyumen). Contrast-induced acute kidney injury in STEMI patients after PCI.
- **Galenko V.L.** (Saint-Petersburg). Types and predictors of response on physical activity in patients with HFpEF.
- **Mazdorova E.V.** (Novosibirsk). Associations of hypertension and BP levels with genetic markers selected on results of genome wide studies.

- **Shapkina M.Yu.** (Novosibirsk). Analysis of predictors of 13-year risk of atrial fibrillation development in the Russian population.
- **Shomakhov R.A.** (Nalchik). Left ventricular myocardial fibrosis defined by cardiac contrast MRI as a marker of adverse events in patients with non-coronary ventricular arrhythmias.
- **Mustafina I.A.** (Ufa). OCT and pentraxin 3 biomarker in STEMI diagnosis.

## BAIKAL HALL

09.00-10.30

### SCIENTIFIC SESSION

Epidemiology, prevention and rehabilitation.

Sports medicine

Chairpersons: **Shalnova S.A.** (Moscow), **Gafarov V.V.** (Novosibirsk)

- **Zairova A.R.<sup>1</sup>, Rogoza A.N.<sup>1</sup>, Oschepkova E.V.<sup>1</sup>, Dobrovolskiy A.B.<sup>1</sup>, Starostin I.V.<sup>1</sup>, Trubacheva I.A.<sup>2</sup>, Serebryakova V.N.<sup>2</sup>, Kaveshnikov V.S.<sup>2</sup>, Chazova I.E.<sup>1</sup>, Karpov R.S.<sup>2</sup>** (Moscow<sup>1</sup>, Tomsk<sup>2</sup>). Main risk factors of the early vascular aging in adult population of Russia based on ESSE-KП study in Tomsk.
- **Erina A.M., Boyarinova M.A., Moguchaya E.V., Alieva A.S., Soltsev V.N., Rotar O.P., Baranova E.I., Konradi A.O., Shlyakhto E.V.** (Saint-Petersburg). Prevalence of target organs damage in patients with pre-hypertension in random sample of Saint-Petersburg citizens.
- **Bokeria O.L., Kudzoeva Z.F., Khugaev S.G.** (Moscow). Walk with a doctor — health-promoting and educational initiative within the global programme aimed at the development of healthy lifestyle in population.
- **Inozemtseva A.A., Pomeshkina S.A., Argunova Yu.A., Barbarash O.L.** (Kemerovo). Assessment of efficiency of early rehabilitation in patients after CABG.
- **Lukianov M.M.<sup>1</sup>, Martsevich S.Yu.<sup>1</sup>, Okshina E.Yu.<sup>1</sup>, Yakushin S.S.<sup>2</sup>, Vorobiev A.N.<sup>2</sup>, Zagrebelniy A.V.<sup>1</sup>, Deev A.D.<sup>1</sup>, Kozminskiy A.N.<sup>2</sup>, Moseychuk K.A.<sup>2</sup>, Pereverzeva K.G.<sup>2</sup>, Pravkina E.A.<sup>2</sup>, Belova E.N.<sup>1</sup>, Vernokhaeva A.N.<sup>1</sup>, Kudryashov E.V.<sup>1</sup>, Drapkina O.M.<sup>1</sup>, Boytsov S.A.<sup>1</sup>** (Moscow<sup>1</sup>, Ryazan<sup>2</sup>). Stroke risk factors in patients with comorbid cardiovascular diseases: REKVAZA registry.
- **Shapkina M.Yu.<sup>1</sup>, Ryabikov A.N.<sup>1</sup>, Scherbakova L.V.<sup>1</sup>, Avdeeva E.M.<sup>1</sup>, Mazdorova E.V.<sup>1</sup>, Bobak M.<sup>2</sup>, Hubacek J.A.<sup>3</sup>, Malyutina S.K.<sup>1</sup>** (Novosibirsk<sup>1</sup>, United Kingdom<sup>2</sup>, Czech Republic<sup>3</sup>). Predictors of 13-year risk of atrial fibrillation development in the Russian population sample: HAPIEE cohort.

- **Muromtseva G.A.<sup>1</sup>, Vilkov V.G.<sup>1</sup>, Deev A.D.<sup>1</sup>, Konstantinov V.V.<sup>1</sup>, Shalnova S.A.<sup>1</sup>, Zhernakova Yu.V.<sup>1</sup>, Rotar O.P.<sup>2</sup>** (Moscow, Saint-Petersburg). Prevalence of QRS>110 ms on EKG depending on social and demographic characteristics (ESSE-RF study).
- **Gafarov V.V., Gromova E.A., Panov D.O., Gagulin I.V., Gafarova A.V.** (Novosibirsk). Impact of stress at work on risk of CVD development in population (MONICA-psychosocial of WHO).

## AMUR HALL

09.00-10.30

### SYMPOSIUM

Diagnostics and treatment of diseases of an infectious etiology at polymorbid patients with cardiovascular diseases

Chairpersons:

**Gendlin G.E.** (Moscow), **Kayukov I.G.** (Saint-Petersburg), **Esayan A.M.** (Saint-Petersburg), **Arutyunov G.P.** (Moscow)

- **Arutyunov A.G.** (Moscow). Diagnostics and treatment of pneumonia at patients with chronic heart failure.
- **Gendlin G.E.** (Moscow). Infectious endocarditis of artificial valves.
- **Kayukov I.G., Esayan A.M.** (Saint-Petersburg). Infections of urinary tract at patients with cardiovascular diseases.

## YENISEI HALL

09.00–10.30

### SYMPOSIUM

**A team approach in the management of patients before and after heart transplantation**

**Chairpersons:** **Shevchenko A.O.** (Moscow),  
**Kosmacheva E.D.** (Krasnodar), **Sitnikova M.Yu.** (Saint-Petersburg)

- **Fedotov P.A.** (Saint-Petersburg). Risk factors of waiting-list mortality for patients awaiting heart transplantation.
- **Bortsova M.A.** (Saint-Petersburg). Capabilities of physical rehabilitation in patients from HTx WL receiving inotropic support (UNOS1B).
- **Shevchenko A.O.** (Moscow). The choice of pathogenetically grounded antihypertensive therapy in heart transplanted patients.
- **Kosmacheva E.D.** (Krasnodar). Non-invasive monitoring of patients after heart transplantation for improvement of prevention and treatment of rejections.
- **Simonenko M.A.** (Saint-Petersburg). Outpatient follow-up of recipients after heart transplantation.

## VOLGA HALL

09.00–10.30

### SYMPOSIUM

**Modern possibilities in assessment of prognosis and risk stratification in patients with cardiovascular diseases**

**Chairpersons:** **Matskeplishvili S.T.** (Moscow), **Tereshina O.V.** (Samara)

- **Matskeplishvili S.T.** (Moscow). The role of multimodal visualization in risk stratification and prognosis in clinical practice.
- **Medvedeva E.A.** (Saint-Petersburg). Biomarkers as a tool for risk stratification and prognosis assessment.
- **Tereshina O.V.** (Samara). Global longitudinal strain-time for routine use?

## DVINA HALL

09.00–10.30

### SYMPOSIUM

**Obstructive lesions of coronary arteries with stable ischemic heart disease: how is it better to identify and treat?**

**Chairpersons:** **Sumin A.N.** (Kemerovo), **Duplyakov D.V.** (Samara),  
**Bershtein L.L.** (Saint-Petersburg)

- **Sumin A.N.** (Kemerovo). The place of clinical evaluation in the detection of obstructive lesions with stable ischemic heart disease.
- **Korok E.V.** (Kemerovo). The problem of intact coronary arteries — which noninvasive tests can solve it?
- **Duplyakov D.V.** (Samara). Personalized approach in the diagnosis of CAD.
- **Bershtein L.L., Zbyshevskaya E.V., Katamadze N.O., Kuzmina-Krutetskaya A.M., Gumerova V.E., Sayganov S.A.** (Saint-Petersburg). Symptoms, coronary anatomy or a high-risk stress test? How to change the indications for coronary revascularization after research ISCHEMIA и ORBITA.

## ANGARA HALL

09.00–10.30

### SYMPOSIUM

**Telemedicine in cardiology**

**Chairpersons:** **Oganov R.G.** (Moscow), **Mikhin M.P.** (Kursk)

- **Kurapeev D.I.** (Saint-Petersburg). Complex telemedicine programs in cardiology: past, present, future.
- **Vladimirskiy A.V.** (Moscow). The best practices of telecardiology.
- **Smirnova E.** (Saint-Petersburg). Legal aspects of telemedicine development in Russia.
- **Linnik A.V.** (Moscow). Personal monitoring of cardiac function with CardiRu device.

## LADOGA HALL

09.00–10.30

### RUSSIAN-TURKISH JOINT SYMPOSIUM

(with the Turkish Society of Cardiology)

#### Difficult patient with CAD in questions and answers

*Simultaneous translation*

**Chairpersons:** Nedoshivin A.O. (Saint-Petersburg), Kirma C. (Turkey)

- **Karabay C.Y.** (Turkey). Percutaneous LMCA intervention. Acute LMCA PCI (during TAVI, STEMI).
- **Barbarash O.L.** (Kemerovo). Patient before the planned myocardial revascularization. What to emphasize on?
- **Altintas B.** (Turkey). NOAC: how to manage difficult cases.
- **Borovkova N.Yu.** (Nizhny Novgorod). Microvascular and vasospastic angina in young and middle-aged patients: state-of-the-art.

## PLENARY HALL

11.00–12.30

### SATELLITE SYMPOSIUM

#### New era of anticoagulation therapy

(supported by Boehringer Ingelheim, CME points are not accrued)

*On-line broadcasting / Simultaneous translation*

**Chairpersons:** Shlyakhto E.V. (Saint-Petersburg),  
Baranova E.I. (Saint-Petersburg), Zamyatin M.N. (Moscow)

- **Baranova E.I.** (Saint-Petersburg). Anticoagulants in high risk patient: new data into clinical practice.
- **Zamyatin M.N.** (Moscow). Urgent situations in patients taking anticoagulants: problems and solutions.
- **Atar D.** (Norway). Specific antagonist to dabigatran: from molecule to clinical studies.
- **Kobalava Zh.D.** (Moscow). HCP-patient dialogue as a factor of successful anticoagulation therapy.
- **Shlyakhto E.V.** (Saint-Petersburg). On the threshold of a new era of anticoagulation therapy.
- **Discussion.**

## AMPHITHEATER HALL

11.00–12.30

### SATELLITE SYMPOSIUM

#### Power of innovations today to preserve cardiovascular health in the future

(supported by KRKA, CME points are not accrued)

**Chairperson:** Shlyakhto E.V. (Saint-Petersburg)

- **Shlyakhto E.V.** (Saint-Petersburg). Therapy of CVD: from the past to the future.
- **Kobalava Zh.D.** (Moscow). The future is already here: new horizons for patients with hypertension.
- **Kislyak O.A.** (Moscow). Power of BP control: reliable foundation for tomorrow.
- **Susekov A.V.** (Moscow). Advanced statinotherapy to correct vascular age.
- **Mareev V.Yu.** (Moscow). Novel approaches to preserve cardiovascular health.

## PRESS HALL

11.00–12.30

### SATELLITE SYMPOSIUM

#### Acute coronary syndrome and myocardial infarction: the key questions of pre-hospital, hospital and long-term treatment

(supported by Servier, CME points are not accrued)

*On-line broadcasting*

**Chairperson:** Ruda M.Ya. (Moscow)

- **Averkov O.V.** (Moscow). Pre-hospital ACS treatment.
- **Yavelov I.S.** (Moscow). Early ACS treatment in hospital and long-term treatment with antithrombotic therapy.
- **Zhirov I.V.** (Moscow). Fix dose combination in post-MI patients' treatment.



## URAL HALL

11.00–12.30

### SYMPOSIUM

**Innovative approaches to managing patients with CVD:  
focus on the patient**

**Chairpersons:** **Drapkina O.M.** (Moscow), **Kontsevaya A.V.** (Moscow)

- **Drapkina O.M.** (Moscow). The concept of responsible self-treatment of patients with cardiovascular disease.
- **Duplyakov D.V.** (Samara). Atrial fibrillation is a new reality. Regional project in Samara region.
- **Kirilenko N.P.** (Тверь). Internet technologies in prevention of cardiovascular diseases in Tver region.
- **Kontsevaya A.V.** (Moscow). Information technologies in cardiovascular risk reduction: adaptation of Japanese approach.

## BAIKAL HALL

11.00–12.30

**SESSION OF THE SOCIETY OF SPECIALISTS  
ON HEART FAILURE**

## AMUR HALL

11.00–12.30

### SATELLITE SYMPOSIUM

**CAD 2018: new perspectives in treatment and prevention**

(supported by AstraZeneca, CME points are not accrued)

**Chairpersons:** **Ruda M.Ya.** (Moscow), **Barbarash O.L.** (Kemerovo)

- **Averkov O.V.** (Moscow). TREAT study results and implication.
- **Galstyan G.R.** (Moscow). CV risks in patients with T2D: new treatment approaches to lower the risks.
- **Barbarash O.L.** (Kemerovo). Patient with comorbidities: myocardial infarction and diabetes mellitus.

## YENISEI HALL

11.00–12.30

### SATELLITE SYMPOSIUM

**2018: New Opportunities for Reducing Cardiovascular  
Risk in the Russian Federation**

(supported by Egis, CME points are not accrued)

**Chairperson:** **Ezhov M.V.** (Moscow)

- **Ezhov M.V.** (Moscow). Modern analysis of high cardiovascular mortality in the Russian Federation.
- **Obrezan A.G.** (Saint-Petersburg). Multi-vector organprotection in atherosclerosis.
- **Akhmedzhanov N.M.** (Moscow). Drug therapy of CAD. Problems and new opportunities.

## VOLGA HALL

11.00–12.30

### SATELLITE SYMPOSIUM

**Modern therapy of hypertension — the role of calcium  
channel blockers**

(supported by Recordati, CME points are not accrued)

**Chairperson:** **Karpov Yu.A.** (Moscow)

- **Karpov Yu.A.** (Moscow). Introduction.
- **Karpov Yu.A.** (Moscow). Current guidelines for treatment of hypertension: calcium channel blockers positions. What's the news?
- **Gilyarevskiy S.R.** (Moscow). Modern approach in treatment of hypertension: lercanidipine special role.
- **Bubnova M.G.** (Moscow). Hypertension and comorbid conditions in clinical practice.
- **Questions, discussion.**



## DVINA HALL

11.00–12.30

### SYMPOSIUM

**With all the richness of choice... The choice of different groups of drugs in terms of the prevention of stroke, dementia and influence on cognitive functions**

**Chairpersons:**

**Konradi A.O.** (Saint-Petersburg), **Ostroumova O.D.** (Moscow)

- **Konradi A.O.** (Saint-Petersburg). Stroke and dementia as a multidisciplinary problem.
- **Ostroumova O.D.** (Moscow). Antihypertensive drugs in the prevention of stroke and dementia. Who is in the lead?
- **Kislyak O.A.** (Moscow). Lipid-lowering drugs: effects on stroke risk, dementia and cognitive function.
- **Nedogoda S.V.** (Volgograd). A differentiated choice of hypoglycemic drugs in the context of influence on cardiovascular risks: “Yes” to reduce the risk of stroke.
- **Parfenov V.A.** (Moscow). Prevention of recurrent stroke and dementia in atrial fibrillation.

## ANGARA HALL

11.00–12.30

### SYMPOSIUM

**Early vascular aging syndrome – causes, diagnostic, consequences**

**Chairpersons: Rogoza A.N.** (Moscow), **Vasyuk Yu.A.** (Moscow), **Oleynikov V.E.** (Penza)

- **Rogoza A.N., Zairova A.R.** (Moscow). Syndrome of early vascular aging EVA or “increased stiffness of the vascular wall”. Pros and cons.
- **Ivanova S.V., Vasyuk Yu.A.** (Moscow). Arterial and left ventricular stiffness as an indicator of cardiovascular aging in patients with arterial hypertension and type 2 diabetes mellitus.
- **Orlova Ya.A.** (Moscow). Vascular aging in different periods of life.

- **Oleynikov V.E., Salyamova L.I., Khromova A.A.** (Penza). Early vascular aging syndrome in young patients with CHD.
- **Antropova O.N., Osipova I.V.** (Barnaul). Early vascular aging in young men with prehypertension.
- **Sadulaeva I.A., Vasyuk Yu.A.** (Moscow). Endothelial dysfunction as a marker of vascular aging.

## LADOGA HALL

11.00–12.30

### RUSSIAN-TURKISH JOINT SYMPOSIUM

**(with the Turkish Cardiovascular Academy Society)**

**NOACs Challenging Patients: Countries share experiences through cases**

*Simultaneous translation*

**Chairpersons: Kozan Ö.** (Turkey), **Boytsov S.A.** (Moscow), **Abdullaev A.A.** (Makhachkala)

- **Demir M.** (Turkey). Renally impaired patients.
- **Tkacheva O.N.** (Moscow). Elderly patient.
- **Okuyan E.** (Turkey). Patients with CV risk.
- **Yakushin S.S.<sup>1</sup>, Lukianov M.M.<sup>2</sup>, Martsevich S.Yu.<sup>2</sup>, Zagrebelniy A.V.<sup>2</sup>, Okshina E.Yu.<sup>2</sup>, Vorobiev A.N.<sup>1</sup>, Pereverzeva K.G.<sup>1</sup>, Boytsov S.A.<sup>2</sup>** (Ryazan<sup>1</sup>, Moscow<sup>2</sup>). Prescribed drug therapy and its impact on prognosis in out-patient stage in comorbid patients after stroke.

## PLENARY HALL

13.00–14.30

### PLENARY SESSION

**Cardiovascular surgery and cardiology at the cutting edge of the problem**

*On-line broadcasting / Simultaneous translation*

**Chairpersons:** **Bokeria L.A.** (Moscow), **Golukhova E.Z.** (Moscow), **Skopin I.I.** (Moscow)

- **Bokeria L.A.** (Moscow). Modern aspects of cardiovascular surgery in 2018.
- **Skopin I.I.** (Moscow). Ischemic mitral regurgitation.
- **Muratov R.M.** (Moscow). Biological prostheses: the current state of the problems.
- **Merzlyakov V.Yu.** (Moscow). In search of the least trauma — Minimally Invasive Bypass Surgery.
- **Aishibaya M.M.** (Moscow). Left ventricular aneurysm — 2000 operations.

## AMPHITHEATER HALL

13.00–14.30

### SATELLITE SYMPOSIUM

**Anticoagulant therapy of a comorbid patient with atrial fibrillation. How to reduce the risk of stroke and bleeding?**  
(supported by Bayer, CME points are not accrued)

*On-line broadcasting*

**Chairperson:** **Belenkov Yu.N.** (Moscow)

- **Mareev V.Yu.** (Moscow). Features of anticoagulant therapy of comorbid and elderly patients with atrial fibrillation.
- **Kobalava Zh.D.** (Moscow). Anticoagulant therapy in patients with atrial fibrillation and Heart Failure: risks not to be forgotten.
- **Koziolova N.A.** (Perm). Comorbid patients with AF in the practice of cardiologist. Case report of patient with AF, DM and CKD.

## PRESS HALL

13.00–14.30

### SATELLITE SYMPOSIUM

**Cardiac protection can be simple and available**  
(supported by Servier, CME points are not accrued)

*On-line broadcasting*

**Chairperson:** **Boytsov S.A.** (Moscow)

- **Boytsov S.A.** (Moscow). Actual issues of providing medical care to patients with cardiovascular diseases in Russian Federation.
- **Karpov Yu.A.** (Moscow). Treatment of patients with CVD according to the latest guidelines, new opportunities for achieving optimal results.
- **Kobalava Zh.D.** (Moscow). Features of antihypertensive therapy in patients with concomitant CVD.

## URAL HALL

13.00–14.30

### SYMPOSIUM

**Nutrition and cardiovascular disease**

**Chairpersons:** **Starodubova A.V.** (Moscow), **Pogosova N.V.** (Moscow), **Arutyunov G.P.** (Moscow)

- **Starodubova A.V.** (Moscow). The role of nutrition in the treatment and prevention of cardiovascular diseases: success and controversy.
- **Pogosova N.V.** (Moscow). Modern approaches to non-pharmacological treatment of hypertension.
- **Arutyunov G.P.** (Moscow). Treatment of deficiency of lean muscle mass in patients with chronic heart failure.
- **Pogozheva A.V.** (Moscow). The role of foods for particular nutritional uses in the nutrition of patients with cardiovascular diseases.

**BAIKAL HALL**

13.00–14.30

**PRESS CONFERENCE**

(supported by Boehringer Ingelheim, CME points are not accrued)

**AMUR HALL**

13.00–14.30

**SATELLITE SYMPOSIUM****Aspirin in cardiology: PROs and CONs!**

(supported by Takeda, CME points are not accrued)

Chairperson: Ageev F.T. (Moscow)

- **Zyryanov S.K.** (Moscow). The history of global delusion.
- **Belenkov Yu.N.** (Moscow). Fear of prescribing ASA, its causes and evidence-based medicine.
- **Ageev F.T.** (Moscow). Aspirin therapy in guidelines and in real practice.

**YENISEI HALL**

13.00–14.30

**SATELLITE SYMPOSIUM****Age is not a life sentence:  
the problems of gerontology in cardiology**

(supported by TEVA, CME points are not accrued)

Chairperson: Tkacheva O.N. (Moscow)

- **Tkacheva O.N.** (Moscow). Hypertension in older adults and the elderly: fascinating facts that are going to shake your mind.
- **Orlova Ya.A.** (Moscow). The main propositions of the consensus “Heart failure in older adults and the elderly”.
- **Karpov Yu.A.** (Moscow). Geroprotective effects of statins: from fundamental research to clinical practice.

- **Zyryanov S.K.** (Moscow). A rational prescription of cardiovascular medicines in older adults and the elderly: overcoming barriers.
- **Questions & Answers.**

**VOLGA HALL**

13.00–14.30

**SATELLITE SYMPOSIUM**

(supported by Abbott, CME points are not accrued)

*On-line broadcasting*

- **Nedogoda S.V.** (Volgograd). A range of antihypertension drugs classes and the tactics of choosing the therapy in patients with metabolic syndrome.
- **Baranova E.I.** (Saint-Petersburg). Dual synergistic classes of antihypertension drugs in achievement of the targeted BP level.
- **Sergienko I.V.** (Moscow). CAD, diabetes mellitus and hypertriglyceridemia. Fibrates and its place on Earth.

**DVINA HALL**

13.00–14.30

**SYMPOSIUM****New concepts of medicine**

Chairpersons:

Starodubov V.I. (Moscow), Shlyakhto E.V. (Saint-Petersburg)

- **Shlyakhto E.V.** (Saint-Petersburg). Value-based medicine in cardiology.
- **Sychev D.A.** (Moscow). Personalized medicine — the future paradigm.
- **Nedogoda S.V.** (Volgograd). The role of evidence-based medicine and pharmacoconomics healthcare management.

## ANGARA HALL

13.00–14.30

### MASTER CLASS

**Transplant cardiology for practicing physician: master class by the Shumakov National Medical Research Center of Transplantology and Artificial Organs**

**Chairpersons:** **Gotye S.V.** (Moscow), **Shevchenko A.O.** (Moscow)

- **Gotye S.V.** (Moscow). It's all about life: organ donation in Russia.
- **Poptsov V.N.** (Moscow). Management of Terminal Heart Failure Patients.
- **Koloskova N.N.** (Moscow). Practical issues of including and monitoring of cardiac patients in the waiting list.
- **Zakharevich V.M.** (Moscow). Cardiac re-transplantation in Russia: clinical practice.
- **Shevchenko A.O.** (Moscow). Cardiovascular diseases in heart transplant recipients.

## LADOGA HALL

13.00–14.30

**JOINT SESSION OF THE EUROPEAN HEART RHYTHM ASSOCIATION AND RUSSIAN SOCIETY OF CARDIOLOGY**  
**Arrhythmias in heart failure patients — state-of-the art 2018**

*Simultaneous translation*

**Chairpersons:** **Popov S.V.** (Tomsk), **de Potter T.** (Belgium), **Kautzner J.** (Czech Republic)

- **Chudzik M.** (Poland). Diagnosis and pharmacological therapy in HF patients with atrial fibrillation in 2018.
- **Romanov A.** (Novosibirsk). Stroke prevention in AF patients — when LAA closure should be consider.
- **de Potter T.** (Belgium). Catheter ablation — whether and in which patients should be the first approach in AF patients with heart failure?
- **Duplyakov D.V.** (Samara). Antiarrhythmic treatment of ventricular arrhythmias in HF patients.
- **Kautzner J.** (Czech Republic). Catheter ablation of PVC and VT, VF — when its prolong life in heart failure patients?

## PLENARY HALL

15.00–16.30

### PLENARY SESSION

**Challenges and solutions in cardiology. Session 1**

*On-line broadcasting / Simultaneous translation*

**Chairpersons:** **Shlyakhto E.V.** (Saint-Petersburg), **Bax J.J.** (Netherlands)

- **Bax J.J.** (Netherlands). Multimodal imaging in cardiology: today and tomorrow.
- **Walsh M.** (USA). Global issues affecting women in cardiology.
- **Katus H.** (Germany). Cardiac troponins: Chances and challenges.
- **Ferrari R.** (Italy). Which will be the future of cardiology and cardiovascular research?

## AMPHITHEATER HALL

15.00–16.30

### SATELLITE SYMPOSIUM

**Personification and consistency in lipid lowering treatment — the basis for successful prevention of cardiovascular events**

(supported by Sanofi, CME points are not accrued)

*On-line broadcasting*

**Chairperson:** **Karpov Yu.A.** (Moscow)

- **Susekov A.V. (Moscow).** Statins. The cornerstone of cardiovascular prevention.
- **Karpov Yu.A. (Moscow).** PCSK9 inhibitors in patients with recent ACS — the new evidence of LDL-C lowering as the key factor of outcomes improvement.
- **Duplyakov D.V. (Samara).** How to translate the results of PCSK9 inhibitors trials into real clinical practice?

## PRESS HALL

15.00–16.30

### SATELLITE SYMPOSIUM

**Treatment of hypertension: open expert discussion**  
(supported by Takeda, CME points are not accrued)

*On-line broadcasting*

**Chairperson: Kobalava Zh.D.** (Moscow)

- **Nedogoda S.V. (Volgograd).** Is there a place for monotherapy according to the latest guidelines.
- **Kobalava Zh.D. (Moscow).** Current guidelines: consistent and mismatched positions.
- **Karpov Yu.A. (Moscow).** Target blood pressure goals: what a clinician should know.

## URAL HALL

15.00–16.30

### SYMPOSIUM

**Difficult patient with pulmonary hypertension**

**Chairpersons:**

**Moiseeva O.M.** (Saint-Petersburg), **Martynyuk T.V.** (Moscow)

- **Moiseeva O.M.** (Saint-Petersburg). New pulmonary hypertension diagnostic approach as a key success factor to effective therapy.
- **Martynyuk T.V.** (Moscow). PAH-specific treatment optimization. Possible scenario of PAH treatment strategy.
- **Discussion.**

## BAIKAL HALL

15.00–16.30

### DEBATE

**The path to the truth is paved with paradoxes, or beyond guidelines**

**Chairpersons: Boytsov S.V.** (Moscow), **Shalnova S.A.** (Moscow)

- Low cholesterol increases mortality.  
**Akhmedzhanov N.M.** (Moscow). “Pro”.  
**Ezhov M.V.** (Moscow). “Contra”.
- Alcoholic beverage. Is there a protective effect and can it be used in clinical practice?  
**Arutyunov G.P.** (Moscow). Rather “Yes”.  
**Perepech N.B.** (Saint-Petersburg). Rather “No”.

## AMUR HALL

15.00–16.30

### SATELLITE SYMPOSIUM

**Statins: myths and reality. Managing risks**  
(supported by Sandoz, CME points are not accrued)

**Chairperson: Shevchenko A.O.** (Moscow)

- **Karpov Yu.A.** (Moscow). Dislipidemia and atherosclerosis: from clinical guidelines to real clinical practice.
- **Akhmedzhanov N.M.** (Moscow). Statin therapy safety: a balance of risk and benefit.
- **Shevchenko A.O.** (Moscow). A problem of adherence to statin therapy. How to dispel patient’s doubts?
- **Discussion.**



## YENISEI HALL

15.00–16.30

### SYMPOSIUM

#### Multimorbid patient: tandem of cardiologist and physician

**Chairpersons:** **Drapkina O.M.** (Moscow),  
**Samorodskaya I.V.** (Moscow), **Barbarash O.L.** (Kemerovo)

- **Drapkina O.M.** (Moscow). Multimorbid patient: tandem of cardiologist and physician.
- **Samorodskaya I.V., Larina V.N.** (Moscow). Personal approach in treatment of patients with CVD and multimorbidity.
- **Barbarash O.L.** (Kemerovo). A comorbid patient in a cardiosurgical clinic. How to assess and reduce perioperative risk?
- **Lukianov M.M.** (Moscow). Patient with multiple cardiovascular diseases in the practice of a cardiologist and physician: medication and outcomes.
- **Efros L.A.** (Chelyabinsk). The role and responsibility of the members of a multidisciplinary team in providing care to patients with ACS.

## VOLGA HALL

15.00–16.30

### SATELLITE SYMPOSIUM

#### Treatment and secondary prevention of VTE: making a clinical decision with evidence-based medicine

(supported by Pfizer, CME points are not accrued)

**Chairperson:** **Averkov O.V.** (Moscow)

- **Averkov O.V.** (Moscow). Introduction.
- **Averkov O.V.** (Moscow). Acute PATE in the light of the current guidelines.
- **Andreev D.A.** (Moscow). How to implement the guidelines in practice. Clinical case of a patient with acute PATE.
- **Yavelov I.S.** (Moscow). The further, the more frightening? Prolonged prevention of VTE.
- **Vereina N.K.** (Chelyabinsk). How to observe the principle of common sense in the treatment of a polymorbid patient with VTE. Clinical case.
- **Discussion.**

## DVINA HALL

15.00–16.30

### SYMPOSIUM

#### Quality control of medical care in cardiology

**Chairpersons:** **Naigovzina N.B.** (Moscow), **Roshal L.M.** (Moscow),  
**Shlyakhto E.V.** (Saint-Petersburg)

- **Zimina E.V.** (Moscow). Quality control of medical treatment in the modern healthcare.
- **Konradi A.O.** (Saint-Petersburg). Quality assessment methods — how to get from the process to the results.
- **Tsvetkova E.A., Titkova Yu.S.** (Moscow). Features of training of quality control specialists in medical university.
- **Kurapeev D.I.** (Saint-Petersburg). Information technologies and quality of medical care.

## ANGARA HALL

15.00–16.30

### SYMPOSIUM

#### Heart failure in older adults: experts opinion

**Chairpersons:** **Tkacheva O.N.** (Moscow), **Orlova Ya.A.** (Moscow)

- **Frolova E.V.** (Saint-Petersburg). Difficulties in HF diagnosis.
- **Tkacheva O.N.** (Moscow). Frailty and heart failure.
- **Kotovskaya Yu.V.** (Moscow). Difficulties in treatment.
- **Orlova Ya.A.** (Moscow). Difficulties in rehabilitation.

## LADOGA HALL

15.00–16.30

### SATELLITE SYMPOSIUM

#### School of practicing doctor. Special approach to special patient with AF

(supported by Boehringer Ingelheim, CME points are not accrued)

##### Chairpersons:

**Mareev V.Yu.** (Moscow), **Yanishevskiy S.N.** (Saint-Petersburg)

- **Mareev V.Yu.** (Moscow). AF and concomitant diseases: opportunities of dabigatran.
- **Gilyarevskiy S.R.** (Moscow). Re-DUAL PCI: management of patient with AF and ACS.
- **Yanishevskiy S.N.** (Saint-Petersburg), **Zotova I.V.** (Moscow). Life path of a patient with AF: dialogue of cardiologist and neurologist.
- **Discussion.**

## PLENARY HALL

17.00–18.30

### PLENARY SESSION

#### OPENING CEREMONY

*On-line broadcasting / Simultaneous translation*

- **Welcome greetings**
- **Opening lecture**  
**Shlyakhto E.V.** (Saint-Petersburg). New technologies as a way to increase the length of life in Russia.
- **Awarding Ceremony:**  
Young Scientists Awards  
RSC Prize 2018



World Trade Center Moscow, 2 floor						Office building №2, 2 floor					Office building №2, 4 floor	
PLENARY HALL	CONGRESS HALL #2	AMPHITHEATER HALL	PRESS HALL	URAL HALL	BAIKAL HALL	AMUR HALL	YENISEI HALL	VOLGA HALL	DVINA HALL	ANGARA HALL	LADOGA HALL	
09.00-10.30	Plenary Session The sharp edges of hypertension  On-line broadcasting / Simultaneous translation	Satellite symposium Expanding horizons: a clinical study program  (supported by Pfizer, CME points are not accrued)	Satellite symposium A new era in lipid-lowering therapy for a comorbid patient  (supported by Recordati, CME points are not accrued)  Simultaneous translation	Satellite symposium Current trends in the individual approaches to patients receiving antiplatelet therapy in cardiology and neurology  (supported by Dr. Reddy's Laboratories, CME points are not accrued)	Symposium Psychosocial risk factors of cardiovascular diseases: patient-centered approach	Symposium Dyspnea in comorbid patient — talking past each other?	Symposium The polymorbid patient with pathology of cardiovascular and endocrine systems	Satellite symposium Change of landmarks in CAD and atherosclerosis radiodiagnosis  (supported by GE Healthcare, CME points are not accrued)	Symposium Modern view on clinical and geographical aspects of cardiovascular diseases	Symposium Rhythm disorders in patients with congenital heart disease	Symposium Atrial fibrillation — new challenges and our readiness for the answer	Satellite symposium 10 years of rivaroxaban in the world. For the welfare of health and lives.  (supported by Bayer, CME points are not accrued)  Simultaneous translation
	<b>10.30-11.00 BREAK</b>						<b>10.30-11.00 BREAK</b>					
11.00-12.30	Satellite symposium Hypertension therapy 2018: at the crossroad of cardiovascular risks  (supported by Sanofi, CME points are not accrued)  On-line broadcasting / Simultaneous translation	Satellite symposium Cardio-Endo DUEL or Cardio-Endo DUET?  (supported by Boehringer Ingelheim, CME points are not accrued)	Satellite symposium Three sets for the victory over hypertension — complex approach in the treatment, what do the latest guidelines say  (supported by KRKA, CME points are not accrued)  On-line broadcasting	Satellite symposium The new concepts of angina management in the clinical practice  (supported by Servier, CME points are not accrued)  Simultaneous translation	Scientific session CAD, lipids and atherosclerosis	Symposium "CARDIOBESITY": obesity and cardiovascular diseases	Satellite symposium Qualitative emergency medical services in acute myocardial infarction is a question of life for patients (experience of Moscow)  (supported by AstraZeneca, CME points are not accrued)  On-line broadcasting	Satellite symposium Patients of high and very high risk: hot issues of primary and secondary prevention  (supported by Egis, CME points are not accrued)	Satellite symposium Anniversary of blockbusters in cardiology: the path of therapy of length from hypertension to chronic HF  (supported by Pfizer, CME points are not accrued)  On-line broadcasting	Symposium The current state of the problem of arterial hypertension: do we need new approaches to diagnosis and treatment?	Symposium Reperfusion therapy of acute myocardial infarction. Current state of the issue	Satellite symposium Workshop: Case report: A patient with atrial fibrillation and chronic kidney disease. How to treat and what to keep in mind?  (supported by Bayer, CME points are not accrued)
	12.40-13.20	<b>PLENARY LECTURE</b> <b>PINTO F. (PORTUGAL). BEYOND EJECTION FRACTION: WHAT NEW PARAMETERS CAN ECHO PROVIDE?</b> <b>MODERATOR: MATSKEPLISHVILI S.T. (MOSCOW)</b>  On-line broadcasting / Simultaneous translation					<b>PLENARY LECTURE</b> <b>PINTO F. (PORTUGAL). BEYOND EJECTION FRACTION: WHAT NEW PARAMETERS CAN ECHO PROVIDE?</b> <b>MODERATOR: MATSKEPLISHVILI S.T. (MOSCOW)</b>  On-line broadcasting / Simultaneous translation					
<b>12.30-13.30 BREAK</b>						<b>12.30-13.30 BREAK</b>						

	World Trade Center Moscow, 2 floor						Office building №2, 2 floor					Office building №2, 4 floor
	PLENARY HALL	CONGRESS HALL #2	AMPHITHEATER HALL	PRESS HALL	URAL HALL	BAIKAL HALL	AMUR HALL	YENISEI HALL	VOLGA HALL	DVINA HALL	ANGARA HALL	LADOGA HALL
13.30-15.00	<p>Plenary Session Epidemiology of cardiovascular diseases in Russia in the era of mortality reduction</p> <p>On-line broadcasting / Simultaneous translation</p>	<p>Satellite symposium Indirect anticoagulants in the era of new drugs</p> <p>(supported by Takeda, CME points are not accrued)</p>	<p>Satellite symposium Myocardial Infarction 2018</p> <p>(supported by Sanofi, CME points are not accrued)</p> <p>On-line broadcasting</p>	<p>Satellite symposium Choice 2018: The future of the patient with chronic heart failure — the decision is yours</p> <p>(supported by Novartis Pharma, CME points are not accrued)</p>	<p>Scientific session Clinical basis of interventional treatment of arrhythmias</p>	<p>Symposium Myocardial infarction: elements of clinical mosaic</p>	<p>Satellite symposium Statins in the kingdom of crooked mirrors</p> <p>(supported by AstraZeneca, CME points are not accrued)</p>	<p>Satellite symposium How to reach the goal? New possibilities in combined therapy of hypertension</p> <p>(supported by Berlin-Chemie/A.Menarini, CME points are not accrued)</p>	<p>Symposium Hot issues of perioperative medicine: assessment and correction of cardiac risk</p>	<p>Symposium Screening of patients with hypertension</p>	<p>Clinical discussion Wide complex arrhythmias in pregnant women: to observe. it is impossible. to treat</p>	<p>Satellite symposium How to prolong the life of patients with Coronary Artery Disease (CAD)? The revolution of treatment approaches</p> <p>(supported by Bayer, CME points are not accrued)</p> <p>On-line broadcasting / Simultaneous translation</p>
15.00-15.30 BREAK						15.00-15.30 BREAK						
15.30-17.00	<p>Plenary Session Cardiac radiology in coronary artery disease evaluation</p> <p>On-line broadcasting / Simultaneous translation</p>	<p>Satellite symposium Stroke prevention in atrial fibrillation: taking of clinical decision from evidence base medicine</p> <p>(supported by Pfizer, CME points are not accrued)</p>	<p>Satellite symposium How does your practice change after specific antagonist to anticoagulant appear</p> <p>(supported by Boehringer Ingelheim, CME points are not accrued)</p> <p>On-line broadcasting / Simultaneous translation</p>	<p>Satellite symposium Complexity of individual cardiovascular risk management: focus on patient's adherence</p> <p>(supported by Dr. Reddy's Laboratories, CME points are not accrued)</p> <p>On-line broadcasting</p>	<p>Symposium Traditions of the national higher school plus innovations of the XXI century</p>	<p>Symposium Features of management of patients with ACS in the Siberian region</p>	<p>Round table Problems of classification, coding and assessment of mortality from coronary artery disease in the Russian Federation</p>	<p>Training seminar Value of the nurse in implementation of clinical guidelines</p>	<p>Symposium Inflammatory heart diseases — 2018</p>	<p>Symposium Heart and psyche: uneasy questions at the outpatient visit, and how to solve it by clinician</p>	<p>Symposium Dispensarization of patients with stable CAD</p>	<p>Satellite symposium Strategy of treatment in PATE patient according to current ESC guidelines</p> <p>(supported by Bayer, CME points are not accrued)</p> <p>Simultaneous translation</p>
17.00-17.15 BREAK						17.00-17.15 BREAK						
17.15-18.30 XI GENERAL ASSEMBLY OF THE RUSSIAN SOCIETY OF CARDIOLOGY						17.15-18.30 XI GENERAL ASSEMBLY OF THE RUSSIAN SOCIETY OF CARDIOLOGY						

## PLENARY HALL

09.00–10.30

### PLENARY SESSION

#### The sharp edges of hypertension

*On-line broadcasting / Simultaneous translation*

**Chairpersons: Konradi A.O.** (Saint-Petersburg), **Libis R.A.** (Orenburg), **Grassos C.** (Greece)

- **Grassos C.** (Greece). The recent guidelines of the European Society for Arterial Hypertension in 2018.
- **Konradi A.O.** (Saint-Petersburg). New target BP level: pros and cons.
- **Kobalava Zh.D.** (Moscow). CKD is an underrated value.
- **Nedogoda S.V.** (Volgograd). Adipokines — a role in pathogenesis and the goal in the treatment of hypertension.

## CONGRESS HALL №2

09.00–10.30

### SATELLITE SYMPOSIUM

#### Expanding horizons: a clinical study program

(supported by Pfizer, CME points are not accrued)

**Chairperson: Averkov O.V.** (Moscow), **Golukhova E.Z.** (Moscow)

- **Averkov O.V.** (Moscow). Introduction.
- **Averkov O.V.** (Moscow). CAD and AF.
- **Panchenko E.P.** (Moscow). Venous thromboembolism, different aspects.
- **Vinogradov O.I.** (Moscow). The study of anticoagulant therapy in FPS positions of a neurologist.
- **Golukhova E.Z.** (Moscow). Anticoagulant therapy in cardioversion and ablation.
- **Discussion.**

## AMPHITHEATER HALL

09.00–10.30

### SATELLITE SYMPOSIUM

#### A new era in lipid-lowering therapy for a comorbid patient (supported by Recordati, CME points are not accrued)

*Simultaneous translation*

**Chairpersons: Catapano A.** (Italy), **Kukharchuk V.V.** (Moscow)

- **Kukharchuk V.V.** (Moscow). Introduction.
- **Catapano A.** (Italy). European guidelines on the lipid-lowering therapy. What's the news?
- **Bubnova M.G.** (Moscow). Statins: clinical effects, myths and real problems.
- **Sergienko I.V.** (Moscow). New target levels of LDL-cholesterol for primary and secondary prevention. How to reach the aim?
- **Ezhov M.V.** (Moscow). Pitavastatin: from a theory to the real clinical practice.
- **Questions, discussion.**

## PRESS HALL

09.00–10.30

### SATELLITE SYMPOSIUM

#### Current trends in the individual approaches to patients receiving antiplatelet therapy in cardiology and neurology (supported by Dr. Reddy's Laboratories, CME points are not accrued)

**Chairperson: Shyrokov E.A.** (Moscow)

- **Buryachkovskaya L.I.** (Moscow). Difficulties associated with the escalation and de-escalation of antiplatelet treatment in patients with ischemic heart disease.
- **Khripun A.V.** (Rostov-on-Don). The causes of late and very late thrombosis after X-ray surgery.
- **Shyrokov E.A.** (Moscow). The impact of recent achievements in coronary cardiology on the personalized treatment of the patients with ischemic stroke.
- **Lomakin N.V.** (Moscow). Treatment adherence in patients with ACS and opportunities for the individual therapeutic decision. Preliminary data from COBRA study.

## URAL HALL

09.00–10.30

### SYMPOSIUM

#### Psychosocial risk factors of cardiovascular diseases: patient-centered approach

**Chairpersons:** **Barbarash O.L.** (Kemerovo), **Yahontov D.A.** (Novosibirsk), **Garganeeva N.P.** (Tomsk)

- **Garganeeva N.P.** (Tomsk). Psychosocial risk factors as integral components of modern strategy of cardiovascular prevention in clinical practice.
- **Petrova M.M.** (Krasnoyarsk). Doctor-patient: issues of compliance or heightening the adherence to treatment in patients with chronic non-infectious diseases.
- **Chumakova G.A.** (Barnaul). Psychosocial aspects of patient-centered medicine.
- **Repin A.N., Lebedeva E.V.** (Tomsk). Depressive disorders and coronary artery disease: experience of multidisciplinary team with patients of a heart station.
- **Poponina T.M., Poponina Yu.S., Gunderina K.I.** (Tomsk). Is there any possibility to improve adherence to treatment in patients with anxiety-depressive disorders who have had myocardial infarction.
- **Akimova E.V.<sup>1</sup>, Gakova E.I.<sup>1</sup>, Gafarov V.V.<sup>2</sup>, Kuznetsov V.A.<sup>1</sup>** (Tyumen<sup>1</sup>, Novosibirsk<sup>2</sup>). Psychosocial component of cardiovascular health in the Siberian population sample from childhood to middle age — approaches to preventive population strategies.

- **Chernyak A.V.** (Moscow). Is functional diagnostics the answer to all questions?
- **Ratova L.G.** (Saint-Petersburg), **Khaisheva L.A.** (Rostov-on-Don). Diagnostic and treatment of dyspnea.

## AMUR HALL

09.00–10.30

### SYMPOSIUM

#### The polymorbid patient with pathology of cardiovascular and endocrine systems

**Chairpersons:** **Tarlovskaia E.I.** (Nizhny Novgorod), **Orlova Ya.A.** (Moscow), **Koziova N.A.** (Perm), **Arutyunov G.P.** (Moscow)

- **Tarlovskaia E.I.** (Nizhny Novgorod). Badly controlled arterial hypertension and giperaldosteronizm: how is it relevant for real clinical practice?
- **Orlova Ya.A.** (Moscow). Diabetic ardiopatiya: a modern view on a problem.
- **Koziova N.A.** (Perm). The choice of antihyperglycemic medicines at the polymorbid patient with diabetes.
- **Chesnikova A.I.** (Rostov-on-Don). Features of diagnosis of heart failure in comorbid patients with a thyrotoxicosis.
- **Arutyunov A.G.** (Moscow). Anemia in comorbid patients.

## BAIKAL HALL

09.00-10.30

### SYMPOSIUM

#### Dyspnea in comorbid patient — talking past each other?

**Chairpersons:** **Lopatin Yu.M.** (Volgograd), **Zykov K.A.** (Moscow), **Ratova L.G.** (Saint-Petersburg)

- **Lopatin Yu.M.** (Volgograd). Is heart failure the root of all evil?
- **Zykov K.A.** (Moscow). Is broncho-obstructive syndrome the major problem?

## YENISEI HALL

09.00–10.30

### SATELLITE SYMPOSIUM

#### Change of landmarks in CAD and atherosclerosis radiodiagnosis

(supported by GE Healthcare, CME points are not accrued)

##### Chairpersons:

**Shlyakhto E.V.** (Saint-Petersburg), **Sinitsyn V.E.** (Moscow)

- **Sinitsyn V.E.** (Moscow). Change of paradigms in CAD diagnostics as a result of joint efforts of cardiologists and radiology specialists.
- **Ryzhkova D.V.** (Saint-Petersburg). Hybrid imaging in cardiology as a key to solving the most important problems of diagnostics.
- **Kozlenok A.V.** (Saint-Petersburg). Stress echocardiography: break new grounds.
- **Discussion.**

## VOLGA HALL

09.00–10.30

### SYMPOSIUM

#### Modern view on clinical and geographical aspects of cardiovascular diseases

**Chairpersons: Voevoda M.I.** (Novosibirsk), **Kuznetsov V.A.** (Tyumen), **Gapon L.I.** (Tyumen)

- **Kuznetsov V.A., Bessonov I.S., Yaroslavskaya E.I., Zyrianov I.P., Samoylova E.P.** (Tyumen). Coronary atherosclerosis and percutaneous coronary interventions in the Tyumen region.
- **Nikitin Yu.P., Malyutina S.K., Gafarov V.V., Voevoda M.I.** (Novosibirsk). Epidemiological studies of cardiovascular diseases in Russian population in the context of international projects in Siberia.
- **Voevoda M.I., Maximov V.N.** (Novosibirsk). Population genetics in cardiovascular epidemiology by the data from international projects in Siberia.
- **Gapon L.I.<sup>1</sup>, Sereda T.V.<sup>1</sup>, Leontieva A.V.<sup>2</sup>** (Tyumen<sup>1</sup>, Salekhard<sup>2</sup>). Arterial hypertension in the natives and newcomers of the Tyumen North.
- **Shurkevich N.P., Vetoshkin A.S.** (Tyumen). Cardiovascular continuum in the shift workers of the Arctic region: climate or psychosocial stress?

## DVINA HALL

09.00–10.30

### SYMPOSIUM

#### Rhythm disorders in patients with congenital heart disease

**Chairpersons: Stovpyuk O.F.** (Saint-Petersburg),

**Garkina S.V.** (Saint-Petersburg), **Tatarskiy R.B.** (Saint-Petersburg)

- **Stovpyuk O.F.** (Saint-Petersburg). Pathophysiology of arrhythmias in congenital heart diseases.
- **Verbilo S.L.** (Saint-Petersburg). Electrocardiographic Diagnosis in the Evaluation of Arrhythmias in Patients with Pathology of the Right Chamber of the Heart.
- **Karev E.A.** (Saint-Petersburg). Echocardiography as a tool for assessing right ventricle function.
- **Ivanova K.S.** (Saint-Petersburg). Risk of sudden cardiac death in congenital heart disease.
- **Garkina S.V.** (Saint-Petersburg). Drug therapy in patients with CHD and cardiac arrhythmias.
- **Tatarskiy R.B.** (Saint-Petersburg). Catheter treatment of incisional tachycardias in patients with congenital heart disease.

## ANGARA HALL

09.00–10.30

### SYMPOSIUM

#### Atrial fibrillation — new challenges and our readiness for the answer

**Chairpersons: Duplyakov D.V.** (Samara), **Romanov A.B.** (Novosibirsk)

- **Duplyakov D.V.** (Samara). Atrial Fibrillation in new realities.
- **Romanov A.B.** (Novosibirsk). Myocardial Infarction and AF.
- **Zolotovskaya I.A.** (Samara). Stroke and AF.
- **Pochinka I.G., Botova S.N., Gvozdulina M.V.** (Nizhny Novgorod). Atrial Fibrillation in a Multidisciplinary 1000-bed Hospital.
- **Pavlova T.V.** (Samara). The answer to new calls within the Samara regional project on AF.

## LADOGA HALL

09.00–10.30

### SATELLITE SYMPOSIUM

**10 years of rivaroxaban in the world.**

**For the welfare of health and lives**

(supported by Bayer, CME points are not accrued)

*Simultaneous translation*

- **Shlyakhto E.V.** (Saint-Petersburg). Welcome and introduction.
- **Hessman N.** (Moscow). BAYER in Russia: yesterday, today, tomorrow.
- **Vlasov D.V.** (Moscow). When a pharmaceutical company and a doctor work together for the benefit of a patient.
- **Ergene O.** (Turkey). Modern approaches to the management of patients with atrial fibrillation.
- **Konstantinides S.** (Germany). Anticoagulant therapy in PE patients according to current European guidelines.

## PLENARY HALL

11.00–12.30

### SATELLITE SYMPOSIUM

**Hypertension therapy 2018:**

**at the crossroad of cardiovascular risks**

(supported by Sanofi, CME points are not accrued)

*On-line broadcasting / Simultaneous translation*

**Chairperson: Karpov Yu.A.** (Moscow)

- **Karpov Yu.A.** (Moscow). The way to long-term control of blood pressure for stable life of patients with arterial hypertension.
- **Fomin I.V.** (Nizhny Novgorod). New BP targets — new routs in patients with hypertension and target organs damage.
- **Napalkov D.A.** (Moscow). Arterial hypertension and atherosclerosis: which road to follow.

## CONGRESS HALL №2

11.00–12.30

### SATELLITE SYMPOSIUM

**Cardio-Endo DUEL or Cardio-Endo DUET?**

(supported by Boehringer Ingelheim, CME points are not accrued)

**Chairpersons: Boytsov S.A.** (Moscow), **Shestakova M.V.** (Moscow)

- **Galstyan G.R.** (Moscow). The management of risk factor in type 2 diabetes: opportunities and perspectives.
- **Napalkov D.A.** (Moscow). The management of risk factor in type 2 diabetes: opportunities and perspectives.
- **Sergienko I.V.** (Moscow). CKD as a cardiovascular risk factor in DM 2.
- **Shamkhalova M.Sh.** (Moscow). CKD as a cardiovascular risk factor in DM 2.
- **Khalimov Yu.Sh.** (Saint-Petersburg). DM 2 with CHF — what are the recommendations for the choice of therapy?
- **Zhirov I.** (Moscow). DM 2 with CHF — what are the recommendations for the choice of therapy?
- **All the experts. Discussion.**

## AMPHITHEATER HALL

11.00–12.30

### SATELLITE SYMPOSIUM

**Three sets for the victory over hypertension — complex approach in the treatment, what do the latest guidelines say**

(supported by KRKA, CME points are not accrued)

*On-line broadcasting*

**Chairperson: Boytsov S.A.** (Moscow)

- **Boytsov S.A.** (Moscow). Arterial hypertension — the game of survival.
- **Ostroumova O.D.** (Moscow). First set: first serve has to be strong- what is written in the last guidelines.
- **Galyavich A.S.** (Kazan). Second set: how to foresee the overcome of the game or what to do for improving prognosis.
- **Ageev F.T.** (Moscow). Third set: Simple schemes for the final victory over hypertension.



## PRESS HALL

11.00–12.30

### SATELLITE SYMPOSIUM

#### The new concepts of angina management in the clinical practice

(supported by Servier, CME points are not accrued)

*Simultaneous translation*

##### Chairpersons:

**Glezer M.G.** (Moscow), **Nedoshivin A.O.** (Saint-Petersburg)

- **Nedoshivin A.O.** (Saint-Petersburg). Overview of current tendencies of SA treatment.
- **Marzilli M.** (Italy). Patient-oriented approach in stable angina management.
- **Glezer M.G.** (Moscow). New opportunities in angina therapy. ODA trial results.
- **Lopatin Yu.M.** (Volgograd). Optimal medical treatment of stable angina. Questions and answers.

## URAL HALL

11.00–12.30

### SCIENTIFIC SESSION

#### CAD, lipids and atherosclerosis

**Chairpersons:** **Grinshtein Yu.I.** (Krasnoyarsk), **Yakhontov D.A.** (Novosibirsk)

- **Goncharov M.D., Savchenko A.A., Mongush T.S., Kosinova A.A., Grischenko D.A., Grinshtein Yu.I.** (Krasnoyarsk). Peculiarities of chemiluminescent activity of thrombocytes in CAD patients before and after bypass surgery during the ASA therapy.
- **Yakhontov D.A., Ostanina Yu.O., Zvonkova A.V., Shulyatieva O.Yu., Dunicheva O.V., Yakhontova P.K.** (Novosibirsk). Diagnostic criteria of the early vascular aging syndrome in CAD and hypertension patients of young and middle age.

- **Khokhlov R.A.** (Voronezh). Prevalence of family hypercholesteremia among patients with cerebrovascular pathology.
- **Gerasimova E.V., Popkova T.V., Fomicheva O.A., Krugliy L.B., Glukhova S.I., Novikova D.S., Nasonov E.L.** (Moscow). Predictors of coronary artery atherosclerosis in patients with rheumatoid arthritis.
- **Kozlova E.V., Starostin I.V., Bulkina O.S., Lopukhova V.V., Karpov Yu.A.** (Moscow). Impact of coronary collateral blood circulation on clinical course of CAD.
- **Filatova A.Yu., Potekhina A.V., Romasov I.V., Osokina A.K., Schinova A.M., Noeva E.A., Zharova E.A., Merkulov E.V., Samko A.N., Provatorov S.I.** (Moscow). Time limits and frequency of restenosing of 1 and 2 generation coronary stents according to the one-center registry.
- **Tolpygina S.N., Deev A.D., Martsevich S.Yu.** (Moscow). New stratification scale of long-term risk of cardiovascular complications in CAD patients according to data of clinical and instrumental examination and coronary angiography.

## BAIKAL HALL

11.00–12.30

### SYMPOSIUM

#### “CARDIOBESITY”: obesity and cardiovascular diseases

**Chairpersons:** **Drapkina O.M.** (Moscow)

- **Drapkina O.M.** (Moscow). CVD-Obesity: the role of obesity in cardiovascular diseases.
- **Chumakova G.A.** (Barnaul). ATHERO-Obesity: obesity and atherosclerosis.
- **Druzhilov M.A.** (Petrozavodsk). EVA-Obesity: obesity and arteriolosclerosis.
- **Kuznetsova T.Yu.** (Petrozavodsk). HAF-Obesity: obesity and heart remodeling.



## AMUR HALL

11.00–12.30

### SATELLITE SYMPOSIUM

**Qualitative emergency medical services in acute myocardial infarction is a question of life for patients (experience of Moscow)**

(supported by AstraZeneca, CME points are not accrued)

*On-line broadcasting*

**Chairperson: Vasilieva E.Yu.** (Moscow)

- **Skrypnik D.V.** (Moscow). Do not underestimate the minutes.
- **Lebedeva A.Yu.** (Moscow). The hospital doctor — “caliph for an hour” or “guardian angel”?
- **Ananicheva N.A.** (Moscow). One is responsible for all: key issues for outpatient management of patients after myocardial infarction.

## YENISEI HALL

11.00–12.30

### SATELLITE SYMPOSIUM

**Patients of high and very high risk: hot issues of primary and secondary prevention**

(supported by Egis, CME points are not accrued)

**Chairpersons:**

**Martsevich S.Yu.** (Moscow), **Nebieridze D.V.** (Moscow)

- **Nebieridze D.V.** (Moscow). Patient of high and very high cardiovascular risk: definition, modern tactics of reference.
- **Martsevich S.Yu.** (Moscow). Basic principles of combined therapy of patients with high cardiovascular risk.
- **Eliseev M.S.** (Moscow). Hyperuricemia as a risk factor for cardiovascular disease and a new target of drug therapy.

## VOLGA HALL

11.00–12.30

### SATELLITE SYMPOSIUM

**Anniversary of blockbusters in cardiology: the path of therapy of length from hypertension to chronic HF**

(supported by Pfizer, CME points are not accrued)

*On-line broadcasting*

**Chairpersons: Nedogoda S.V.** (Volgograd)

- **Nedogoda S.V.** (Volgograd). Do we know everything about the patient with the variability of blood pressure? Making clarity.
- **Karpov Yu.A.** (Moscow). Powerful evidence base atorvastatin as a basis for exploring new horizons.
- **Lopatin Yu.M.** (Volgograd). Patient with CHF and comorbid pathology: improving the prognosis.

## DVINA HALL

11.00–12.30

### SYMPOSIUM

**The current state of the problem of arterial hypertension: do we need new approaches to diagnosis and treatment?**

**Chairpersons: Konradi A.O.** (Saint-Petersburg), **Kobalava Zh.D.** (Moscow), **Popov S.V.** (Tomsk)

- **Konradi A.O.** (Saint-Petersburg). Evolution of criteria for arterial hypertension — where to move further?
- **Kobalava Zh.D., Shavarova E.K.** (Moscow). Hemodynamic and neurohumoral profiling of blood pressure as a key to optimizing the treatment of arterial hypertension.
- **Mordovin V.F., Ripp T.M., Pekarskiy S.E., Falkovskaya A.Yu., Lichikaki V.A., Sitkova E.S., Zyubanova I.V.** (Tomsk). New medical technologies provide more effective diagnostic and treatment in patients with arterial hypertension.
- **Pekarskiy S.E., Baev A.E., Mordovin V.F., Ripp T.M., Falkovskaya A.Yu., Sitkova E.S., Lichikaki V.A., Popov S.V.** (Tomsk). Renal denervation pro and contra.

- **Ripp T.M., Mordovin V.F., Pekarskiy S.E., Ryabova T.R., Baev A.E., Falkovskaya A.Yu., Lichikaki V.A., Sitkova E.S., Zorkaltseva M.A., Popov S.V.** (Tomsk). New medical technologies and aspects of target organ protection in the treatment of hypertension and comorbid pathology.
- **Zvartau N.E., Konradi A.O.** (Saint-Petersburg). Modern technologies of individualized selection of antihypertensive therapy.

## ANGARA HALL

11.00–12.30

### SYMPOSIUM

**Reperfusion therapy of acute myocardial infarction.  
Current state of the issue**

Chairpersons: **Tereshchenko S.N.** (Moscow), **Markov V.A.** (Tomsk)

- **Tereshchenko S.V.** (Moscow). Current status and approaches to assisting patients with acute myocardial infarction.
- **Markov V.A.**<sup>1</sup>, **Gerasimets E.A.**<sup>2</sup>, **Alekseeva Ya.V.**<sup>1</sup> (Tomsk<sup>1</sup>, Moscow<sup>2</sup>). Clinical study FRIDOM1, the results of a one-year follow-up.
- **Gorbacheva S.M.** (Irkutsk). The results of introducing new opportunities for medical care to patients with acute myocardial infarction.
- **Markin S.S.** (Moscow), **Yakushin S.S.** (Ryazan), **Konstantinov S.L.** (Belgorod). New approaches for heart remodeling after STEMI at basis of genomic and metabolomic technologies.

## LADOGA HALL

11.00–12.30

### SATELLITE SYMPOSIUM

**Workshop: Case report: A patient with atrial fibrillation and chronic kidney disease. How to treat and what to keep in mind?**  
(supported by Bayer, CME points are not accrued)

- **Arutyunov G.** (Moscow)
- **Koziolova N.** (Perm)

Lunch

11.00–12.30

### WORKSHOPS

**A joint project of the Russian Society of Cardiology and Bayer**

(supported by Bayer, CME points are not accrued)

### ONEGA HALL

Case report: Practical aspects of AF patient's treatment. Simple solutions to serious problems.

- **Andreev D.A.** (Moscow)

### MEETING ROOM 1

Case report: Treatment of patients with PE in a hospital. Where one can find pitfalls?

- **Duplyakov D.V.** (Samara)
- **Khasanov N.R.** (Kazan)

### MEETING ROOM 2

Case report: An elderly patient with AF. 5 features of the treatment, which are worth paying attention to.

- **Tkacheva O.N.** (Moscow)
- **Turov A.N.** (Novosibirsk)

### MEETING ROOM 3

Case report: Anticoagulant therapy features in "complex" patients with PE.

- **Komarov A.L.** (Moscow)
- **Gilarov M.Yu.** (Moscow)

### MEETING ROOM 4

Case report: An AF patient with a history of previous stroke/TIA. How to avoid mistakes in the therapy selection?

- **Gilyarevskiy S.R.** (Moscow)
- **Ostroumova O.D.** (Moscow)

Lunch

## PLENARY HALL

12.40–13.20

### PLENARY LECTURE

*On-line broadcasting / Simultaneous translation*

**Moderator: Matskeplishvili S.T.** (Moscow)

- **Pinto F.** (Portugal). Beyond ejection fraction: What new parameters can echo provide?

## PLENARY HALL

13.30–15.00

### PLENARY SESSION

**Epidemiology of cardiovascular diseases in Russia in the era of mortality reduction**

*On-line broadcasting / Simultaneous translation*

**Chairpersons:**

**Konradi A.O.** (Saint-Petersburg), **Drapkina O.M.** (Moscow)

- **Boytsov S.A.** (Moscow). Fat or sweet — what shortens our lives?
- **Leon D.** (United Kingdom). The prospect of reducing differences in cardiovascular mortality between countries.
- **Shalnova S.A.** (Moscow). Russian epidemiology is half a century. The successes and failures.
- **Tkacheva O.N.** (Moscow). Cardiovascular diseases in the aspect of aging.

## CONGRESS HALL №2

13.30–15.00

### SATELLITE SYMPOSIUM

**Indirect anticoagulants in the era of new drugs**  
(supported by Takeda, CME points are not accrued)

**Chairpersons:**

**Vavilova T.V.** (Saint-Petersburg), **Zateyshchikov D.A.** (Moscow)

- **Zateyshchikov D.A.** (Moscow). Indirect anticoagulants: the risks and benefits in terms of 2018.
- **Zotova I.V.** (Moscow). Evidence-based medicine position of warfarin in modern cardiological practice.
- **Vavilova T.V.** (Saint-Petersburg). Long-term anticoagulant therapy — how to hit the right path.
- **Gorbunova E.V.** (Kemerovo). The role of the centralized control of INR in increasing adherence to treatment.

## AMPHITHEATER HALL

13.30–15.00

### SATELLITE SYMPOSIUM

**Myocardial Infarction 2018**

(supported by Sanofi, CME points are not accrued)

*On-line broadcasting*

**Chairperson: Ruda M.Ya.** (Moscow)

- **Barbarash O.L.** (Kemerovo). ACS — Non STEMI.
- **Yavelov I.S.** (Moscow). De-escalation — a new approach for DAPT.
- **Averkov O.V.** (Moscow). ACS — STEMI.

## PRESS HALL

13.30–15.00

### SATELLITE SYMPOSIUM

#### Choice 2018: The future of the patient with chronic heart failure — the decision is yours

(supported by Novartis Pharma, CME points are not accrued)

Chairperson: Glezer M.G. (Moscow)

- **Mareev V.Yu.** (Moscow). Updated clinical Guidelines and real practice—the basis for choosing CHF treatment.
- **Glezer M.G.** (Moscow). CHF patient with comorbidities. Simple solutions for the “complicated” patient.
- **Fomin I.V.** (Nizhny Novgorod). CHF patient with NYHA functional class II. In anticipation of “the storm”.
- **Discussion.**

## URAL HALL

13.30–15.00

### SCIENTIFIC SESSION

#### Clinical basis of interventional treatment of arrhythmias

Chairpersons: **Popov S.V.** (Tomsk), **Gilyarov M.Yu.** (Moscow), **Lebedev D.S.** (Saint-Petersburg)

- **Mikhailichenko S.I., Neminuschiy N.M.** (Moscow). Main predictors of ICD therapy and life quality of patients with ICD.
- **Utsumueva M.D., Kastanova S.Yu., Mironova N.A., Gupalo E.M., Tarasovskiy G.S., Kiktev V.G., Stukalova O.V., Ternovoy S.K., Golitsyn S.P.** (Moscow). Intensity of myocardial fibrosis and response to cardiac resynchronized therapy.
- **Lebedev D.I., Zlobina M.V., Lebedeva M.V., Gulya M.O., Popov S.V.** (Tomsk). Modern methods of selection of patients with non-ischaemic cardiomyopathy for cardiac resynchronized therapy.
- **Romanov A.B., Shabanov V.V., Losik D.V., Minin S.M., Nikitin N.A., Mikheenko I.L., Pokushalov E.A.** (Novosibirsk). Impact of catheter ablation on the sympathetic activity regions visualized with I-123 MIBG in patients with atrial fibrillation.

- **Bokeria L.A., Bokeria O.L., Biniashvili M.B., Filatov A.G., Yurkulieva G.A.** (Moscow). Surgical ablation of atrial fibrillation off-pump with 3D electroanatomic mapping in patients with CAD.
- **Dubanaev A.A., Smorgon A.V., Archakov E.A., Usenkov S.Yu., Batalov R.E., Popov S.V.** (Tomsk). The role of speckle-tracking echocardiography in catheter treatment of atrial fibrillation.
- **Badykova E.A., Plechev V.V., Badykov M.R., Sagitov I.Sh., Lakman I.A., Zagidullin N.Sh.** (Ufa). Analysis of remote cardiovascular events in patients with sinus node dysfunction and ICD.

## BAIKAL HALL

13.30–15.00

### SYMPOSIUM

#### Myocardial infarction: elements of clinical mosaic

Chairperson: **Galyavich A.S.** (Kazan)

- **Galyavich A.S.** (Kazan). Myocardial Infarction Type 4.
- **Kamalov G.M.** (Kazan). Myocardial Infarction Type 2.
- **Galeeva Z.M.** (Kazan). Myocardial Infarction at a young age.
- **Baleeva L.V.** (Kazan). Myocardial infarction in older adults.

## AMUR HALL

13.30–15.00

### SATELLITE SYMPOSIUM

#### Statins in the kingdom of crooked mirrors

(supported by AstraZeneca, CME points are not accrued)

Chairpersons: **Kobalava Zh.D.** (Moscow), **Susekov A.V.** (Moscow), **Mareev V.Yu.** (Moscow)

- **Kobalava Zh.D.** (Moscow). Statins in the Kingdom of Crooked Mirrors or view from the outside.
- **Susekov A.V.** (Moscow). Original rosuvastatin: interchangeability? — No, reference? — Yes.
- **Mareev V.Yu.** (Moscow). Statins: prescribe don't cancel.
- **Discussion.**

## YENISEI HALL

13.30–15.00

### SATELLITE SYMPOSIUM

#### How to reach the goal? New possibilities in combined therapy of hypertension

(supported by Berlin-Chemie/A.Menarini, CME points are not accrued)

**Chairpersons:** Arutyunov G.P. (Moscow), Orlova Ya.A. (Moscow), Kotovskaya Yu.V. (Moscow)

- **Arutyunov G.P.** (Moscow). Nephroprotection in patients with arterial hypertension: present and future.
- **Orlova Ya.A.** (Moscow). The view of a cardiologist on the therapy of arterial hypertension: what do recent studies suggest?
- **Kotovskaya Yu.V.** (Moscow). A geriatric view on the therapy of arterial hypertension.

## VOLGA HALL

13.30–15.00

### SYMPOSIUM

#### Hot issues of perioperative medicine: assessment and correction of cardiac risk

**Chairpersons:** Sumin A.N. (Kemerovo), Belyalov F.I. (Irkutsk), Duplyakov D.V. (Samara)

- **Sumin A.N.** (Kemerovo). Evaluation of troponin in non-cardiac operations: clinical and prognostic value.
- **Belyalov F.I.** (Irkutsk). Risk Scores in Prediction of Risk After Cardiac Surgery.
- **Kulagina T.Yu.** (Moscow). Place of cardiorespiratory load test in a multidisciplinary surgical clinic.
- **Chomakhidze P.Sh.** (Moscow). Methods of functional diagnostics in assessing the risk of non-cardiac surgical interventions.
- **Korok E.V., Bezdenezhnykh A.V., Sumin A.N.** (Kemerovo). Preoperative assessment of cardiac risk in vascular operations: what's new?
- **Medvedeva E.A.** (Saint-Petersburg), **Duplyakov D.V.** (Samara). Is there a need to develop national guidelines on the evaluation of cardiac risk?

## DVINA HALL

13.30–15.00

### SYMPOSIUM

#### Screening of patients with hypertension

**Chairpersons:** Libis R.A. (Orenburg), Gapon L.I. (Tyumen)

- **Libis R.A.** (Orenburg). Methods of measuring and assessing blood pressure.
- **Lipchenko A.A.** (Ekaterinburg). Modern criteria of defeat of target organs in hypertension.
- **Gapon L.I.** (Tyumen). New horizons in the treatment of hypertension.
- **Shaposhnik I.I.** (Chelyabinsk). Principles of annual screening of patients with hypertension.

## ANGARA HALL

13.30–15.00

### CLINICAL DISCUSSION

#### Wide complex arrhythmias in pregnant women: to observe. it is impossible. to treat

**Chairpersons:** Pervova E.V. (Moscow), Zaklyazminskaya E.V. (Moscow), Stryuk R.I. (Moscow)

- **Pervova E.V.** (Moscow). Analysis of wide-complex arrhythmias on the ECG is the first step in the treatment of patient.
- **Chernysheva S.G., Gasanova R.M.** (Moscow). Seven times to think, one time to make a decision. Antiarrhythmic therapy during the prenatal period, clinical cases.
- **Gromyko G.A.** (Moscow). Possibility and necessity of interventional treatment of wide-complex tachycardia in pregnant women.
- **Zaklyazminskaya E.V.** (Moscow). Approaches to family planning in the presence of hereditary arrhythmogenic syndromes.
- **Stryuk R.I.** (Moscow). A differentiated approach to the treatment of arrhythmias in pregnant women.

## LADOGA HALL

13.30–15.00

### SATELLITE SYMPOSIUM

#### How to prolong the life of patients with Coronary Artery Disease (CAD)? The revolution of treatment approaches

(supported by Bayer, CME points are not accrued)

*On-line broadcasting / Simultaneous translation*

**Chairpersons:** Karpov Yu.A. (Moscow), Pogosova N.V. (Moscow)

- **Yavelov I.S.** (Moscow). Risk of cardiovascular events in patients with stable coronary artery disease. What do the registers say?
- **De Caterina R.** (Italy). New approaches in treatment of patients with stable cardiovascular disease. The results of the COMPASS trial.
- **Fomin I.V.** (Nizhny Novgorod). Antithrombotic therapy for patients with cardiovascular diseases: from coronary disease to heart failure.

**Break**

## PLENARY HALL

15.30–17.00

### PLENARY SESSION

#### Cardiac radiology in coronary artery disease evaluation

*On-line broadcasting / Simultaneous translation*

**Chairpersons:** Vasyuk Yu.A. (Moscow), Golukhova E.Z. (Moscow), Kuznetsov V.A. (Tyumen), Ternovoy S.K. (Moscow)

- **Alekhin M.N., Vasyuk Yu.A., Golukhova E.Z., Mashina T.V., Mrikaev D.V., Saidova M.A.** (Moscow). The value of Echocardiography in patients with coronary artery disease.
- **Ternovoy S.K., Veselova T.N., Basek I.V.** (Moscow). CT in coronary heart disease: possibilities and prospects.
- **Trufanov G.E.<sup>1</sup>, Fokin V.A.<sup>1</sup>, Stukalova O.V.<sup>2</sup>, Ryzhkov A.V.<sup>1</sup>** (Saint-Petersburg<sup>1</sup>, Moscow<sup>2</sup>). Cardiac magnetic resonance imaging in evaluation of patients with coronary artery disease.

- **Zavadovskiy K.V.** (Tomsk), **Aslanidi I.P.** (Moscow), **Ryzhkova D.V.** (Saint-Petersburg). Modern possibilities of nuclear medicine in the diagnosis of coronary artery disease.

## CONGRESS HALL №2

15.30–17.00

### SATELLITE SYMPOSIUM

#### Stroke prevention in atrial fibrillation: taking of clinical decision from evidence base medicine

(supported by Pfizer, CME points are not accrued)

**Chairpersons:**

Gilyarevskiy S.R. (Moscow), Lopatin Yu.M. (Volgograd)

- **Gilyarevskiy S.R.** (Moscow), **Lopatin Yu.M.** (Volgograd). Introduction.
- **Gilyarevskiy S.R.** (Moscow). That is not an easy clinical decision. What gave us the “era” of new oral anticoagulants.
- **Lopatin Yu.M.** (Volgograd). A patient with a high risk of anticoagulant therapy: balancing on the brink.
- **Kobalava Zh.D.** (Moscow). Not a reason to not appoint: CKD and anticoagulant therapy.
- **Ageev F.T.** (Moscow). Age is not an obstacle! How to optimize anticoagulant therapy with AF in the elderly.
- **Discussion.**



## AMPHITHEATER HALL

15.30–17.00

### SATELLITE SYMPOSIUM

**How does your practice change after specific antagonist to anticoagulant appear**

(supported by Boehringer Ingelheim, CME points are not accrued)

*On-line broadcasting / Simultaneous translation*

**Chairpersons:**

**Zamyatyn M.N.** (Moscow), **Mikhailov E.N.** (Saint-Petersburg)

- **Van Ryn J.** (Germany). Idaruzisumab — innovations into clinical practice.
- **Zamyatyn M.N.** (Moscow). Algorithm of management of patient with AF in urgent surgery.
- **Vinogradov O.I.** (Moscow). Stroke in patient taking antithrombotic therapy — could we make thrombolysis.
- **Mikhailov E.N.** (Saint-Petersburg). Risk management by ablation of patients taking anticoagulants.
- **Questions & Answers.**

## PRESS HALL

15.30–17.00

### SATELLITE SYMPOSIUM

**Complexity of individual cardiovascular risk management: focus on patient's adherence**

(supported by Dr. Reddy's Laboratories, CME points are not accrued)

*On-line broadcasting*

**Chairpersons:** **Ageev F.T.** (Moscow), **Napalkov D.A.** (Moscow)

- **Ageev F.T.** (Moscow). High cardiovascular risk and adherence to treatment.
- **Napalkov D.A.** (Moscow). Fixed dose combinations: What? Which patient? When?
- **Ostroumova O.D.** (Moscow). Real clinical practice: TINA registry.

## URAL HALL

15.30–17.00

### SYMPOSIUM

**Traditions of the national higher school plus innovations of the XXI century**

**Chairpersons:** **Shlyk S.V.** (Rostov-on-Don), **Balkizov Z.Z.** (Moscow), **Drobotya N.V.** (Rostov-on-Don), **Prirodova O.F.** (Moscow)

- **Shlyk S.V.** (Rostov-on-Don). Possibilities of continuing professional education of cardiologists.
- **Prirodova O.F.** (Moscow). Continuing medical education: results and prospects.
- **Balkizov Z.Z.** (Moscow). Development of the continuing medical education jointly with the professional medical non-profit organizations.
- **Drobotya N.V., Kaltykova V.V., Pirozhenko A.A.** (Rostov-on-Don). Modern approaches to quality control of education in medical Universities, on the example of Rostov State Medical University.
- **Khaisheva L.A., Glova S.E., Khorolets E.V.** (Rostov-on-Don). The level of knowledge on the problems of cardiovascular pathology by primary care physicians of the Rostov region according to the results of the survey.

## BAIKAL HALL

15.30–17.00

### SYMPOSIUM

**Features of management of patients with ACS in the Siberian region**

**Chairpersons:** **Repin A.N.** (Tomsk), **Barbarash O.L.** (Kemerovo)

- **Repin A.N.** (Tomsk). Myocardial infarction in the Tomsk Region: achievements and challenges.
- **Barbarash O.L., Kashtalov V.V.** (Kemerovo). Management of specialized health care to patients with ACS in the Kemerovo region. n the Kemerovo region.
- **Tavlyueva E.V., Alekseenko A.V., Barbarash O.L.** (Kemerovo). Effects of replacing the dual antiplatelet therapy in patients with ACS on the example of the Siberian region.
- **Ustyugov S.A.** (Krasnoyarsk). Krasnoyarsk region. Organizational and clinical features of the heart attack network.



## AMUR HALL

15.30–17.00

### ROUND TABLE

**Problems of classification, coding and assessment of mortality from coronary artery disease in the Russian Federation**

**Chairpersons:** **Boytsov S.A.** (Moscow), **Shlyakhto E.V.** (Saint-Petersburg), **Kakorina E.P.** (Moscow)

- **Kakorina E.P.** (Moscow). Features of the structure of mortality in the Russian Federation.
- **Waisman D.Sh.** (Moscow). Principles of coding and selection of the original cause of death from coronary heart disease in accordance with ICD-10.
- **Zayratyants O.V.** (Moscow). Classification of CAD and ICD-10: the viewpoint of the pathologist.
- **Boytsov S.A.<sup>1</sup>, Yakushin S.S.<sup>2</sup>, Samorodskaya I.V.<sup>1</sup>, Nikulina N.N.<sup>2</sup>** (Moscow<sup>1</sup>, Ryazan<sup>2</sup>). Suggestions on creation of the Russian clinico-morphological classification of CAD.

## YENISEI HALL

15.30–17.00

### TRAINING SEMINAR

**Value of the nurse in implementation of clinical guidelines**

**Chairpersons:** **Duplyakov D.V.** (Samara), **Lapotnikov V.A.** (Saint-Petersburg)

- **Duplyakov D.V.** (Samara). RSC WG Nurses in Cardiology and European Experience.
- **Andguladze O.P., Anikeeva E.S.** (Kemerovo). Acute Coronary Syndrome.
- **Kulagina E.N.** (Saratov). Heart Failure.
- **Utesheva T.D.** (Moscow). Atrial Fibrillation.
- **Berezkina T.D.** (Saint-Petersburg). Dislipidemia.
- **Inozemtseva S.V.** (Samara). RSC WG Nurses in Cardiology — Plans and Perspectives.

## VOLGA HALL

15.30–17.00

### SYMPOSIUM

**Inflammatory heart diseases — 2018**

**Chairpersons:**

**Paleev F.N.** (Moscow), **Demin A.A.** (Novosibirsk), **Tyurin V.P.** (Moscow)

- **Paleev F.N.** (Moscow). Myocarditis: theoretical and practical aspects.
- **Demin A.A.** (Novosibirsk). Infective endocarditis today.
- **Tyurin V.P.** (Moscow). Pericarditis in cardiological practice.
- **Moiseeva O.M., Ignatieva E.S., Ryzhkova D.V.** (Saint-Petersburg). Cardiac sarcoidosis: algorithms for diagnosis and treatment.

## DVINA HALL

15.30–17.00

### SYMPOSIUM

**Heart and psyche: uneasy questions at the outpatient visit, and how to solve it by clinician**

**Chairpersons:** **Pogosova N.V.** (Moscow), **Mareev V.Yu.** (Moscow)

- **Pogosova N.V.** (Moscow). Anxiety, depression, personality type D, social isolation and cardiovascular diseases: what is important to know.
- **Begrambekova Yu.L.** (Moscow). Anxiety-depressive disorders in patients with CHF: clinical characteristics and approaches to treatment.
- **Kursakov A.A.** (Moscow). Depression in outpatient practice: approaches to diagnosis and treatment in real clinical examples.

## ANGARA HALL

15.30–17.00

### SYMPOSIUM

#### Dispensarization of patients with stable CAD

Chairpersons: **Libis R.A.** (Orenburg), **Shaposhnik I.I.** (Chelyabinsk)

- **Libis R.A.** (Orenburg). The methods of verification of diagnosis of stable CAD.
- **Maximov N.I.** (Izhevsk). Diagnostic features of clinical forms of stable CAD.
- **Smolenskaya O.G.** (Ekaterinburg). Therapeutic tactics in various forms of stable CAD.
- **Shaposhnik I.I.** (Chelyabinsk). Principles of dispensarization of patients with stable CAD.

## LADOGA HALL

15.30–17.00

### SATELLITE SYMPOSIUM

#### Strategy of treatment in PATE patient according to current ESC guidelines

(supported by Bayer, CME points are not accrued)

*Simultaneous translation*

- **Konstantinides S.** (Germany)
- **Yavelov I.S.** (Moscow)

15.30–17.00

### WORKSHOPS

#### A joint project of the Russian Society of Cardiology and Bayer

(supported by Bayer, CME points are not accrued)

## ONEGA HALL

**Analysis of clinical cases: tactics of management of a patient with AF after PCI.**

- **Shubik Yu.V.** (Saint-Petersburg)
- **Obrezan A.G.** (Saint-Petersburg)

## MEETING ROOM 1

**Antithrombotic therapy in patients with CHF. What is known today?**

- **Arutyunov G.P.** (Moscow)

## MEETING ROOM 2

**Which CAD patient will benefit the most from the combination therapy of rivaroxaban and ASA?**

- **Panchenko E.P.** (Moscow)
- **Novikova N.A.** (Moscow)

## MEETING ROOM 3

**A view of a practical cardiologist on the results of the COMPASS study, clinical examples.**

- **Andreev D.A.** (Moscow)
- **Perepech N.B.** (Saint-Petersburg)

## MEETING ROOM 4

**How to assess the benefit-risk balance in a patient with stable coronary artery disease for the appointment of long-term antithrombotic therapy?**

- **Averkov O.V.** (Moscow)

	World Trade Center Moscow, 2 floor						Office building №2, 2 floor					Office building №2, 4 floor
	PLENARY HALL	CONGRESS HALL #2	AMPHITHEATER HALL	PRESS HALL	URAL HALL	BAIKAL HALL	AMUR HALL	YENISEI HALL	VOLGA HALL	DVINA HALL	ANGARA HALL	LADOGA HALL
09:00-10:30	Plenary Session Heart failure — 2018  On-line broadcasting / Simultaneous translation	Symposium Myocardial deformation characteristics — perspectives of clinical implementation	Symposium Horizons of CVD epidemiology. Yesterday, today and tomorrow	Symposium Electroanatomical substrate of cardiac arrhythmias: current views and diagnostic criteria	Scientific session Innovations in diagnostics and treatment tactics of patients with CHF and polymorbidity	Symposium Siberia is a region with high cardiovascular mortality: from follow up to intervention	Symposium Hypertrophic cardiomyopathy	Symposium Obesity as a global factor in cardiovascular risk	Symposium Rare and difficult cases of diagnosis and treatment of acute coronary syndrome	Symposium Age peculiarities in the therapy of cardiovascular diseases in clinical practice	Symposium Mitral valve prolapse: features of diagnostics, clinical picture and management	Russian-Serbian Joint Symposium (with the Cardiology Society of Serbia) Management of patient with high cardiovascular risk  Simultaneous translation
10.30-11.00 BREAK						10.30-11.00 BREAK						
11.00-12.30	Satellite symposium Acute coronary syndrome: achievements and perspectives  (supported by Sanofi, CME points are not accrued)  On-line broadcasting / Simultaneous translation	Symposium Modern aspects of diagnostics, predicting the course and treatment of hypertrophic cardiomyopathy	Satellite symposium Comorbid patient with atrial fibrillation — the opinion of five experts. How to find a single solution?  (supported by Bayer, CME points are not accrued)  On-line broadcasting	Scientific session Registries as an important tool of value-based medicine	Scientific session Resistant hypertension: opportunities of invasive treatment	Conference Engagement of specialists of allied professions to writing, review and publishing of articles in the Russian Journal of Cardiology. Discussion and search for solutions.	Symposium Metabolic disorders and coronary atherosclerosis	Satellite symposium Is there any news for chronic heart failure treatment in the latest guidelines?  (supported by Akrikhin, CME points are not accrued)	Symposium Interactive quiz on cardiovascular imaging — Jeopardy!	Symposium Correlation between obesity and cardiovascular disease — what's new?	Symposium Connective tissue dysplasia in cardiology	Symposium Why is there a high level of cardiovascular mortality in Russia? Comparative studies of CVD phenotypes, risk factors and treatment  Simultaneous translation
12.40-13.20	<b>PLENARY LECTURE</b> <b>MODERATOR: LOPATIN Y. (VOLGOGRAD)</b> <b>KUANYSHBEKOVA R.T., DZHUNUSBEKOVA G.A. (KAZAKHSTAN). IMPLEMENTATION OF CONTROL PROGRAMME ON HYPERTENSION, CHF AND DIABETES MELLITUS IN THE REPUBLIC OF KAZAKHSTAN.</b>  On-line broadcasting / Simultaneous translation						<b>PLENARY LECTURE</b> <b>MODERATOR: LOPATIN Y. (VOLGOGRAD)</b> <b>KUANYSHBEKOVA R.T., DZHUNUSBEKOVA G.A. (KAZAKHSTAN). IMPLEMENTATION OF CONTROL PROGRAMME ON HYPERTENSION, CHF AND DIABETES MELLITUS IN THE REPUBLIC OF KAZAKHSTAN.</b>  On-line broadcasting / Simultaneous translation					
12.30-13.30 BREAK						12.30-13.30 BREAK						

	World Trade Center Moscow, 2 floor						Office building №2, 2 floor					Office building №2, 4 floor
	PLENARY HALL	CONGRESS HALL #2	AMPHITHEATER HALL	PRESS HALL	URAL HALL	BAIKAL HALL	AMUR HALL	YENISEI HALL	VOLGA HALL	DVINA HALL	ANGARA HALL	LADOGA HALL
13.30-15.00	Plenary Session Molecular and cell aspects of cardiovascular diseases  On-line broadcasting / Simultaneous translation	Symposium POLYPILL: from solving specific problems to differentiated application	Symposium Joint scientific symposium of the Russian Society of Cardiology and the National society for preventive cardiology. National guidelines on Cardiovascular prevention 2017	Satellite symposium New algorithms for cardiovascular risks reduction in diabetic patients: from safety concept to proven efficacy of therapy  (supported by NovoNordisk, CME points are not accrued)	Scientific session Management of patients with non-coronary pathology	Session of the Editorial Board of the Russian Journal of Cardiology	Symposium Rare disease or rare diagnosis?	Satellite symposium Modern approaches to management CHF patients, who need high-tech methods of treatment  (supported by Novartis Pharma, CME points are not accrued)	Symposium Missed opportunities in CV risk reduction	Symposium A patient-oriented approach to revascularization: acute phase and secondary prevention	Symposium Key hot issues of cardiorenal medicine. In the memory of V.S. Moiseev and N.A. Mukhin	Symposium Current issues of emergency cardiology: acute coronary syndrome in patients with non-obstructive changes of the coronary arteries  Simultaneous translation
15.00-15.30 BREAK						15.00-15.30 BREAK						
15.30-17.00	Plenary Session CAD, atherosclerosis, lipids  On-line broadcasting / Simultaneous translation	Scientific and practical conference Sectoral qualifications framework in health care	Symposium Pharmacological cardioversion of persistent atrial fibrillation: real opportunities	Symposium Patient with type 2 diabetes on a visit to a cardiologist	Scientific session Cardiovascular surgery	Session of the Council of Cardiology Journals	Symposium Pulmonary embolism — 2018	Symposium Pericarditis and myocarditis: new in diagnosis and treatment	Symposium Genetic aspects of arrhythmias	Symposium Fundamental and applied aspects of antiplatelet therapy in coronary heart disease. Is there any reason for discussion?	Symposium Arrhythmias in real clinical practice	Symposium Heart, vessels and ageing. Longitudinal international project HAPIEE: Russian findings  Simultaneous translation
17.00-17.30 BREAK						17.00-17.30 BREAK						
17.30-19.00	Plenary Session Aortic surgery: yesterday, today, tomorrow  On-line broadcasting / Simultaneous translation	Symposium Non-compact left ventricular myocardium: analysis of data from leading Russian registries 2018	Symposium The first experience of application of new diagnostic and therapeutic methods in patients with stable CAD in the Russian Federation	Symposium CRT: current indications and follow-up	Scientific session Emergency cardiology	Scientific session Cardiovascular diseases in rheumatology	Symposium National guidelines "Diagnostics and treatment of cardiovascular diseases during pregnancy" 2018: review and update	Symposium Ischemic heart disease: from the traditional understanding of the problem to innovation	Battle of scholars — 2018. Final competition	Symposium Modern biomarkers in risk stratification and treatment of patients with cardiovascular diseases and heart failure	Symposium The versatility of cardio-renal relations. A modern view on the problem	Symposium Genomics in cardiology: the time for practical solutions

## PLENARY HALL

09.00–10.30

### PLENARY SESSION

#### Heart failure – 2018

*On-line broadcasting / Simultaneous translation*

**Chairpersons:** Belenkov Yu.N. (Moscow), Lopatin Yu.M. (Volgograd)

- **Fomin I.V.** (Nizhny Novgorod). Portrait of a patient with HF in 2018.
- **Mareev V.Yu.** (Moscow). How correctly to treat HF in 2018?
- **Lopatin Yu.M.** (Volgograd). What do we know about HFmrEF in 2018?
- **Arutyunov G.P.** (Moscow). Prognostic role of pneumonia and upper tract urothelial infections in CHF patients.
- **Tereshchenko S.N.** (Moscow). Acute HF: successes and disappointments 2018.

## CONGRESS HALL №2

09.00–10.30

### SYMPOSIUM

#### Myocardial deformation characteristics — perspectives of clinical implementation

**Chairpersons:** Saidova M.A. (Moscow), Pavlyukova E.N. (Tomsk), Oleynikov V.E. (Penza)

- **Saidova M.A.** (Moscow). A new approach to the evaluation of left atrium function in various clinical situations.
- **Pavlyukova E.N.** (Tomsk). Clinical significance of evaluation of left ventricular mechanic in heart failure.
- **Petrova O.A., Alekhin M.N.** (Moscow). Speckle-tracking echocardiography of the right ventricle: diagnostic and prognostic value.
- **Galimskaya V.A., Oleynikov V.E.** (Penza). Issues and perspectives of contractility evaluation in myocardial infarction using the speckle echocardiography.
- **Basova V.A., Novikov V.I.** (Saint-Petersburg). Application of myocardial tissue echocardiography method to evaluate dyssynchrony.

## AMPHITHEATER HALL

09.00–10.30

### SYMPOSIUM

#### Horizons of CVD epidemiology. Yesterday, today and tomorrow

**Chairpersons:**

**Shalnova S.A.** (Moscow), **Konradi A.O.** (Saint-Petersburg), **Boytsov S.A.** (Moscow), **Shlyakhto E.V.** (Saint-Petersburg)

- **Shalnova S.A., Balanova Yu.A.** (Moscow). The main achievements of Epidemiology of CVD, what is the horizon?
- **Libis R.A.** (Orenburg). Prevalence of the main risk factors of cardiovascular diseases and their combinations in the unorganized population of Orenburg.
- **Grinshtein Yu.I., Shabalin V.V., Ruf R.R.** (Krasnoyarsk). Are there any peculiarities in the prevalence of hypertension and cardiovascular risk factors in Krasnoyarsk region?
- **Konradi A.O., Rotar O.P.** (Saint-Petersburg). Prehypertension in the Russian population — association with cardiometabolic disorders and lesions of target organs.
- **Kontsevaya A.V.** (Moscow). Socio-economic paradox: opposite gradients of risk factors prevalence.

## PRESS HALL

09.00–10.30

### SYMPOSIUM

#### Electroanatomical substrate of cardiac arrhythmias: current views and diagnostic criteria

**Chairpersons:** Lebedev D. (Saint-Petersburg), Golitsyn S. (Moscow), Popov S. (Tomsk)

- **Lebedev D., Mitrofanova L.** (Saint-Petersburg). Anatomico-histological substrate in patients with atrial fibrillation: a morphologist's view.
- **Orshanskaya V.** (Saint-Petersburg). Electroanatomic substrate in patients with atrial fibrillation. The effectiveness of interventional treatment in atrial fibrillation.

- **Moiseeva O., Titov V., Runov A., Vonsky M.** (Saint-Petersburg). Metabolic and transcriptomic markers of cardiac fibrosis in patients with atrial fibrillation.
- **Tatarskiy R.** (Saint-Petersburg), **Batalov R.** (Tomsk). Endomyocardial biopsy in arrhythmia diagnosis.

## URAL HALL

09.00–10.30

### SCIENTIFIC SESSION

#### Innovations in diagnostics and treatment tactics of patients with CHF and polymorbidity

Chairpersons: **Villevalde S.** (Moscow), **Shaposhnik I.** (Chelyabinsk)

- **Skorodumova E., Kostenko V., Skorodumova E.A., Siverina A., Rysev A.** (Saint-Petersburg). Does left ventricular function in acute decompensation of heart failure depend on coronary flow collateral in patients with borderline ejection fraction?
- **Kopieva K., Teplyakov A., Grakova E., Ogurkova O., Soldatenko M.** (Tomsk). New paradigm of heart failure: role of myocardial interleukine receptors family ST-2 as a target to  $\beta$ -adrenoblocators therapy in patients with HFpEF.
- **Mikheev S.<sup>1</sup>, Mandel I.<sup>1</sup>, Prakhov A.<sup>1</sup>, Shipulin V.<sup>2</sup>, Sukhodolo I.<sup>2</sup>, Svirko Yu.<sup>2</sup>, Podoksenov Yu.<sup>2</sup>** (Moscow<sup>1</sup>, Tomsk<sup>2</sup>). Correlation of ADMA/nitrite: marker of the early complications after cardiocurgical interventions in patients with left ventricular HFrEF.
- **Solovieva A., Bayarsaikhan M., Naumenko M., Garmash I., Villevalde S., Kobalava Zh.** (Moscow). Complex assessment of liver damage in decompensated HF.
- **Mujeeb A.M.<sup>1</sup>, Vijayaraghavan G.<sup>1</sup>, Orlova G.<sup>2</sup>, Suman O.S.<sup>1</sup>, Muneer A.R.<sup>1</sup>** (India<sup>1</sup>, Irkutsk<sup>2</sup>). Difficulty in management of heart failure if renal failure combines.
- **Namitokov A.M.** (Krasnodar). Heart transplantation in AMI.

## BAIKAL HALL

09.00–10.30

### SYMPOSIUM

#### Siberia is a region with high cardiovascular mortality: from follow up to intervention

Chairpersons: **Nikulina S.** (Krasnoyarsk), **Kalinina A.** (Moscow)

- **Barbarash O.** (Kemerovo). Cardiovascular risk factors — results and perspectives of epidemiology surveys.
- **Garganeeva N.** (Tomsk). Patients with hypertension and dyslipidemia in conditions of dispensary observation: problems of evaluation, control and reduction of cardiovascular risk.
- **Golovenkin S.** (Krasnoyarsk), **Nikulina S.** (Krasnoyarsk). Rehabilitation of patients with an acute coronary syndrome in Krasnoyarsk region.
- **Osipova I.** (Barnaul). Many years of experience in preventive counseling in the Altai region.

## AMUR HALL

09.00–10.30

### SYMPOSIUM

#### Hypertrophic cardiomyopathy

Chairpersons: **Komissarova S.** (Belarus), **Krylova N.** (Moscow)

- **Kalmykova O.** (Astrakhan). Phenotype-genotype correlation in ultrasound diagnostics of HCM.
- **Komissarova S.** (Belarus). Clinical phenotype and mutation spectrum in HCM patients with high risk of SCD.
- **Motreva A.** (Astrakhan). The experience of open heart reconstruction of the LVOT in HCM patients.
- **Naydenov R.** (Novosibirsk). Ablation and surgical destruction of the myocardium in HCM.
- **Krylova N.** (Moscow). HCM: variants of outcome.



## YENISEI HALL

09.00–10.30

### SYMPOSIUM

#### Obesity as a global factor in cardiovascular risk

Chairpersons: **Chumakova G.** (Barnaul), **Kuznetsova T.** (Petrozavodsk)

- **Druzhilov M.** (Petrozavodsk). New tools for the stratification of obesity in relation to cardiometabolic risk based on a prospective observational study.
- **Koshelskaya O., Suslova T.** (Tomsk). Visceral obesity and cardiovascular risk: the role of metabolic and immuno-inflammatory factors.
- **Chumakova G., Pokutnev A.** (Barnaul). Clinical features of myocardial infarction depending on the status of obesity.
- **Kuznetsova T.** (Petrozavodsk). Strategies for cardiometabolic risk correction in patients with CVD and obesity in the framework of secondary prevention.

## VOLGA HALL

09.00–10.30

### SYMPOSIUM

#### Rare and difficult cases of diagnosis and treatment of acute coronary syndrome

Chairpersons: **Kosmacheva E.** (Krasnodar), **Erlikh A.** (Moscow), **Zateyshchikov D.** (Moscow)

- **Namitokov A., Kosmacheva E.** (Krasnodar). The place of guidelines with a class of indications IIb and III in the treatment of acute myocardial infarction.
- **Erlikh A.** (Moscow). Cases of treatment of patients with acute coronary syndrome, complicated by bleeding.
- **Kashtalap V., Pecherina T.** (Kemerovo). Clinical case of a patient with ACS, oncological disease and pulmonary embolism.
- **Averkova A.O., Brazhnik V., Minushkina L., Rogozhina A., Zateyshchikov D.** (Moscow). Multiple coronary fistulas with discharge into the left ventricle as atypical cause of acute myocardial ischemia.
- **Lepshokova M., Kosmacheva E.** (Krasnodar). Spontaneous dissection of the coronary artery.

## DVINA HALL

09.00–10.30

### SYMPOSIUM

#### Age peculiarities in the therapy of cardiovascular diseases in clinical practice

Chairpersons: **Voevoda M.** (Novosibirsk), **Chesnikova A.** (Rostov-on-Don), **Skibitskiy V.** (Krasnodar)

- **Maximov V., Voevoda M.** (Novosibirsk). How do molecular markers of age and cardiovascular risk factors connect?
- **Chesnikova A.** (Rostov-on-Don). An elderly patient with cardiovascular disease: follow the guidelines or minimize the therapy?
- **Skibitskiy V.** (Krasnodar). Heart failure elderly patients: the difficulties of pharmacotherapy in conditions of polymorbidity.
- **Nechaeva G.** (Omsk), **Martynov A.** (Moscow). Connective tissue dysplasia: general conditions.
- **Garganeeva A., Kuzeleva E., Tukish O., Okrugin S.** (Tomsk). Myocardial infarction in elderly patients: portrait of patient trend in 30 years by population register data.

## ANGARA HALL

09.00–10.30

### SYMPOSIUM

#### Mitral valve prolapse: features of diagnostics, clinical picture and management

Chairpersons: **Zemtsovsky E.** (Saint-Petersburg), **Malev E.** (Saint-Petersburg)

- **Malev E.** (Saint-Petersburg). Mitral valve prolapse: diagnostics and management.
- **Reeva S.** (Saint-Petersburg). Mitral valve prolapse and anomalies of the coronary arteries.
- **Timofeev E.** (Saint-Petersburg). Predictors of arrhythmias in patients with mitral valve prolapse.
- **Zemtsovsky E.** (Saint-Petersburg). Mitral valve prolapse and sport.

## LADOGA HALL

09.00–10.30

### RUSSIAN-SERBIAN JOINT SYMPOSIUM (with the Cardiology Society of Serbia) Management of patient with high cardiovascular risk

*Simultaneous translation*

**Chairpersons:** **Djorjevic-Dikic A.** (Serbia), **Beleslin B.** (Serbia), **Galyavich A.** (Kazan), **Nedoshivin A.** (Saint-Petersburg)

- **Beleslin B.** (Serbia). FFR and CFR: Competitive for diagnosis, but complementary for prognosis.
- **Galyavich A.** (Kazan). Angina after MI.
- **Stojkovic S.** (Serbia). Contemporary indications for percutaneous revascularization of coronary chronic total occlusions.
- **Mikhin V.** (Kursk). Prevention of fatal complications in patients with high cardiovascular risk. Our opportunities and perspectives.

## PLENARY HALL

11.00–12.30

### SATELLITE SYMPOSIUM Acute coronary syndrome: achievements and perspectives (supported by Sanofi, CME points are not accrued)

*On-line broadcasting / Simultaneous translation*

**Chairpersons:** **Shpektor A.** (Moscow), **Akchurin R.** (Moscow)

- **Vasilyeva E.** (Moscow). Update on the pathogenesis and diagnosis of acute coronary syndrome.
- **Shpektor A.** (Moscow). Acute myocardial infarction: old problems, new goals.
- **Skrypnyk D.** (Moscow). Endovascular interventions as a basis for treatment of acute coronary syndrome.
- **Akchurin R.** (Moscow). The role of urgent surgery in the treatment of acute myocardial infarction and its complications.

## CONGRESS HALL №2

11.00–12.30

### SYMPOSIUM Modern aspects of diagnostics, predicting the course and treatment of hypertrophic cardiomyopathy

**Chairpersons:** **Kaplunova V.** (Moscow), **Mravyan S.** (Moscow), **Belenkov Y.** (Moscow)

- **Kaplunova V.** (Moscow). The role of neurohumoral markers in the formation of the course of hypertrophic cardiomyopathy.
- **Shakaryants G.** (Moscow). Current approaches in predicting the types of the course of hypertrophic cardiomyopathy.
- **Kovalevskaya E.** (Moscow). Factors associated with the development of coronary heart disease in patients with hypertrophic cardiomyopathy.
- **Demkina A.** (Moscow). Chronic heart failure in hypertrophic cardiomyopathy.
- **Mravyan S.** (Moscow). Hypertrophic cardiomyopathy in pregnant women: a snake in the grass.

## AMPHITHEATER HALL

11.00–12.30

### SATELLITE SYMPOSIUM Comorbid patient with atrial fibrillation — the opinion of five experts. How to find a single solution? (supported by Bayer, CME points are not accrued)

*On-line broadcasting*

**Chairperson:** **Arutyunov G.** (Moscow)

- **Arutyunov G.** (Moscow). Physician's view: a multidisciplinary approach to the treatment of comorbid patients with atrial fibrillation.
- **Fomin I.** (Nizhny Novgorod). The view of the cardiologist: atrial fibrillation and associated cardiovascular disease. What do you need to know?
- **Kucherenko S.** (Saint-Petersburg). Neurologist's view: the effectiveness and safety of Direct Oral Anticoagulants therapy for secondary stroke prevention: to whom, when and what to prescribe?

- **Sheptulin A.** (Moscow). Gastroenterologist's view: how to identify and reduce the risk of gastrointestinal bleeding and in a patient with AF?
- **Esayan A.** (Saint-Petersburg). Nephrologist's view: comorbid patient with AF and chronic kidney disease: is there a difference between Direct Oral Anticoagulants?

## PRESS HALL

11.00–12.30

### SCIENTIFIC SESSION

#### Registries as an important tool of value-based medicine

**Chairpersons:** **Shlyakhto E.** (Saint-Petersburg), **Barbarash O.** (Kemerovo), **Duplyakov D.** (Samara)

- **Duplyakov D.** (Samara), **Ratova L.** (Saint-Petersburg). Russian Centers Participation in the Eurobservational Research Programme.
- **Erlikh A.** (Moscow). Registries in clinical research — goals and features.
- **Tkacheva O., Kotovskaya Y.** (Moscow). Russian registry ACS in patients of 80 years and older. Design and first results.
- **Berns S.** (Moscow). Design of RusSlan REgistry of pulmoNary embolism "SIRENA".

## URAL HALL

11.00–12.30

### SCIENTIFIC SESSION

#### Resistant hypertension: opportunities of invasive treatment

**Chairpersons:** **Konradi A.** (Saint-Petersburg), **Gapon L.** (Tyumen), **Falkovskaya A.** (Tomsk), **Shugushev Z.** (Moscow)

- **Shugushev Z., Ryumina A., Maksimkin D., Chepurnoy A., Safonova O.** (Moscow). Renal sympathetic denervation: 12-month results of treatment of patients with resistant hypertension.
- **Ripp T., Mordovin V., Pekarsky S., Ryabova T., Baev A., Falkovskaya A., Lichikaki V., Sitkova E., Zyubanov I.** (Tomsk). A double-blind randomized comparative study on cardioprotective effect of two types of renal denervation.

- **Falkovskaya A., Mordovin V., Pekarsky S., Baev A., Ripp T., Lichikaki V., Sitkova E., Zyubanov I., Gusakova A., Manukyan M.** (Tomsk). Refractory and resistant hypertension in patients with type 2 diabetes: different metabolic profile, different response to renal denervation.
- **Ionov M., Mironova S., Yudina Yu., Avdonina N., Emelyanov I., Zverev D., Zvartau N., Konradi A.** (Saint-Petersburg). Renal sympathetic denervation in patients with resistant hypertension: long-term effects for central and peripheral hemodynamic indications.
- **Bratilova E., Kachnov V., Tyrenko V., Sunopalnikov D., Koltsov A., Rudchenko I.** (Saint-Petersburg). Treatment of resistant hypertension with one-side renal sympathetic denervation in patient with one kidney.

## BAIKAL HALL

11.00-12.30

### CONFERENCE

#### Engagement of specialists of allied professions to writing, review and publishing of articles in the Russian Journal of Cardiology. Discussion and search for solutions.

## AMUR HALL

11.00–12.30

### SYMPOSIUM

#### Metabolic disorders and coronary atherosclerosis

**Chairpersons:** **Ragino Yu.** (Novosibirsk), **Voevoda M.** (Novosibirsk)

- **Shakhtshneider E., Ivanoschuk D., Ragino Y., Voevoda M.** (Novosibirsk). Molecular-genetic aspects of metabolic disorders in coronary atherosclerosis.
- **Denisova D., Kuntsevich A., Berezovikova I., Batluk T.** (Novosibirsk). Paradox nutrition associations and certain risk factors for atherosclerosis in young population.
- **Kovalkova N., Ragino Yu., Hudjakova A., Voevoda M.** (Novosibirsk). Metabolic syndrome and kidney dysfunction. Uneasy relationships.
- **Mustafina S.** (Novosibirsk). Features of coronary atherosclerosis in diabetes mellitus.

- **Romanova A., Voevoda M.** (Novosibirsk). Metabolic syndrome and coronary atherosclerosis in Yakutia.
- **Kashtanova E., Ragino Yu.** (Novosibirsk). Metabolic markers of coronary atherosclerosis in Siberia.

## YENISEI HALL

11.00–12.30

### SATELLITE SYMPOSIUM

#### Is there any news for chronic heart failure treatment in the latest guidelines?

(supported by Akrikhin, CME points are not accrued)

##### Chairpersons:

**Kobalava Zh.** (Moscow), **Ageev F.** (Moscow), **Mareev V.** (Moscow)

- **Kobalava Zh.** (Moscow). Mineralocorticoid receptors antagonists in chronic heart failure patient's treatment: modern view on the old problem.
- **Ageev F.** (Moscow). A problem of therapy choice in patients with HFpEF left ventricular.
- **Mareev V.** (Moscow). Diuretics in chronic heart failure treatment: difficulties and mistakes.

## VOLGA HALL

11.00–12.30

### SYMPOSIUM

#### Interactive quiz on cardiovascular imaging — Jeopardy!

- **Matskeplishvili S.** (Moscow)

## DVINA HALL

11.00–12.30

### SYMPOSIUM

#### Correlation between obesity and cardiovascular disease — what's new?

Chairpersons: **Drapkina O.** (Moscow), **Samorodskaya I.** (Moscow)

- **Drapkina O.** (Moscow). The paradox of obesity in cardiovascular diseases: is it a myth or a reality today?
- **Gilyarevskiy S.** (Moscow). "Cardiological" consequences of body mass variability.
- **Samorodskaya I., Starinskaya M.** (Moscow). Opportunities, problems and results of correction of eating disorders in cardiovascular diseases and obesity.
- **Chumakova G.** (Barnaul). Risks and peculiarities of preparation of patients with cardiovascular diseases and obesity to cardiosurgical operations.
- **Druzhilov M.** (Petrozavodsk). Ectopic visceral obesity as an independent factor of cardiovascular risk.

## ANGARA HALL

11.00–12.30

### SYMPOSIUM

#### Connective tissue dysplasia in cardiology

Chairpersons: **Zemtsovsky E.** (Saint-Petersburg), **Zaklyazminskaya E.** (Moscow), **Tarasov D.** (Astrakhan)

- **Zemtsovsky E.** (Saint-Petersburg). Arrhythmias in hereditary disorders of connective tissue.
- **Zaklyazminskaya E.** (Moscow), **Tarasov D.** (Astrakhan). Genetics of atrio-ventricular valves dysplasia.
- **Martyanova J.** (Astrakhan). Causes of the mitral insufficiency and results of the surgical correction.
- **Rumyantseva V.** (Moscow). Prognostic significance of the genetic findings in TAA.
- **Charchyan E.** (Moscow). Surgical treatment of the thoracic aneurisms.

## LADOGA HALL

11.00–12.30

### SYMPOSIUM

**Why is there a high level of cardiovascular mortality in Russia? Comparative studies of CVD phenotypes, risk factors and treatment**

*Simultaneous translation*

**Chairpersons:** **Boytsov S.** (Moscow), **Shalnova S.** (Moscow)

- **Shkolnikov V.** (Germany), **Leon D.** (United Kingdom), **Timonin S.** (Moscow), **Churilova E.** (Moscow). Smoking in Russia: is there any good news?
- **Leon D.** (United Kingdom), **Malyutina S.** (Novosibirsk), **Kudryavtsev A.** (Arkhangelsk), **Hopstok L.** (Norway), **Voevoda M.** (Novosibirsk), **Cook S.** (United Kingdom), **Averina M.** (Novosibirsk). Hypertension and lipid profiles in Russia compared to Norway today 2016-17.
- **Malyutina S.** (Novosibirsk), **Schirmer H.** (Norway), **Ryabikov A.** (Novosibirsk), **Stylidis M.** (Norway). Comparative analysis of Echocardiographic findings in Russian and Norwegian population samples.
- **Schirmer H.** (Norway), **Shapkina M.** (Novosibirsk), **Kholmatova K.** (Arkhangelsk), **Cook S.** (United Kingdom). ECG abnormalities and silent MIs in Russia and Norway.
- **Kontsevaya A.** (Moscow), **Bates K.** (United Kingdom), **McKee M.** (United Kingdom), **Bobrova N.** (United Kingdom). Adequacy and characteristics of treatment 1 year after MI in Russia.
- **McKee M.** (United Kingdom), **Kontsevaya A.** (Moscow), **Bates K.** (United Kingdom), **Vlassov V.** (Moscow), **Shishkin S.** (Moscow), **Kuhlmann E.** (Germany). Ensuring quality of care in Russian hospitals in international perspective.

## PLENARY HALL

12.40–13.20

### PLENARY LECTURE

*On-line broadcasting / Simultaneous translation*

**Moderator:** **Lopatin Y.** (Volgograd)

- **Kuanyshbekova R.T., Dzhunusbekova G.A.** (Kazakhstan). Implementation of control programme on hypertension, CHF and diabetes mellitus in the Republic of Kazakhstan.

## PLENARY HALL

13.30–15.00

### PLENARY SESSION

**Molecular and cell aspects of cardiovascular diseases**

*On-line broadcasting / Simultaneous translation*

**Chairpersons:** **Zateyshchikov D.** (Moscow), **Voevoda M.** (Novosibirsk)

- **Parfenova E.** (Moscow). Prospects of myocardial regeneration.
- **Ragino Y.** (Novosibirsk). Pathophysiological factors of development of vulnerable plaque: basic and translational aspects.
- **Galagudza M.** (Saint-Petersburg). Myocardial protection from ischemia/reperfusion injury: results and prospects.
- **Montserrat L.** (Испания). Genetic testing: prognostic value in inherited cardiovascular disease.
- **Belostotskaya G.** (Saint-Petersburg). Endogenous regenerative potential of myocardium: hopes, disappointments and continuing search.

## CONGRESS HALL №2

13.30–15.00

### SYMPOSIUM

**POLYPILL: from solving specific problems to differentiated application**

**Chairpersons:**

**Nedoshivin A.** (Saint-Petersburg), **Arutyunov G.** (Moscow)

- **Nedoshivin A.** (Saint-Petersburg). The role of polypill in primary and secondary prevention of cardiovascular diseases.
- **Arutyunov G.** (Moscow). Polypill and adherence to treatment.
- **Lopatin Y.** (Volgograd). The role of polypill in the treatment of hypertension and coronary artery disease.
- **Nedogoda S.** (Volgograd). Algorithm of differentiated application of polypill.



## AMPHITHEATER HALL

13.30–15.00

### SYMPOSIUM

**Joint scientific symposium of the Russian Society of Cardiology and the National society for preventive cardiology. National guidelines on Cardiovascular prevention 2017**

**Chairpersons:**

**Oganov R.** (Moscow), **Pogosova N.** (Moscow), **Boytsov S.** (Moscow)

- **Oganov R.** (Moscow). Cardiovascular prevention: Population and individual strategies.
- **Pogosova N.** (Moscow). National guidelines on Cardiovascular Prevention 2017: What's new and most important.
- **Boytsov S.** (Moscow). Secondary prevention of cardiovascular diseases and its role in reducing cardiovascular mortality.

## PRESS HALL

13.30–15.00

### SATELLITE SYMPOSIUM

**New algorithms for cardiovascular risks reduction in diabetic patients: from safety concept to proven efficacy of therapy**

(supported by NovoNordisk, CME points are not accrued)

**Chairpersons:** **Karpov Yu.** (Moscow), **Shestakova M.** (Moscow)

- **Karpov Yu.** (Moscow). Opening.
- **Ezhov M.** (Moscow). Cardiovascular disease and type 2 diabetes mellitus as strong comorbidities.
- **Konradi A.** (Saint-Petersburg). Antidiabetic therapy: from cardiovascular safety to cardiovascular effectiveness.
- **Discussion:** how to overcome the inertia of a cardiologist in the prescription of modern antidiabetic drugs.

## URAL HALL

13.30–15.00

### SCIENTIFIC SESSION

**Management of patients with non-coronary pathology**

**Chairpersons:**

**Pavlyukova E.H.** (Tomsk), **Moiseeva O.** (Saint-Petersburg)

- **Barsovsky M.** (United Kingdom). What cardiologist and emergency physician need to know about acute thrombocytopenia.
- **Kachkovskiy M., Chernikova V., Poverennova I.** (Samara). Cardiovascular symptoms of cardiomyopathy in dystrophic myotonia.
- **Chernyavsky A.<sup>1</sup>, Novikova N.<sup>1</sup>, Edemskiy A.<sup>1</sup>, Romanov A.<sup>1</sup>, Grankin D.<sup>1</sup>, Rudenko B.<sup>2</sup>** (Novosibirsk<sup>1</sup>, Moscow<sup>2</sup>). Pulmonary artery RFA — an alternative method of treatment of residual pulmonary hypertension after pulmonary endarterectomy surgery.
- **Demetskaya V., Stempel D., Matieva T., Chernov I., Kozmin D., Kondratiev D., Nechepurenko A., Tarasov D.** (Astrakhan). Endocarditis after surgery, short-term and long-term results of complex treatment. Triumph or defeat?
- **Maznev D., Shloydo E.** (Saint-Petersburg). Takotsubo cardiomyopathy in cardiologist's practice — long-term monitoring.
- **Irtuga O., Zhiduleva E., Murtazalieva P., Sibagatullina Yu., Solntsev V., Shishkova A., Malashicheva A., Moiseeva O.** (Saint-Petersburg). Possible role of biomarkers of bone metabolism in aortal stenosis.

## BAIKAL HALL

13.30-15.00

**SESSION OF THE EDITORIAL BOARD OF THE RUSSIAN JOURNAL OF CARDIOLOGY**

**Chairperson:** **Shlyakhto E.V.** (Saint-Petersburg)



## AMUR HALL

13.30–15.00

### SYMPOSIUM

#### Rare disease or rare diagnosis?

**Chairpersons:** **Gilyarevskiy S.** (Moscow),  
**Boldueva S.** (Saint-Petersburg), **Kuznetsova T.** (Petrozavodsk)

- **Gilyarevskiy S.** (Moscow). Evolution of understanding of long-term clinical consequences of Takotsubo syndrome.
- **Boldueva S.** (Saint-Petersburg). To the question by pathogenetic mechanisms of Takotsubo syndrome.
- **Kuznetsova T.** (Petrozavodsk). Stress-induced cardiomyopathy: current positions in the structure of patients with clinic of acute coronary syndrome.
- **Feoktistova V., Yarmosh I., Boldueva S.** (Saint-Petersburg). Primary and secondary types of Takotsubo cardiomyopathy: case reports.

## YENISEI HALL

13.30–15.00

### SATELLITE SYMPOSIUM

#### Modern approaches to management CHF patients, who need high-tech methods of treatment

(supported by Novartis Pharma, CME points are not accrued)

**Chairperson:** **Shevchenko A.** (Moscow)

- **Shevchenko A.** (Moscow). Indication for heart transplantation. Current potentials of pharmacotherapy.
- **Fedotov P.** (Saint-Petersburg). New scheme of immunosuppression after heart transplantation. Era of organoprotection.
- **Simonenko M.** (Saint-Petersburg). Arrhythmic status of the patient with CHF before and after heart transplantation.
- **Lebedev D.** (Saint-Petersburg). Electrotherapy of cardiac arrhythmias and sudden cardiac death in patients with CHF.
- **Discussion.**

## VOLGA HALL

13.30–15.00

### SYMPOSIUM

#### Missed opportunities in CV risk reduction

**Chairperson:** **Fomin I.** (Nizhny Novgorod)

- **Begrambekova Yu.** (Moscow). Physical activity is a necessary component of the prevention and treatment of cardiovascular diseases.
- **Strazhesko I.** (Moscow). The best diets for reducing cardiovascular risk.
- **Kalinkin A.** (Moscow). When does sleep become an aggressive medium for the cardiovascular system? Cardioprotective properties of healthy sleep.
- **Orlova Ya.** (Moscow). Geroprotectors: the eternal dream and modern possibilities.

## DVINA HALL

13.30–15.00

### SYMPOSIUM

#### A patient-oriented approach to revascularization: acute phase and secondary prevention

**Chairpersons:** **Sarkis E.** (France), **Gavrilova N.** (Moscow)

- **Kontsevaya A.** (Moscow). Which factors affect the decision making about revascularization in patients with myocardial infarction in the Russian Federation?
- **Sarkis E.** (France). Critical coronary artery stenosis: what is the optimal treatment strategy?
- **Duplyakov D.** (Samara). Acute coronary syndrome combined with atrial fibrillation. How justified is the modern approach?
- **Gavrilova N.** (Moscow). What are the features of secondary prevention in patients who underwent revascularization?

## ANGARA HALL

13.30–15.00

### SYMPOSIUM

**Key hot issues of cardiorenal medicine.  
In the memory of V.S. Moiseev and N.A. Mukhin**

**Chairpersons: Moiseev S.** (Moscow), **Kobalava Zh.** (Moscow)

- **Moiseev S.** (Moscow). Nephroprotection: from mechanisms to outcomes.
- **Villevaude S.** (Moscow). Uric acid, arterial hypertension and chronic kidney disease.
- **Milovanova L.** (Moscow). Morphogenetic proteins — sKlotho, FGF-23 — new markers of cardiorenal interactions in cardiovascular risk assessment in CKD patients.
- **Kobalava Zh.** (Moscow). Atrial fibrillation and chronic kidney disease as components of the cardiorenal continuum.

## LADOGA HALL

13.30–15.00

### SYMPOSIUM

**Current issues of emergency cardiology: acute coronary syndrome in patients with non-obstructive changes of the coronary arteries**

*Simultaneous translation*

**Chairpersons: Ryabov V.** (Tomsk), **Barbarash O.** (Kemerovo), **Karpov R.** (Tomsk)

- **Di Somma S.** (Italy). The role of the troponins in the diagnosis of the MINOCA.
- **Ryabov V.** (Tomsk). Current issues of acute coronary syndrome in patients with non-obstructive lesion of the coronary arteries.
- **Barbarash O.** (Kemerovo), **Kashtalap V.** (Kemerovo). Early and long-term outcomes of acute coronary syndrome with non-obstructive changes in the coronary arteries. Data from the RECORD-3 register.

- **Zaklyazminskaya E.** (Moscow), **Румянцева В.А.** (Moscow). Hereditary thrombophilia: what to watch and how to interpret.
- **Stukalova O.** (Moscow). MRI of the heart in the differential diagnosis of acute coronary syndrome with non — obstructive lesion of the coronary arteries.
- **Vyshlov E.** (Tomsk). Current issues medical treatment in patients with acute coronary syndrome depending on the lesion of the coronary arteries.

## PLENARY HALL

15.30–17.00

### PLENARY SESSION

**CAD, atherosclerosis, lipids**

*On-line broadcasting / Simultaneous translation*

**Chairpersons: Catapano A.** (Italy), **Karpov Yu.** (Moscow), **Kukharchuk V.** (Moscow), **Oganov R.** (Moscow)

- **Catapano A.** (Italy). Hypolipidaemic therapy: present and future.
- **Shaposhnik I.** (Chelyabinsk). Atherosclerotic peripheral artery disease in CAD.
- **Ezhov M.** (Moscow). CAD and non-coronary atherosclerosis — the role of Lp(a).
- **Pokrovskiy S.** (Moscow). Therapeutic apheresis for correction of refractory dyslipidemia.

## CONGRESS HALL №2

15.30–17.00

### SCIENTIFIC AND PRACTICAL CONFERENCE

**Sectoral qualifications framework in health care**

**Chairperson: Roshal L.** (Moscow), **Shlyakhto E.** (Saint-Petersburg)

- **Shlyakhto E.** (Saint-Petersburg). Role of sectoral qualifications framework in regulation of labour market in health care.
- **Parmon E.** (Saint-Petersburg). Organization and carrying out monitoring of the labour market in health care.

- **Ushanov Yu.** (Moscow). Experience of creating of sectoral system and qualifications framework in other sectors.
- **Sirotkina O.** (Saint-Petersburg). Main results of the grant events.
- **Samoylenko V.** (Saint-Petersburg). Features of supplying health care with mid-level specialists.
- **Ischuk T.** (Saint-Petersburg). Sectoral qualifications framework or what is next.

## AMPHITHEATER HALL

15.30–17.00

### SYMPOSIUM

#### Pharmacological cardioversion of persistent atrial fibrillation: real opportunities

Chairpersons: **Sokolov S.** (Moscow), **Golitsyn S.** (Moscow)

- **Mironov N., Yuricheva Y., Vlodyanovskiy V., Sokolov S., Maykov E., Golitsyn S., Rosenstraukh L., Chazov E.** (Moscow). Efficacy of the new III class Russian antiarrhythmic drug in persistent atrial fibrillation in the real clinical practice.
- **Sokolov S., Mironov N., Yuricheva Y., Vlodyanovskiy V., Maykov E., Golitsyn S., Rosenstraukh L., Chazov E.** (Moscow). Negative effects of the new III class Russian antiarrhythmic drug in pharmacological cardioversion of persistent atrial fibrillation.
- **Vlodyanovskiy V., Mironov N., Yuricheva Y., Sokolov S., Saidova M., Golitsyn S., Rosenstraukh L., Chazov E.** (Moscow). Comparison of electrical cardioversion and pharmacological conversion with refralon: first results of randomized trial in patients with persistent atrial fibrillation.

## PRESS HALL

15.30–17.00

### SYMPOSIUM

#### Patient with type 2 diabetes on a visit to a cardiologist

Chairpersons: **Lopatin Y.** (Volgograd), **Nedogoda S.** (Volgograd)

- **Arutyunov G.** (Moscow). Therapist's view.
- **Lopatin Y.** (Volgograd). The cardiologist's view.
- **Nedogoda S.** (Volgograd). The view of an endocrinologist and clinical pharmacologist.

## URAL HALL

15.30–17.00

### SCIENTIFIC SESSION

#### Cardiovascular surgery

Chairpersons: **Gordeev M.** (Saint-Petersburg), **Shumakov D.** (Moscow)

- **Bokeria L., Bokeria O., Yurkulieva G.** (Moscow). Efficacy assessment of surgical treatment in comparison to RFA of pulmonary arteries in AF patients.
- **Kuznetsov D., Gevorgyan A., Mikhailov K., Novokshenov V., Kryukov A., Khokhlunov S.** (Samara). Comparative assessment of the results of bypass surgery with 1 and 2 internal thoracic arteries in AF patients.
- **Mamaeva O., Pavlova N., Podlesov A., Lebedeva S., Sarana A., Scherbak S.** (Saint-Petersburg). Results of the dynamic monitoring of patients in long-term period after valvular surgeries.
- **Abdulgasanov R., Bokeria L., Arakelyan V., Abdulgasanova M., Provotorova Yu., Gasymov E., Magomediyayev M., Ivanov A.** (Moscow). Results of the surgical treatment of the neck paraganglioma.
- **Bokeria L., Bokeria O., Meladze M., Dzhandzhgava D.** (Moscow). Long-term results of the single-stage surgical correction of acquired disease and arrhythmia.
- **Gadzhieva A., Bokeria O.** (Moscow). Assessment of the long-term results of chronic coronary occlusion treatment.

## BAIKAL HALL

15.30–17.00

### SESSION OF THE COUNCIL OF CARDIOLOGY JOURNALS

## AMUR HALL

15.30–17.00

### SYMPOSIUM

#### Pulmonary embolism — 2018

Chairpersons: **Yavelov I.** (Moscow), **Panchenko E.** (Moscow)

- **Yavelov I.** (Moscow). New approaches to prevention of pulmonary embolism in nonsurgical patients.
- **Panchenko E.** (Moscow). Early treatment of pulmonary embolism: is it possible to improve the prognosis?
- **Komarov A.** (Moscow). Prevention of recurrent pulmonary embolism: how to provide individual approach.

## YENISEI HALL

15.30–17.00

### SYMPOSIUM

#### Pericarditis and myocarditis: new in diagnosis and treatment

Chairpersons: **Blagova O.** (Moscow), **Moiseeva O.** (Saint-Petersburg), **Paleev P.** (Moscow)

- **Blagova O.** (Moscow). Pericarditis in modern therapeutic clinic: nosological spectrum, approaches to diagnosis and treatment.
- **Titov V., Moiseeva O., Runov A., Vonsky M., Ryzhkova D.** (Saint-Petersburg). Predictors of the development and progression of inflammatory diseases of the myocardium.
- **Paleev P.** (Moscow). Modern possibilities of myocarditis treatment.
- **Kulikova V., Nedostup A., Blagova O., Nechaev I., Ragimov A.** (Moscow). Therapeutic efficacy of plasmapheresis in patients with various clinical forms of myocarditis.

## VOLGA HALL

15.30–17.00

### SYMPOSIUM

#### Genetic aspects of arrhythmias

Chairpersons: **Chernova A.** (Krasnoyarsk), **Sonicheva N.** (Moscow)

- **Nikulina S., Chernova A., Tadtaeva K.** (Krasnoyarsk). Evaluation of the effectiveness of RFA in patients with AF depending on the individual characteristics of the genotype. First experience.
- **Kuskaeva A., Nikulina S., Chernova A., Zotina E., Shturenkova Y.** (Krasnoyarsk). Clinical experience of a personified approach to the management of AF patients based on the features of polymorphisms of the RAAS genes.
- **Sonicheva N.** (Moscow). Sudden death, as the first symptom of the disease. Usefulness of genetics.
- **Lebedeva I., Nikulina S., Chernova A.** (Krasnoyarsk). Clinical and genetic analysis of Wolf-Parkinson-Whyte syndrome.

## DVINA HALL

15.30–17.00

### SYMPOSIUM

#### Fundamental and applied aspects of antiplatelet therapy in coronary heart disease. Is there any reason for discussion?

Chairpersons: **Grinshtein Y.** (Krasnoyarsk), **Zateyshchikov D.** (Moscow)

- **Grinshtein Y., Kosinova A.** (Krasnoyarsk). Antiplatelet drugs resistance. Myth or reality?
- **Lomakin N., Zateyshchikov D.** (Moscow). Estimation of platelets functional activity: to be or not to be?
- **Boldueva S.** (Saint-Petersburg). News and perspectives of antiplatelet therapy in ACS.
- **Barbarash O., Kashtalov V.** (Kemerovo). Patients adherence to dual antiplatelet therapy at different stages of treatment of acute coronary syndrome data from RECORD-3 registers and single-site study in Kemerovo.
- **Lifshits G.** (Novosibirsk). Antiplatelet therapy in acute coronary syndrome in the Siberian population: the impact of poorly studied genetic markers.
- **Kosinova A., Grinshtein I.** (Krasnoyarsk). Features of platelets metabolic activity on clopidogrel therapy.

## ANGARA HALL

15.30–17.00

### SYMPOSIUM

#### Arrhythmias in real clinical practice

**Chairperson: Baranova E.** (Saint-Petersburg)

- **Pagaeva F.** (Vladikavkaz). Registry of patients with atrial fibrillation in North Ossetia-Alania: sketches to portrait.
- **Ionin V.** (Saint-Petersburg). Atrial fibrillation in patients with metabolic syndrome: predictors and approaches to therapy.
- **Tuaeva I.** (Vladikavkaz). Organization of medical care for patients with rhythm disturbances: from clinical recommendations to real clinical practice.
- **Toguzova Z.** (Vladikavkaz). Cardiotoxicity in cancer patients: the possibilities of solving the problem.

## LADOGA HALL

15.30–17.00

### SYMPOSIUM

#### Heart, vessels and ageing. Longitudinal international project HAPIEE: Russian findings

*Simultaneous translation*

**Chairpersons: Bobak M.** (United Kingdom),  
**Holmes M.** (United Kingdom), **Voevoda M.** (Novosibirsk)

- **Malyutina S.K.** (Novosibirsk). Overview of project design and interim findings on cardiovascular health in ageing in Russian population cohort.
- **Bobak M.** (United Kingdom). Association between cognitive function and cardiovascular mortality in older people.
- **Stefler D.** (United Kingdom). Longitudinal trajectories of blood pressure in an ageing population sample in Russia.
- **Holmes M.<sup>1</sup>, Stefler D.<sup>1</sup>, Maximov V.<sup>2</sup>, Malyutina S.<sup>2</sup>** (United Kingdom<sup>1</sup>, Novosibirsk<sup>2</sup>). Leucocyte telomeres length and CVD mortality in Russian population cohort.
- **Ryabikov A.** (Novosibirsk). What are relationships between vascular wall alterations and molecular markers of age in ageing: long term follow-up?

## PLENARY HALL

17.30–19.00

### PLENARY SESSION

#### Aortic surgery: yesterday, today, tomorrow

*On-line broadcasting / Simultaneous translation*

**Chairpersons: Gordeev M.** (Saint-Petersburg),  
**Charchyan E.** (Moscow), **Kozlov B.** (Tomsk), **Imaev T.** (Moscow)

- **Gordeev M.** (Saint-Petersburg). Surgical treatment of ascending aorta and aortic root.
- **Kozlov B.** (Tomsk). Hybrid surgical treatment of thoracic aortic dissection.
- **Charchyan E.** (Moscow). Limited incisions in aortic surgery.
- **Imaev T.** (Moscow). Treatment of suprarenal and thoraco-abdominal aortic aneurysms.
- **Chernyavskiy M.** (Saint-Petersburg). Hybrid surgery of aortic arch.
- **Discussion.**

## CONGRESS HALL №2

17.30–19.00

### SYMPOSIUM

#### Non-compact left ventricular myocardium: analysis of data from leading Russian registries 2018

**Chairpersons: Zaklyazminskaya E.** (Moscow), **Blagova O.** (Moscow)

- **Polyak M., Zaklyazminskaya E.** (Moscow). Features of the spectrum of mutations in the syndrome of non-compact left ventricular myocardium forms and their progression.
- **Pavlenko E., Blagova O., Nedostup A., Sedov V.** (Moscow). The registry of adult patients with the left ventricular no compaction syndrome: classification of clinical forms and their progression.
- **Blagova O.** (Moscow). Myocarditis as a regular phenomenon in patients with primary non-compact myocardium: diagnosis, treatment, and effects on outcomes.



- **Varionchik N.** (Moscow). Life-threatening complications (arrhythmias, embolisms, infarcts) in the syndrome of non-compact myocardium in adults: risk stratification and approaches to treatment.
- **Myasnikov R., Kulikova O., Meshkov A., Kharlap M., Boytsov S.** (Moscow). Non-compact myocardium of the left ventricle: morphological and genetic predictors of an unfavorable outcome.

## AMPHITHEATER HALL

17.30–19.00

### SYMPOSIUM

**The first experience of application of new diagnostic and therapeutic methods in patients with stable CAD in the Russian Federation**

**Chairpersons:** Soboleva G. (Moscow), Karpov Y. (Moscow), Panov A. (Saint-Petersburg)

- **Soboleva G., Gaman S., Karpov Y., Sharia M., Ternovoy S.** (Moscow). The importance of ATP-dependent potassium channels in vascular tone regulation and their implementation in modern methods of visualization of myocardial ischemia.
- **Panov A.** (Saint-Petersburg). Antianginal therapy: new opportunities for improving the quality of life of patients with stable angina.
- **Gostishev R., Soboleva G., Samko A.** (Moscow). Pharmacological preconditioning with nicorandil as a method of preventing perioperative damage to the myocardium during percutaneous coronary interventions with stenting of the coronary arteries in patients with stable angina.

## PRESS HALL

17.30–19.00

### SYMPOSIUM

**CRT: current indications and follow-up**

**Chairpersons:** Lyubimtseva T. (Saint-Petersburg), Gupalo E. (Moscow), Lebedev D. (Saint-Petersburg), Rzaev F. (Moscow)

- **Vander M.** (Saint-Petersburg). CRT. How it works.
- **Lyubimtseva T.** (Saint-Petersburg). Indications for CRT 2018: how we came to do it.
- **Lebedev D.** (Tomsk). Non-response for CRT Problems and solutions.
- **Gupalo E.** (Moscow). Management of CRT patient: the role of cardiologist.
- **Голев М.В.** (Moscow). Management of CRT patient: the role of electrophysiologist.
- **Mareev Y.** (Moscow). Looking forward.

## URAL HALL

17.30–19.00

### SCIENTIFIC SESSION

**Emergency cardiology**

**Chairpersons:** Skibitskiy V. (Krasnodar), Yakovlev A. (Saint-Petersburg)

- **Sharafeev A.<sup>1</sup>, Alkhazurov A.<sup>2</sup>, Gabdulkhakov E.** (Kazan). Cardioprotective effect of the local hypothermia during primary PCI in patients with STEMI.
- **Ponomarenko I., Sukmanova I.** (Barnaul). Clinico-hemodynamical features of ACS in young women.
- **Tatarintseva Z., Kosmacheva E.** (Krasnodar). Impact of atrial fibrillation on ACS course in real clinical practice based on data of the total ACS registry in Krasnodar region.
- **Pochinka I., Sizov N.** (Nizhny Novgorod). MINOCA: prevalence, clinical features and prognosis.
- **Leksina A., Gnilomedova D., Mullova I., Cherepanova N., Pavlova T., Duplyakov D.** (Samara). Therapy adherence in PATE patients during outpatient stage.
- **Milovanova E., Urvantseva I., Gorkov A., Luzin V.** (Surgut). 10 years of Yugra-kor project: main results.



## BAIKAL HALL

17.30-19.00

### SCIENTIFIC SESSION

#### Cardiovascular diseases in rheumatology

Chairpersons: **Popkova T.** (Moscow), **Novikova D.** (Moscow)

- **Popkova T.** (Moscow). Cardiovascular pathology in chronic inflammatory arthritis: a rheumatologist's view.
- **Novikova D.** (Moscow). Cardiovascular pathology in chronic inflammatory arthritis: a cardiologist's view.
- **Fomicheva O.** (Moscow). Coronary atherosclerosis and rheumatoid arthritis: diagnosis, treatment and prevention.
- **Kirillova I.** (Moscow). A patient with rheumatoid arthritis and dyspnea: what's the problem and what to do?
- **Udachkina E.** (Moscow). Personalized lipid-lowering therapy in patients with chronic inflammatory arthritis.

## AMUR HALL

17.30–19.00

### SYMPOSIUM

#### National guidelines “Diagnostics and treatment of cardiovascular diseases during pregnancy” 2018: review and update

Chairpersons: **Moiseeva O.** (Saint-Petersburg), **Stryuk R.** (Moscow), **Chesnikova A.** (Rostov-on-Don)

- **Irtuga O., Moiseeva O.** (Saint-Petersburg). Management of pulmonary hypertension in the antenatal and postnatal periods.
- **Stryuk R.** (Moscow). Anticoagulation in pregnant women with prosthetic heart valve.
- **Chesnikova A., Kolomatskaya O.** (Rostov-on-Don). Management of cardiac arrhythmias in pregnant women.
- **Chulkov V.** (Chelyabinsk). Diagnostics and treatment of arterial hypertension in pregnant women.

## YENISEI HALL

17.30–19.00

### SYMPOSIUM

#### Ischemic heart disease: from the traditional understanding of the problem to innovation

Chairpersons: **Ezhov M.** (Moscow), **Yakushin S.** (Ryazan), **Babunashvili A.** (Moscow)

- **Ezhov M.** (Moscow). Modern view on atherosclerosis.
- **Filippov E.** (Ryazan). Diagnosis of stable angina: clinical guidelines and actual clinical practice.
- **Yakushin S.** (Ryazan). Top discoveries of drug therapy for chronic CAD.
- **Babunashvili A.** (Moscow). Modern and innovative approaches to revascularization in chronic CAD.

## VOLGA HALL

17.30–19.00

### BATTLE OF SCHOLARS — 2018. FINAL COMPETITION

Jury:

**Drapkina O.** (Moscow), **Drozdova L.** (Moscow), **Kontsevaya A.** (Moscow), **Miller Y.** (Saint-Petersburg), **Nikulina S.** (Krasnoyarsk), **Stovpyuk O.** (Saint-Petersburg), **Tatarskiy R.** (Saint-Petersburg)

Финалисты конкурса:

**CardioDesant** (Krasnodar)  
**5 beats** (Omsk)  
**Cardiolines** (Chelyabinsk)

## DVINA HALL

17.30–19.00

### SYMPOSIUM

#### Modern biomarkers in risk stratification and treatment of patients with cardiovascular diseases and heart failure

Chairpersons: **Skvortsov A.** (Moscow), **Tereshchenko S.** (Moscow)

- **Skvortsov A., Narusov O.** (Moscow). sST2 — novel biomarker of heart failure.
- **Protasov V., Skvortsov A.** (Moscow). Multimarker approach for risk stratification in patients after acute heart failure decompensation.
- **Shlevkov N., Gasparyan A.** (Moscow). Significance of NT-proBNP and sST2 monitoring in patients with ventricular tachyarrhythmia and high risk of sudden death.
- **Gruzdeva O., Dileva J., Barbarash O.** (Kemerovo). Risk stratification of patients with ACS and decreased LV systolic function: is there place for a stimulating growth factor?

## ANGARA HALL

17.30–19.00

### SYMPOSIUM

#### The versatility of cardio-renal relations. A modern view on the problem

Chairpersons: **Govorin A.** (Chita), **Kushnarenko N.** (Chita)

- **Kushnarenko N., Govorin A., Medvedeva T.** (Chita). Cardiorenal continuum in patients with gout.
- **Shulkina S.** (Perm). Features of kidney damage in patients with different phenotypes of obesity.
- **Antipova A.** (Perm). Central aortal pressure as a predictor of renal chronic disease in patients of high risk.
- **Koshelskaya O.A.** (Tomsk). Arterial hypertension, diabetes mellitus and subclinical dysfunction of the kidney: choice of antihypertensive therapy.
- **Kushnarenko N., Govorin A., Mishko M.** (Chita). The long-term effects of Bariatric Surgery: a case report of chronic tofus gout in a patient with morbid obesity after gastric banding.

## LADOGA HALL

17.30–19.00

### SYMPOSIUM

#### Genomics in cardiology: the time for practical solutions

Chairpersons: **Zateyshchikov D.** (Moscow), **Garcia D.** (Spain), **Kostareva A.** (Saint-Petersburg)

- **Zateyshchikov D.** (Moscow). Possible approaches to implementation of genomics in daily cardiology practice.
- **Garcia D.** (Spain). Genetic diagnosis of hereditary cardiovascular diseases: who needs it and how to interpret it?
- **Kuznecova O., Nikulina S., Chernova A., Semenchukov A.** (Krasnoyarsk). Genome-wide analysis of patients with primary cardiomyopathies.
- **Kostareva A.** (Saint-Petersburg). Molecular-genetic mechanisms of arrhythmogenic cardiomyopathy. Modern view on the problem.
- **Sonicheva N.** (Moscow). Dangerous cardiomyopathies: where genetics is needed.

	World Trade Center Moscow, 2 floor					Office building №2, 2 floor					Office building №2, 4 floor
	PLENARY HALL	CONGRESS HALL #2	AMPHITHEATER HALL	PRESS HALL	URAL HALL	AMUR HALL	YENISEI HALL	VOLGA HALL	DVINA HALL	ANGARA HALL	LADOGA HALL
09:00-10:30	Plenary Session Dilated cardiomyopathy: from syndrome to diagnosis  On-line broadcasting / Simultaneous translation	Symposium Clinical guidelines for the treatment of patients with chronic heart failure. What is new?	Symposium Basic principles of maintaining polymorbid patients	Symposium Long-term prognosis after coronary revascularization	Scientific session Fundamental research	Symposium of the National Society of Atherothrombosis Hot issues of antithrombotic therapy in cardiology (in memory of Y.B. Belousov)	Symposium Genetics of multifactorial diseases	Symposium Sudden arrhythmic death in sports	Symposium 50-year history of the national cardiorehabilitation prospects for further development	Symposium Challenges, controversies and unexpected events in management of cardiac arrhythmias: review of clinical cases	Symposium Hot issues of psychocardiology
10.30-11.00 BREAK						10.30-11.00 BREAK					
11.00-12.30	Plenary Session Acute cardiac care — 2018  On-line broadcasting / Simultaneous translation	Symposium Artery denervation: is there future for pulmonary artery management?	Clinical case discussion Rare forms of cardiomyopathies	Symposium Questions and lessons of evidence-based cardiology	Scientific session Imaging in cardiology, ultrasound and tomographic technologies	Symposium 3D session: in details, dynamically, evidential. Difficult and unresolved questions of therapy by statins of the polymorbid CAD patient	Scientific session Heart is the target organ in internal organs diseases	Workshop Hot issues of diagnosis and treatment of family hyperlipidemia	Symposium Modern possibilities in diagnostics of the athlete's heart	Symposium Rare and difficult diagnoses in cardiology	Symposium Multifaceted interactions of diabetes and cardiovascular diseases
12.30-13.00 BREAK						12.30-13.00 BREAK					
13.00-15.00	<b>PLENARY SESSION</b> <b>CHALLENGES AND SOLUTIONS IN CARDIOLOGY. SESSION 2</b> On-line broadcasting / Simultaneous translation					<b>PLENARY SESSION</b> <b>CHALLENGES AND SOLUTIONS IN CARDIOLOGY. SESSION 2</b> On-line broadcasting / Simultaneous translation					

## PLENARY HALL

09.00–10.30

### PLENARY SESSION

#### Dilated cardiomyopathy: from syndrome to diagnosis

*On-line broadcasting / Simultaneous translation*

**Chairpersons:** **Dzemeshkevich S.** (Moscow), **Paleev P.** (Moscow)

- **Dzemeshkevich S.** (Moscow). Organ-preserving surgery of DCM: etiology, efficiency, prognosis.
- **Zaklyazminskaya E.** (Moscow). Genetic methods in diagnostics and treatment of the DCM.
- **Moiseeva O.** (Saint-Petersburg). Systemic approach in diagnostics of the DCM.
- **Sinitsyn V.** (Moscow). Differential diagnostics of the DCM syndrome by imaging methods.

## CONGRESS HALL №2

09.00–10.30

### SYMPOSIUM

#### Clinical guidelines for the treatment of patients with chronic heart failure. What is new?

**Chairperson:** **Belenkov Y.** (Moscow)

- **Ageev F.** (Moscow). Algorithm for the diagnosis of chronic heart failure.
- **Lopatin Y.** (Volgograd). Algorithm for the treatment of chronic heart failure.
- **Mareev Y.** (Moscow). Devices for congestive heart failure treatment.
- **Mareev V.** (Moscow). Congestive heart failure and DM.

## AMPHITHEATER HALL

09.00–10.30

### SYMPOSIUM

#### Basic principles of maintaining polymorbid patients

**Chairpersons:** **Tarlovskaya E.** (Nizhny Novgorod), **Arutyunov G.** (Moscow), **Orlova Y.** (Moscow)

- **Tarlovskaya E.** (Nizhny Novgorod). Current clinical guidelines on management of polymorbid patients.
- **Arutyunov A.** (Moscow). Patient with HFpEF: practical use of the general principles of maintaining polymorbid patients.
- **Arutyunov G.** (Moscow). The strategy of doses prescription of diuretics and oral anticoagulants in patients with combination of cirrhosis and chronic kidney disease.
- **Orlova Y.** (Moscow). Prevention of aging of the polymorbid patient: is there a point? Whether there is a chance?
- **Gordeev I.** (Moscow). Acute coronary syndrome: strategy and tactics of management of the polymorbid patient.

## PRESS HALL

09.00–10.30

### SYMPOSIUM

#### Long-term prognosis after coronary revascularization

**Chairpersons:** **Samko A.** (Moscow), **Shiryaev A.** (Moscow), **Provatorov S.** (Moscow)

- **Provatorov S., Potehina A., Romasov I., Samko A.** (Moscow). Causes and time of repeat revascularization after successful coronary stenting.
- **Arutiunian G., Merkulov E., Samko A., Provatorov S.** (Moscow). Long-term results of left main coronary artery stenting.
- **Potehina A., Filatova A., Schinova A., Osokina A., Arefieva T.** (Moscow). Prognostic significance of inflammatory markers after coronary stenting.
- **Mironov V., Samko A., Merkulov E.** (Moscow). Long-term prognosis after recanalization of chronic coronary occlusions.
- **Shiryaev A., Vasilyev V.** (Moscow). Technical features and long-term results of bypass coronary grafting in diffuse coronary lesions.

## URAL HALL

09.00–10.30

### SCIENTIFIC SESSION

#### Fundamental research

##### Chairpersons:

**Parfenova E.** (Moscow), **Kostareva A.** (Saint-Petersburg)

- **Mukhomedzyanov A.** (Tomsk). Prospects of application of U-50,488, a kappa-opioid receptor agonist, to increase cardiac resistance to reperfusion injury.
- **Zhmailova S., Veber V., Rummyantsev E., Ataev I., Sulimanova D., Gubskaya P.** (Veliky Novgorod). Comparative analysis of remodeling of extracellular media space of thoracic and abdominal aorta in Wistar rats with continuing adrenalin infusion and in long-term period.
- **Minushkina L., Brazhnik V., Selezneva N., Averkova A., Rogozhina A., Zubova A., Karmanchikova E., Speshilov G., Zateyshchikov D.** (Moscow). Polymorphism of tumour necrosis factor gene and features of myocardial structure and function in patients with hypertension.
- **Shakhtshneider E., Ivanoschuk D., Ragino Y., Polonskaya Ya., Chernyavsky A., Voevoda M.** (Novosibirsk). Analysis of transcriptomic profile of stable and non-stable atherosclerotic plaque.
- **Dergilev K., Tsokolaeva Z., Beloglazova I., Zubkova E., Boldyreva M., Parfenova E.** (Moscow). Intramyocardial transplantation of cardiac resident progenitor cells causes epicardial cells activation and neovasculogenesis stimulation in the damage area.
- **Babushkina N., Postrigan A., Kucher A.** (Tomsk). Involvement of MLH1 gene in forming of CAD clinical features.
- **Sinitskiy M., Velikanova E., Shishkova D., Asanov M., Ponasenko A., Kutikhin A.** (Kemerovo). Features of genetic expression of scavenger receptors in endothelial cells of coronary and interthoracic arteries exposed by different types of mineral and organic nanoparticles.

## BAIKAL HALL

09.00-10.30

### EXPERT COUNCIL

**Shestakova M.** (Moscow), **Shlyakhto E.** (Saint-Petersburg), **Boytsov S.** (Moscow), **Karpova I.** (Moscow), **Khalimov Y.** (Saint-Petersburg), **Mkrtyumyan A.** (Moscow), **Kalashnikov V.** (Moscow), **Yakovlev A.** (Saint-Petersburg), **Sychev D.** (Moscow), **Nedogoda S.** (Volgograd), **Karpov Y.** (Moscow), **Galyavich A.** (Kazan), **Yezhov M.** (Moscow), **Gurevich V.** (Saint-Petersburg)

## AMUR HALL

09.00–10.30

### SYMPOSIUM

#### OF THE NATIONAL SOCIETY OF ATHEROTHROMBOSIS

#### Hot issues of antithrombotic therapy in cardiology

#### (in memory of Y.B. Belousov)

**Chairpersons: Yavelov I.** (Moscow), **Panchenko E.** (Moscow)

- **Yavelov I.** (Moscow). Oral anticoagulant therapy in patients with stable atherothrombosis.
- **Komarov A.** (Moscow). Modern approaches to dual antiplatelet therapy reduction after ACS.
- **Panchenko E.** (Moscow). Antithrombotic therapy in patients with atrial fibrillation undergoing PCI.



## YENISEI HALL

09.00–10.30

### SYMPOSIUM

#### Genetics of multifactorial diseases

Chairpersons: **Minushkina L.** (Moscow), **Nikulina S.** (Krasnoyarsk)

- **Minushkina L.<sup>1</sup>, Brazhnik V.<sup>1</sup>, Selezneva N.<sup>1</sup>, Averkova A.<sup>1</sup>, Zubova E.<sup>1</sup>, Rogozhina A.<sup>1</sup>, Karmanchikova E.<sup>2</sup>, Speshilov G.<sup>1</sup>, Zateyshchikov D.<sup>1</sup>** (Moscow<sup>1</sup>, Stavropol<sup>2</sup>). Polymorphism of tumor necrosis factor gene and features of myocardial structure and function in patients with arterial hypertension.
- **Nikulin D., Yakovleva D., Shulman V., Platunova I., Nikulina S., Chernova A.** (Krasnoyarsk). Genetic predictors of stroke.
- **Repin A., Muslimova E., Rebrova T., Shaleva O., Afanasiev S.** (Tomsk). Molecular and genetic predictors of unfavorable course of coronary artery disease.
- **Zotova I., Fattakhova E., Nikitin A., Brovkin A., Zateyshchikov D.** (Moscow). AA genotype of the G-308a polymorphic marker RS1800629 of tumor necrosis factor gene associated with the development of ischemic stroke in patients with atrium fibrillation.

## VOLGA HALL

09.00–10.30

### SYMPOSIUM

#### Sudden arrhythmic death in sports

Chairpersons: **Smolensky A.** (Moscow), **Bondarev S.** (Saint-Petersburg), **Mikhailova A.** (Moscow)

- **Smolensky A.** (Moscow). Sudden arrhythmic death in sports — morphological substrate or primary electrical heart disease?
- **Bondarev S.** (Saint-Petersburg). Arrhythmias and heart diseases of athletes: what do we know about this today?
- **Bagmanova Z.** (Ufa). Modern diagnostic methods in patients with ventricular rhythm disturbances and high tolerance to physical activity.
- **Leonova N.** (Moscow). Approaches to differential diagnosis of extrasystolic causes in young athletes.
- **Mikhailova A.** (Moscow). Clinical and functional significance of extrasystolic rhythm disturbances in athletes.

- **Smirnov V., Bondarev S.** (Saint-Petersburg). The risk of sudden death in athletes with metabolic syndrome.

## DVINA HALL

09.00–10.30

### SYMPOSIUM

#### 50-year history of the national cardiorehabilitation prospects for further development

Chairpersons: **Aronov D.** (Moscow), **Ivanova G.** (Moscow), **Bubnova M.** (Moscow)

- **Aronov D.** (Moscow). The main milestones of the Soviet and Russian cardiorehabilitation formation.
- **Ivanova G.** (Moscow). The current state of medical rehabilitation in Russia. Neurocardiologic direction — prospects of development.
- **Bubnova M.** (Moscow). Cardiosomatic rehabilitation — a new direction in medicine.
- **Filonenko E.** (Moscow). Rehabilitation in oncology.
- **Lyamina N.** (Saratov). Technologies of electronic and mobile health care — the future of cardiological and somatic rehabilitation.

## ANGARA HALL

09.00–10.30

### SYMPOSIUM

#### Challenges, controversies and unexpected events in management of cardiac arrhythmias: review of clinical cases

Chairpersons: **Golitsyn S.** (Moscow), **Pevzner A.** (Moscow)

- **Mironov N., Maykov E., Shlevkov N., Golitsyn S.** (Moscow). Atrial fibrillation in patient with Brugada syndrome.
- **Kostyukevich M., Shlevkov N., Kiktev V., Mironova N., Stukalova O., Egiazaryan L., Golitsyn S.** (Moscow). Incessant ventricular tachycardia as first manifestation of cardiac sarcoidosis.
- **Novikov P., Mironov N., Shlevkov N., Maykov E., Pevzner A., Golitsyn S.** (Moscow). Atrioventricular nodal reciprocating tachycardia in patient with WPW syndrome.



- **Utsumueva M., Mironov N., Shlevkov N., Kiktev V., Gupalo E., Kashtanova S., Golitsyn S.** (Moscow). Supraventricular tachycardia in patient with dilative cardiomyopathy and conduction abnormalities.
- **Gupalo E., Utsumueva M., Mironova N., Golitsyn S.** (Moscow). Cardiac contractility modulation in patient with hypocalcemic cardiomyopathy.
- **Mareev Y., Sopov O., Fedotenkov I., Revishvili A.** (Moscow). Multi-detector-row computed tomography guided left ventricle lead implantation for cardiac resynchronization therapy in patient with posterior infarction.

## LADOGA HALL

09.00–10.30

### SYMPOSIUM

#### Hot issues of psychocardiology

**Chairpersons:** **Syrkin A.** (Moscow), **Smulevich A.** (Moscow)

- **Kopylov P.** (Moscow). Mental disorders and adherence to treatment.
- **Volel B.** (Moscow). Therapy of mental disorders in cardiology.
- **Pogosova N.** (Moscow). Anxiety and depressive conditions in general medical practice: new approaches from the point of view of a cardiologist.
- **Troshina D.** (Moscow). Psychosomatic disorders in atrial fibrillation.
- **Vasyuk Y.** (Moscow). The role of obesity in the formation of anxiety-depressive disorders in arterial hypertension.

## PLENARY HALL

11.00–12.30

### PLENARY SESSION

#### Acute cardiac care — 2018

*On-line broadcasting / Simultaneous translation*

**Chairperson:** **Ruda M.** (Moscow)

- **Averkov O.** (Moscow). Myocardial infarction — 2018.
- **Tereshchenko S.** (Moscow). Acute heart failure — 2018.
- **Golitsyn S.** (Moscow). Cardiac arrhythmias — 2018.
- **Yavelov I.** (Moscow). Pulmonary embolism — 2018.

## CONGRESS HALL №2

11.00–12.30

### SYMPOSIUM

#### Artery denervation: is there future for pulmonary artery management?

**Chairpersons:**

**Moiseeva O.** (Saint-Petersburg), **Chernyavskiy A.** (Novosibirsk)

- **Goncharova N., Mitrofanova L., Mikhailov E.** (Saint-Petersburg). Pulmonary artery innervation and rationale for denervation for the management of pulmonary artery hypertension.
- **Rudenko B.** (Moscow). Basics and methods of pulmonary artery denervation. Our experience.
- **Romanov A.** (Novosibirsk). Pulmonary artery radiofrequency denervation for pulmonary artery hypertension: our experience.
- **Mikhailov E.** (Saint-Petersburg). Renal artery denervation: is there a role for pulmonary hypertension?

## AMPHITHEATER HALL

11.00–12.30

### CLINICAL CASE DISCUSSION

#### Rare forms of cardiomyopathies

**Chairpersons:** **Kotlukova N.** (Moscow), **Zaklyazminskaya E.** (Moscow)

- **Kotlukova N.** (Moscow). Cardiomyopathy in hereditary mitochondrial diseases.
- **Kirsanova T.** (Moscow). Peripartal cardiomyopathy: approaches to differential diagnosis.
- **Lutochina Y., Blagova O., Nedostup A.** (Moscow). Right ventricular arrhythmogenic dysplasia cardiomyopathy: classification and predictors of adverse outcomes in various clinical forms.
- **Blagova O.** (Moscow). Primary and secondary restrictive cardiomyopathies in clinical practice.
- **Balkarova O., Rogozhina Yu., Zaklyazminskaya E.** (Moscow). DCMP and non-compact myocardium of the left ventricle in the Alport syndrome.

## PRESS HALL

11.00–12.30

### SYMPOSIUM

#### Questions and lessons of evidence-based cardiology

Chairpersons: **Kobalava Zh.** (Moscow), **Yahontov D.** (Novosibirsk)

- **Gilyarevskiy S.** (Moscow). Choice of tactics of management for patients with heart disease in conditions of limited evidence.
- **Villevalde S.** (Moscow). Non-inferiority versus superiority: the not so subtle distinction.
- **Kobalava Zh.** (Moscow). Cardionephroprotective effects of new hypoglycemic drugs: from evidence to real practice.
- **Yahontov D.** (Novosibirsk). Experience in teaching the basics of evidence-based medicine to students of medical schools and postgraduate students.

## URAL HALL

11.00–12.30

### SCIENTIFIC SESSION

#### Imaging in cardiology, ultrasound and tomographic technologies

Chairpersons:

**Sinitsyn V.** (Moscow), **Pavlyukova E.H.** (Tomsk), **Bokeria O.** (Moscow)

- **Bokeria O., Koasari A.** (Moscow). Modern imaging methods in diagnostics of complex congenital malformations.
- **Boschenko A., Vrublevskiy A., Zavadovsky K., Krylov A.** (Tomsk). Coronary reserve of anterior descending artery as a marker of hemodynamically important vascular stenosis in patients with moderate pre-test probability of CAD.
- **Mustafina I., Pavlov V., Ishmetov V.** (Ufa). Morphological characteristics of plaque rupture and erosion in ACS with optical coherence tomography.
- **Usov V., Vyshlov E., Mochula O., Alekseeva Y., Yaroshevskiy S., Bakhmetieva T., Ryabov V., Lukyanenok P., Markov V.** (Tomsk). Myocardial MRI with contrast in assessment of temporary kinetics of inconvertible damage in STEMI.

- **Pavlyukova E.<sup>1</sup>, Karetina T.<sup>2</sup>, Gankin M.<sup>2</sup>, Evtushenko A.<sup>1</sup>, Sakovich V.<sup>2</sup>, Drobot D.<sup>2</sup>, Karpov R.** (Tomsk<sup>1</sup>, Krasnoyarsk<sup>2</sup>). Contractility of papillary muscles in ischaemic mitral regurgitation.
- **Bokeria L., Bokeria O., Mironenko M., Klimchuk I., Shvarts V.** (Moscow). 4D echocardiography of mitral valve: assessment of dynamics and geometry of valve in patients with atrial fibrillation.
- **Komissarova C., Zakharova E., Ilyina T., Vankovich E.** (Belarus). Additional value of measurement of myocardial fibrosis with MRI with contrast in identification of patients with HCM and acute cardiac death risk.

## BAIKAL HALL

11.00–12.30

### EXPERT COUNCIL

**Shestakova M.** (Moscow), **Shlyakhto E.** (Saint-Petersburg), **Boytsov S.** (Moscow), **Karpova I.** (Moscow), **Khalimov Y.** (Saint-Petersburg), **Mkrumyan A.** (Moscow), **Kalashnikov V.** (Moscow), **Yakovlev A.** (Saint-Petersburg), **Sychev D.** (Moscow), **Nedogoda S.** (Volgograd), **Karpov Y.** (Moscow), **Galyavich A.** (Kazan), **Yezhov M.** (Moscow), **Gurevich V.** (Saint-Petersburg)

## AMUR HALL

11.00–12.30

### SYMPOSIUM

#### 3D session: in details, dynamically, evidential. Difficult and unresolved questions of therapy by statins of the polymorbid CAD patient

Chairperson: **Arutyunov G.** (Moscow), **Petrova M.** (Krasnoyarsk)

- **Arutyunov G.** (Moscow). How achievable is the new Russian target level of low density lipoprotein cholesterol?
- **Kozioleva N.** (Perm). Statins and risk of development of diabetes: are fears real?
- **Tarlovskaya E.** (Nizhny Novgorod). What is “transaminite”?
- **Rebrov A., Nikitina N.** (Saratov). Coronary artery disease and rheumatoid arthritis: statins as anti-inflammatory medicines.

- **Arutyunov A.** (Moscow). Whether it is possible to consider statins as nephroprotector?
- **Petrova M.** (Krasnoyarsk). Statins and cognitive disorders: is there a connection?
- **Grigorieva N.** (Nizhny Novgorod). Do statins affect the course of COPD?
- **Chesnikova A.** (Rostov-on-Don). Is hypotheriosis a contraindication or indication for lipid-lowering therapy?
- **Orlova Y.** (Moscow). Lipid-lowering therapy after 75 years: yes or no?

## YENISEI HALL

11.00–12.30

### SCIENTIFIC SESSION

#### Heart is the target organ in internal organs diseases

Chairpersons: **Lareva N.** (Chita), **Govorin A.** (Chita)

- **Lareva N.** (Chita). Cardiovascular disorders in postmenopausal women: pathogenesis, clinical course, methods of correction.
- **Gorbunov V.** (Chita). Cardiovascular complications in respiratory diseases: epidemiology, outcomes, prediction.
- **Kushnarenko N., Govorin A.** (Chita). Gout: contemporary aspects of pathogenesis, diagnostics and cardiovascular disorders.
- **Zaytsev D.** (Chita). New old risk factors of cardiovascular diseases in men: chronic prostatitis is in focus.
- **Chistyakova M., Govorin A.** (Chita). Cirrhotic cardiomyopathy: modern diagnostic capabilities, therapy approaches.

## VOLGA HALL

11.00–12.30

### WORKSHOP

#### Hot issues of diagnosis and treatment of family hyperlipidemia

Chairpersons: **Zateyshchikov D.** (Moscow), **Konstantinov V.** (Saint-Petersburg), **Kuznetsova T.** (Petrozavodsk)

- **Zateyshchikov D.** (Moscow). Practical issues of detection familial hypercholesterolemia.

- **Gustiniani D.** (Spain), **Sonicheva N.** (Moscow). Practical aspects of the genetic study in dyslipidemia.
- **Konstantinov V.** (Saint-Petersburg). The natural course of familial hyperlipidemia.
- **Korneva V.** (Petrozavodsk). Modern principles of treatment of family hypercholesterolemia.

## DVINA HALL

11.00–12.30

### SYMPOSIUM

#### Modern possibilities in diagnostics of the athlete's heart

Chairpersons: **Mitrofanova L.** (Saint-Petersburg), **Bondarev S.** (Saint-Petersburg), **Smolensky A.** (Moscow)

- **Mitrofanova L.** (Saint-Petersburg). Pathomorphological picture of the athlete's heart with high risk of sudden death.
- **Sukhov V., Bondarev S.** (Saint-Petersburg). A place of nuclear methods in the diagnostics of a sports heart.
- **Bondarev S.** (Saint-Petersburg). Modern problems and advantages of ECG telemonitoring.
- **Zaripova Z., Ladozhskaya-Gapeenko E.** (Saint-Petersburg). The role of spirometry in the analysis of the condition of the athlete's heart.

## ANGARA HALL

11.00–12.30

### SYMPOSIUM

#### Rare and difficult diagnoses in cardiology

Chairpersons: **Andreev D.** (Moscow), **Syrkin A.** (Moscow)

- **Novikova N.** (Moscow). Iatrogenic torsade de pointes.
- **Poltavskaya M., Kozlovskaya N.** (Moscow). Thrombotic microangiopathy as the cause of heart failure.
- **Schekochihin D.** (Moscow). Rare cause of heart failure.
- **Gilarov M.** (Moscow). MINOCA: what does this term imply.
- **Andreev D.** (Moscow). Patient with rapidly developed ascites.

## LADOGA HALL

11.00–12.30

### SYMPOSIUM

#### Multifaceted interactions of diabetes and cardiovascular diseases

**Chairpersons:** **Mamedov M.** (Moscow), **Bubnova M.** (Moscow)

- **Mamedov M.** (Moscow). Diabetes mellitus, prediabetes and CVD: current trends and patterns.
- **Bubnova M.** (Moscow). Prevention of macrovascular complications in diabetes mellitus and prediabetes: the role of lipid-lowering intervention.
- **Arabidze G.** (Moscow). Possibilities of effective therapy of patients with refractory to ongoing treatment with arterial hypertension, progressive atherosclerosis and type 2 diabetes mellitus from the perspective of evidence-based medicine.
- **Koshelskaya O.** (Tomsk). Modern approaches to the assessment and correction of cardiovascular risk in patients with type 2 diabetes mellitus.
- **Bondarenko I.** (Moscow). Algorithm for diagnosis and treatment of cardiovascular diseases with type 1 and 2 diabetes: what needs to be considered by a cardiologist?

## PLENARY HALL

13.00–15.00

### PLENARY SESSION

#### Challenges and solutions in cardiology. Session 2

*On-line broadcasting / Simultaneous translation*

**Chairpersons:**

**Shlyakhto E.** (Saint-Petersburg), **Achenbach S.** (Germany)

- **Achenbach S.** (Germany). CT for the detection and characterization of coronary plaque — lessons learned for prevention
- **Kobalava Z.** (Moscow). Latest European guidelines on arterial hypertension.
- **Galyavich A.** (Kazan). Latest European guidelines on myocardial revascularization.

GENERAL PARTNERS



PRINCIPAL PARTNERS



PARTNERS



## GENERAL INFORMATION PARTNERS



## INFORMATION PARTNERS





## Выбирая Ксарелто® сегодня, вы можете защитить ваших пациентов с фибрилляцией предсердий завтра<sup>1, #</sup>



**Подтвержденный профиль эффективности в профилактике инсульта и снижении риска жизнеугрожающих кровотечений даже у пожилых и коморбидных пациентов\*\*†,‡,‡,1**

**Только Ксарелто® подтвердил значимое снижение риска ИМ/ОКС среди ПОАК по данным крупного мета-анализа РКИ<sup>2,†</sup>**

**Выбор дозы Ксарелто® основан на одном надежном показателе – клиренсе креатинина, что позволяет снизить вероятность ошибки при назначении препарата<sup>5, 3, 4</sup>**

**Однократный режим дозирования способствует высокой приверженности к терапии Ксарелто®<sup>1, 5, 6</sup>**

\* В сравнении с варфарином; \*\* Высокий риск инсульта (по шкале CHADS<sub>2</sub> ≥ 3 балла) и кровотечений (по шкале HAS-BLED ≥ 3 балла); † «Препарат Ксарелто» изучен и зарегистрирован по показанию «Профилактика инсульта и системной тромбоэмболии у пациентов с фибрилляцией предсердий неклапанного происхождения»; ‡ При КЛкр 30–49 мл/мин доза Ксарелто® 15 мг 1 р/д, при КЛкр ≥ 50 мл/мин доза Ксарелто® 20 мг 1 р/д; ‡ Имеются ограничения, указанные в первоисточнике. Полные результаты исследований приведены в первоисточниках; ИМ – инфаркт миокарда; ОКС – острый коронарный синдром; ПОАК – прямые пероральные антикоагулянты; РКИ – рандомизированные клинические исследования; КЛкр – клиренс креатинина.

**КСАРЕЛТО®.** Международное непатентованное название: ривароксабан. **Лекарственная форма:** таблетки покрытые пленочной оболочкой. 1 таблетка покрытая пленочной оболочкой содержит 15 или 20 мг ривароксабана микронизированного. **ПОКАЗАНИЯ К ПРИМЕНЕНИЮ:** — профилактика инсульта и системной тромбоэмболии у пациентов с фибрилляцией предсердий неклапанного происхождения; — лечение тромбоза глубоких вен и тромбоэмболии легочной артерии и профилактика рецидивированной ТГВ и ТЭЛА. **ПРОТИВОПОКАЗАНИЯ:** повышенная чувствительность к ривароксабану или любым вспомогательным веществам, содержащимся в таблетке; клинически значимые активные кровотечения (например, желудочно-кишечные кровотечения), кровотечения, связанные с приемом препаратов, содержащих аспирин, препараты НПВС, производные гепарина (фондапаринукс и др.), пероральные антикоагулянты (варфарин, аликсабан и др., дабигатран и др.), кроме случаев перехода с или на ривароксабан или при применении нефракционированного гепарина в дозах, необходимых для обеспечения функционирования центрального венозного или артериального катетера; заболевания печени, протекающие с коагулопатией, которая обуславливает клинически значимый риск кровотечений; беременность и период грудного вскармливания; детский и подростковый возраст до 18 лет (эффективность и безопасность у пациентов данной возрастной группы не установлены); почечная недостаточность (клиренс креатинина <15 мл/мин) (клинические данные о применении ривароксабана у данной категории пациентов отсутствуют); врожденный дефицит лактазы, непереносимость лактозы, глюкозо-галактозная мальабсорбция (в связи с наличием в составе лактозы). **С ОСТОРОЖНОСТЬЮ:** При лечении пациентов с повышенным риском кровотечения (в том числе при врожденной или приобретенной склонности к кровотечениям, неконтролируемой тяжелой артериальной гипертензии, тяжелой болезни желудка и 12-перстной кишки в стадии обострения, недавняя перенесенная язвенная болезнь желудка и 12-перстной кишки, сосудистой ретинопатии, бронхоэктазах или легочном кровотечении (в анамнезе); при лечении пациентов с почечной недостаточностью (клиренс креатинина <30 мл/мин), получающих одновременно препараты, повышающие концентрацию ривароксабана в плазме крови; при лечении пациентов с почечной недостаточностью (клиренс креатинина 29–15 мл/мин) следует соблюдать осторожность, поскольку концентрация ривароксабана в плазме крови у таких пациентов может значительно повышаться (в среднем в 1,6 раза), и вследствие этого могут повыситься показатели риска кровотечения у пациентов, получающих лекарственные препараты, влияющие на гемостаз (например, НПВС), антиагреганты или другие антигемостатические средства); Ксарелто® не рекомендуется к применению у пациентов, получающих системное противогрибковыми препаратами азоловой группы (например, кетоконазолом) или ингибиторами протазы ВИЧ (например, ритонавиром). Как следствие, эти лекарственные препараты могут повышать концентрацию ривароксабана в плазме крови до клинически значимого уровня (в среднем в 2,0 раза), что увеличивает риск развития кровотечений. Азоловый противогрибковый препарат флюконазол, умеренный ингибитор СУР3А4, оказывает менее выраженное влияние на экспозицию ривароксабана и может применяться с ним одновременно. Пациенты с почечной недостаточностью (клиренс креатинина 29–15 мл/мин) или повышенным риском кровотечения и пациенты, получающие сопутствующее системное лечение противогрибковыми препаратами азоловой группы или ингибиторами протазы ВИЧ, после начала лечения должны находиться под пристальным контролем для своевременного обнаружения осложнений в форме кровотечений. **ПОВОНОЧНОЕ ДЕЙСТВИЕ:** Читывая механизм действия, применение Ксарелто® может сопровождаться повышенным риском скрытого или явного кровотечения из любых органов и тканей, которое может приводить к постгеморрагической анемии. Риск развития кровотечений может увеличиваться у пациентов с неконтролируемой артериальной гипертензией и/или при совместном применении с препаратами, влияющими на гемостаз. Признаки и симптомы тяжелой тяжести (включая возможный летальный исход) варьируют в зависимости от локализации, интенсивности и продолжительности кровотечения и/или анемии. Геморрагические осложнения могут проявляться слабостью, бледностью, головокружением, головной болью, одышкой, а также увеличением конечности в объеме или шоком, которые невозможно объяснить другими причинами. В некоторых случаях вследствие анемии развивались симптомы ишемии миокарда, такие как боль в груди и стенокардия. Часто отмечались анемия (включая соответствие лабораторным параметрам), кровопотеря в глаз (включая кровопотеря в конъюнктиву), кровотечение десен, желудочно-кишечное кровотечение (включая ректальное кровотечение), боли в области желудочно-кишечного тракта, диспепсия, тошнота, запор, диарея, рвота, диаррхоя\*, периферические отеки, снижение общей мышечной силы и тонуса (включая слабость, астению), кровопотеря после проведенных процедур (включая послеоперационную анемию и кровотечение из раны), язвенная гематома при шунте; повышение активности печеночных трансаминаз, боли в конечностях\*, головокружение, головная боль, кровотечение из уретриального тракта (включая гематурию и меноррагию\*\*); почечная недостаточность (включая повышение уровня креатинина, повышение уровня мочевины\*); носовое кровотечение, кроваво-красная моча (включая носовые кровотечения генерализованного типа), сыпь, жимом, кожные и подкожные кровотечения; выраженное снижение артериального давления, гематома. \* регистрировалась после больших ортопедических операций; \*\* регистрировалась при лечении ВЗ как очень частые у женщин < 55 лет; Регистрационный номер: ЛП-001457. Актуальная версия инструкции от 12.02.2018. Юридическое лицо, на имя которого выдано регистрационное удостоверение и производитель: Байер АГ, Германия. Отпускается по рецепту врача. Подробная информация содержится в инструкции по применению.



## ВАШ ВЫБОР — ЕГО БУДУЩЕЕ!

- ✓ ПРАДАКСА® — широко изученный профиль безопасности<sup>1–10</sup>
- ✓ ПРАДАКСА® 150 мг x2 — единственный НОАК, превзошедший варфарин в снижении риска ишемического инсульта у пациентов с фибрилляцией предсердий<sup>9–13\*</sup>

\* — неклапанная фибрилляция предсердий. НОАК — новые оральные антикоагулянты.

**Краткая инструкция по медицинскому применению лекарственного препарата Прадакса® (PRADAXA).<sup>14</sup> Регистрационный номер:** ЛСР-007065/09 (для дозировок 75 мг и 110 мг); ЛП-000872 (для дозировки 150 мг). **МНН:** дабигатран этексилат. **Лекарственная форма:** капсулы. **Состав:** одна капсула содержит действующее вещество: 86,48 мг, 126,93 мг или 172,95 мг дабигатрана этексилата мезилата, что соответствует 75 мг, 110 мг или 150 мг дабигатрана этексилата. **Показания:** профилактика венозных тромбоэмболий у пациентов после ортопедических операций; профилактика инсульта, системных тромбоэмболий и снижение сердечно-сосудистой смертности у пациентов с фибрилляцией предсердий; лечение острого тромбоза глубоких вен (ТГВ) и/или тромбоэмболии легочной артерии (ТЭЛА) и профилактика смертельных исходов, вызываемых этим заболеваниям; профилактика рецидивированного тромбоза глубоких вен (ТГВ) и/или тромбоэмболии легочной артерии (ТЭЛА) и смертельных исходов, вызываемых этим заболеваниями; профилактика рецидивированного тромбоза глубоких вен (ТГВ) и/или тромбоэмболии легочной артерии (ТЭЛА) и смертельных исходов, вызываемых этим заболеваниями; профилактика рецидивированного тромбоза глубоких вен (ТГВ) и/или тромбоэмболии легочной артерии (ТЭЛА) и смертельных исходов, вызываемых этим заболеваниями; профилактика рецидивированного тромбоза глубоких вен (ТГВ) и/или тромбоэмболии легочной артерии (ТЭЛА) и смертельных исходов, вызываемых этим заболеваниями; профилактика рецидивированного тромбоза глубоких вен (ТГВ) и/или тромбоэмболии легочной артерии (ТЭЛА) и смертельных исходов, вызываемых этим заболеваниями. **Особые указания:** Не применять препарат ПРАДАКСА, также как и других антикоагулянтов, рискующих повышенной риском кровотечения. Во время терапии препаратом ПРАДАКСА возможно развитие кровотечений различной локализации. Снижение концентрации гемоглобина и/или гематокрита в крови, сопровождающееся снижением АД, является основанием для поиска источника кровотечения. Лечение препаратом ПРАДАКСА не требует контроля антикоагулянтной активности. Тест для определения МНО применяться не должен, поскольку все данные о ложном завышении уровня МНО, для выявления чрезмерной антикоагулянтной активности дабигатрана следует использовать тесты для определения тромбинового или жаренового времени свертывания. В случае, когда эти тесты не доступны, следует использовать тест для определения АЧТВ. В исследовании RE-LY у пациентов с фибрилляцией предсердий превышение уровня АЧТВ в 2-3 раза выше граничной нормы не влияло на частоту смертельных исходов. Исследования у пациентов с почечной недостаточностью. Исследования в отношении безопасности и эффективности применения ПРАДАКСА у пациентов с почечной недостаточностью. Условно хранения: Хранить в оригинальной упаковке для защиты от влаги, при температуре не выше 25 °С. Не помещать таблетки в таблетки и организаторы для лекарств, с истечением тех, в которых они могут оставаться в оригинальной упаковке (блестеры). Хранить в недоступном для детей месте. **Срок годности:** 3 года. Не использовать после истечения срока годности. **Полная информация представлена в инструкции по медицинскому применению.**

ООО «Бернгер Ингельхайм», 125171 Москва, Ленинградское шоссе, 16А, стр. 3. Телефон (495) 5445404. Факс (495) 5445620. [www.boehringer-ingenheim.ru](http://www.boehringer-ingenheim.ru). Сообщите информацию о нежелательных явлениях можно по следующему адресу: ООО «Бернгер Ингельхайм», Почтовый адрес: 125171, Москва, Ленинградское шоссе, 16А, стр. 3, Тел.: +7 495 544 50 44. Электронная почта: [PU.Russia@boehringer-ingenheim.com](mailto:PU.Russia@boehringer-ingenheim.com) Литература: 1. Graham D et al. Circulation 2015; 131: 157-164. 2. Vilness T et al. Thrombosis Haemostasias; 2015; 114: 1290-1298. 3. Seeger J et al. Thrombosis Haemostasias; 2015; 114: 1277-1289. 4. Larsen T et al. JACC 2013;61:2264-2273; 5. Larsen T et al. The American Journal of medicine; 2014; 127: 329-336; 6. Lauffenburger JO et al. J Am Heart Assoc 2015; 7: G045-Rasmussen et al. Pharmacodiagnosis Drug SA 2016; doi:10.1002/pds.4034; 8. Graham DJ, et al. JAMA Intern Med. 2016; 176(11):1662-1671. doi:10.1001/jamainternmed.2016.5854. 9. Connolly SJ et al. N Engl J Med 2009; 361: 1199-1211. 10. Connolly SJ et al. N Engl J Med 2011; 365: 875-883. 11. Gargner CB et al. N Engl J Med 2011; 365: 883-92. 12. Patel M et al. N Engl J Med 2011; 365: 883-92. 13. Pradaxa. European SmPC, доступно по ссылке: [http://www.ema.europa.eu/docs/en\\_GB/document\\_library/EPAR\\_-\\_Product\\_Information/human/000829/WC500041059.pdf](http://www.ema.europa.eu/docs/en_GB/document_library/EPAR_-_Product_Information/human/000829/WC500041059.pdf) 09 августа 2017. 14. Инструкция по медицинскому применению лекарственного препарата Прадакса® ПУ. 75мг/110 мг - ЛСР-007065/09, 150 мг - ЛП-000872.





Доверие препаратам KRKA – это доверие передовым технологиям и высокому Европейскому качеству (1)



## КО-ДАЛЬНЕВА®

амлодипин, индапамид, периндоприл  
таблетки

5 мг/0,625 мг/2 мг 5 мг/1,25 мг/4 мг  
5 мг/2,5 мг/8 мг 10 мг/2,5 мг/8 мг

### Синергия тройной силы!

#### Ко-Дальнева®:

**Показания к применению:** артериальная гипертензия (при необходимости одновременной терапии амлодипином, индапамидом и периндоприлом в дозах, применяемых в монотерапии отдельных компонентов). **Способ применения и дозы:** внутрь, по одной таблетке 1 раз в день, предпочтительно утром перед приемом пищи. Доза препарата Ко-Дальнева® подбирается после ранее проведенного титрования доз отдельных активных компонентов препарата. Максимальная суточная доза препарата Ко-Дальнева® составляет 10 мг амлодипина + 2,5 мг индапамида + 8 мг периндоприла. **Условия отпуска из аптек:** по рецепту. **Форма выпуска:** таблетки 5 мг + 0,625 мг + 2 мг по 30 таблеток, 5 мг + 1,25 мг + 4 мг, 5 мг + 2,5 мг + 8 мг, 10 мг + 2,5 мг + 8 мг по 30 и 90 таблеток.



Источник информации: 1. Собственные данные компании KRKA, д. д. Ново Место, Словения, 2018 г.

Информация предназначена для медицинских и фармацевтических работников

#### Заказчик размещения рекламы ООО «KRKA ФАРМА»

125212, г. Москва, Головинское шоссе, д. 5, корп. 1  
Тел.: (495) 981-10-95, факс: (495) 981-10-91. e-mail: info@krka.ru, www.krka.ru



# ЭКСПЕРТЫ В ЗАБОТЕ О ПАЦИЕНТАХ<sup>1</sup>

Плавикс®  
Коплавикс®

Телзап®  
ТЕЛМИСАРТАН

РОЗУКАРД®

Телзап® ПЛЮС  
ТЕЛМИСАРТАН + ГИДРОХЛОРОТИАЗИД

SANOFI

АПРОВАСК®

АПРОВЕЛЬ®

ирбесартан + амлодипин

ирбесартан 150 мг, 300 мг

Лозап® АМ  
лозартан + амлодипин

КЛЕКСАН®  
эноксапарин натрия

Лозап® ПЛЮС  
лозартан + гидрохлоротиазид

Пралуэнт®  
алирокумаб

Материал предназначен для специалистов здравоохранения.

Представительство АО «Санофи-авентис груп» (Франция), 125009, Москва, ул. Тверская, д. 22  
Тел.: (495) 721-14-00, факс: (495) 721-14-11. <http://www.sanofi.ru>. SARU.SA.17.11.2086b  
1. Электронный ресурс: <http://www.sanofi.ru/l/ru/ru/index.jsp>, дата доступа: 06.07.2018.



# ПРЕСТИЛОЛ®

Бисопролол / Периндоприл

Новый препарат



БИСОПРОЛОЛ  
+  
ПЕРИНДОПРИЛ

## ЗАЩИТА СЕРДЦА МОЖЕТ БЫТЬ ПРОСТОЙ И ДОСТУПНОЙ\*



ПРЕСТИЛОЛ®  
5 мг/5 мг

ПРЕСТИЛОЛ®  
5 мг/10 мг

ПРЕСТИЛОЛ®  
10 мг/10 мг

Артериальная гипертензия

Стабильная ишемическая болезнь сердца

Стабильная хроническая сердечная недостаточность

1 таблетка в день

\* Одна таблетка вместо двух.  
КРАТКАЯ ИНСТРУКЦИЯ ПО МЕДИЦИНСКОМУ ПРИМЕНЕНИЮ ПРЕПАРАТА ПРЕСТИЛОЛ®  
Описание в упаковке, включая перечень побочных...  
Состав: Бисопролол гидрохлорид, Периндоприл эрбемилат...  
Фармакодинамика: Бисопролол — селективный бета-1-адренергический блокатор...  
Фармакокинетика: Бисопролол и периндоприл эрбемилат...  
Показания к применению: Артериальная гипертензия, ишемическая болезнь сердца, хроническая сердечная недостаточность...  
Способ применения и дозы: Взрослым назначают по 1 таблетке 1 раз в сутки...  
Противопоказания: Тяжелая почечная недостаточность, тяжелая печеночная недостаточность, беременность и лактация...  
Побочные эффекты: Головокружение, головная боль, кашель, першение в горле, отеки...  
Взаимодействие с другими препаратами: С осторожностью применять одновременно с диуретиками, антиаритмическими средствами...  
Передозировка: Специфического антидота нет. Лечение симптоматическое...  
Условия хранения: В сухом, защищенном от света месте при температуре не выше 25°C...  
Срок годности: 3 года...  
Адрес: ООО «Теква Фармасьютикалс», Москва, ул. Усачева, д. 2, стр. 1. Контакт: +7 (495) 933 5511.



НОВОЕ РЕШЕНИЕ  
ДЛЯ КОНТРОЛЯ АД

**РАННЕЕ  
НАЧАЛО ДЕЙСТВИЯ**  
МОЖЕТ ПОКАЗАТЬ  
ЗНАЧИМЫЙ ЭФФЕКТ  
НА 2-й НЕДЕЛЕ ТЕРАПИИ<sup>1-4</sup>

**ПРЕВОСХОДИТ  
ДРУГИЕ САРТАНЫ\***  
В СНИЖЕНИИ АД<sup>1-4</sup>

**СТАБИЛЬНЫЙ  
КОНТРОЛЬ АД**  
В ТЕЧЕНИЕ  
24 ЧАСОВ<sup>1-4</sup>



**УВЕРЕННОЕ ПРЕВОСХОДСТВО\***

- \* Валсартан, олмесартан.
  - \*\* Статистически значимое превосходство в снижении клинического систолического АД vs. валсартан 320 мг и олмесартан 40 мг<sup>1,4</sup>.
- Информация для специалистов здравоохранения.  
1. Инструкция по применению лекарственного препарата для медицинского применения Эдарби®, таблетки 20 мг, 40 мг, 80 мг. Пер. уд. ЛП-002359 от 03.02.2014.  
2. Bakris G, et al. J. Clin. Hypertens. (Greenwich). 2011; 13(2): 81–8.  
3. Sica D, et al. J. Clin. Hypertens (Greenwich). 2011; 13: 467–472.  
4. White W, et al. Hypertension. 2011; 57(3): 413–20.



**СОКРАЩЕННАЯ ИНФОРМАЦИЯ ПО ПРИМЕНЕНИЮ**  
**Торговое название:** Эдарби®. **Международное непатентованное название (МНН):** азилсартана медоксомил. **Лекарственная форма и дозировка:** таблетки 20 мг, 40 мг и 80 мг. **Показания к применению:** эссенциальная гипертензия. **Противопоказания:** повышенная чувствительность к действующему веществу и другим компонентам препарата; беременность; одновременный приём препаратов, содержащих алискирен, у пациентов с сахарным диабетом и/или умеренными и тяжёлыми нарушениями функции почек (скорость клубочковой фильтрации (СКФ) менее 60 мл/мин/1,73 м<sup>2</sup> площади поверхности тела); одновременное применение с ингибиторами АПФ у пациентов с диабетической нефропатией; возраст до 18 лет (аффективные и безопасностные не установлены); тяжёлые нарушения функции печени (более 9 баллов по шкале Чайлд-Пью) [отсутствует опыт применения]. **Способ применения и дозы:** Эдарби® принимают утром один раз в сутки. Рекомендованная начальная доза — 40 мг 1 раз в сутки. При необходимости дополнительного снижения АД дозу препарата можно увеличить до максимальной — 80 мг 1 раз в сутки. В случае неадекватного контроля АД в монотерапии препаратом Эдарби® возможно его одновременное применение с другими гипотензивными средствами. Эдарби® следует принимать ежедневно, без перерыва. В случае пропусков приёма очередной дозы пациенту следует принять следующую дозу в обычное время. Не следует принимать двойную дозу препарата Эдарби®. В случае прекращения лечения пациент должен сообщить об этом врачу. **Побочное действие:** головокружение, диарея, повышение активности креатининфосфокиназы, выраженное снижение АД, тошнота, сыпь, зуд, мышечные спазмы, повышение концентрации креатинина, гиперурикемия, повышенная утомляемость, периферические отеки. **Полный перечень побочных эффектов содержится в инструкции по медицинскому применению. С осторожностью:** тяжёлая хроническая сердечная недостаточность (IV функциональный класс по классификации NYHA), почечная недостаточность тяжёлой степени (клиренс креатинина < 30 мл/мин), двусторонний стеноз почечных артерий и стеноз единственной функциональной почки; ишемическая кардиомиопатия; ишемическая цереброваскулярная болезнь; состояние после трансплантации почки; состояния, сопровождающиеся снижением объёма циркулирующей крови (в том числе рвота, диарея), а также у пациентов, соблюдающих диету с ограничением поваренной соли; при одновременном применении с большими дозами диуретиков; первичный гиперальдостеронизм; гиперкалиемия; стеноз аортального и митрального клапанов; гипертрофическая обструктивная кардиомиопатия; возраст старше 75 лет. **Полная информация по препарату содержится в инструкции по медицинскому применению. № RU/EDA/0618/0018**







# Become an **ESC PROFESSIONAL MEMBER**



- > Online access to the **European Heart Journal** or **Cardiovascular Research**
- > Unlimited access to **ESC CardioMed** - based on the *ESC Textbook of Cardiovascular Medicine 3rd Edition*
- > Save €125 on **ESC Congress** registration fee
- > Free access to **ESC webinars**
- > Latest **ESC Pocket Guidelines**
- > And much more...

## Take the next step

Combine ESC Professional Membership and one or more subspecialty association Silver membership to best meet your needs.

[www.escardio.org/membership](http://www.escardio.org/membership)



# VII GLOBAL EDUCATIONAL FORUM

«RUSSIAN CARDIOVASCULAR DAYS»

SAINT-PETERSBURG, 2 AKKURATOVA ST.  
ALMAZOV NATIONAL MEDICAL RESEARCH CENTRE

**APRIL 18-20, 2019**

[www.scardio.ru](http://www.scardio.ru)





# RUSSIAN NATIONAL CONGRESS OF CARDIOLOGY 2019

SEPTEMBER 24–27, 2019 | EKATERINBURG

[www.scardio.ru](http://www.scardio.ru)

